

74-95852

OFFICE COPY

NOT

TO BE REMOVED FROM OFFICE!

[Front cover]

NASLUND

:: THIS COPY IS TO BE KEPT CURRENT
WITH THE RECORDS MASTER COPY,

DO NOT REMOVE OR ADD PAGES WITHOUT
MAKING THE APPROPRIATE ADJUSTMENT
TO THE MASTER COPY IN RECORDS.

PLACE 'SIGN-OUT' CARD
FROM 'LOAN' COPY HERE

[Inside front cover]

KING COUNTY DEPARTMENT OF PUBLIC SAFETY
FOLLOW-UP REPORT

--	--

7	4
---	---

9	5	8	5	2
---	---	---	---	---

PRESENT DATE
8-5-74

TYPE OF CASE MISSING PERSON	DATE OF OCCURRENCE 7-14-74	Original Invest. Officer
ORIGINALLY REPORTED AS Same	LOCATION OF OCCURRENCE Lake Sammamish State Park	VALUE RECOVERED N/A
VICTIM NASLUND, Denise Marie	ADDRESS	PHONE

CASE	STATUS:	OPEN <input checked="" type="checkbox"/>	INACTIVE <input type="checkbox"/>	CLOSED <input type="checkbox"/>
	DISPOSITION:	CLEARED BY ARREST <input type="checkbox"/>	EXCEPTIONAL CLEARANCE <input type="checkbox"/>	UNFOUNDED <input type="checkbox"/>
PROPERTY:		RECOVERED <input type="checkbox"/>	ADDITIONAL STOLEN <input type="checkbox"/>	FURTHER DESCRIPTION <input type="checkbox"/>
		{ INDICATE ID MARKS—COLORS—SIZES— SERIAL NUMBERS—DISPOSITION—VALUE ETC.		

ENTRY

- SUSPECTS: INCLUDE NAMES, B/A NUMBERS, DESCRIPTIONS, DISPOSITION, CAN VICTIM IDENTIFY, ETC.
- PERSONS INTERVIEWED: NAMES, ADDRESSES AND TELEPHONE NUMBERS.
- PROPERTY: INDICATE ID MARKS—COLORS—SIZES—SERIAL NUMBERS—DISPOSITION—VALUE, ETC.
- ADDITIONAL ENTRIES: SUMMARIZE STEPS OF INVESTIGATION — COMMENCE EACH ENTRY WITH A NO., DATE AND TIME.

- 7-16-74 1000 hrs.: Notified by SGT. RANDALL of the missing girls from Lake Sammamish State Park. Had telephone contact with DENISE NASLUND's mother, MRS. ROSE. She related that DENISE worked at Dean's Top Secretarial Pool, 623-8677. She would be sent out on secretarial jobs out of Dean's Top Secretarial Pool. She also was attending I.T.T. Peterson's School, which was a computer programmer's school. She related that KEN LITTLE was a boyfriend of DENISE's and at the time of the disappearance, was bickering with DENISE over a dog. They were at Lake Sammamish State Park with NANCY and BOB SARGENT, and another couple was with them. Her best friend is ROBIN WOODS, CH 8-1652. She also related that the car they took to Lake Sammamish State Park was owned by herself. MRS. ROSE. MRS. ROSE related that the purse belonging to DENISE, and the shoes were still in the car. **DET. HERGESHEIMER TO CONTACT MR. SARGENT FOR A WRITTEN STATEMENT.**
- 1008 hrs.: Attempted phone contact with ROBIN WOODS - line busy.
- 1011 hrs.: Phone contact with Dean's Top Secretarial Pool. Talked with DOUGLAS DEAN, Rm. #633, Securities Building, Seattle, Wa. 98101, 3rd and Stewart. Time slip mailed in for last week received Tuesday, 7/16-74 in the morning mail at Dean's Top Secretarial Pool, stamped 7/15/74. Sixty employees had mailed time slips in at that time. DENISE NASLUND filled out an application blank for work in November of 1973. At that time she gave an address of 10624 21st SW, CH 6-9767. She later changed her address to 4522 SW Graham St., WE 8-0150. She gave a reference of BEV RICHARDS, 8646 13th SW. Also a NADINE GETTEYS, 20112 15th SW, TR 8-3897. She works at the Jet Inn, 246-9110. DENISE worked for Graybar Electric in October of 1973. She was to report to work Monday, 7-15-74, but never showed.
- 1050 hrs.: Talked to PAUL GETTEYS who has not seen DENISE for a year. Mother found out DENISE was missing from DENISE's mother.
- 1055 hrs.: No answer at ROBIN WOODS' phone number.

1h

INVESTIGATING OFFICER Det. Robert Keppel	SERIAL	UNIT H & R	APPROVED BY:
---	--------	---------------	--------------

PAGE

1

OF

13

ADDITIONAL INFORMATION SHEET/OFFICER'S REPORT

Case No.

7 4

9 5 8 5 2

TO	VIA	DATE 8-5-74	TIME
FROM		SUBJECT: CONTINUATION OF <input checked="" type="checkbox"/> OFFICER'S REPORT REGARDING <input type="checkbox"/> FOLLOW-UP REPORT	

ITEM:

- 6 7-16-74 1555 hrs.: No answer at ROBIN WOODS' phone number.
- 7 1730 hrs.: Interviewed ANNA DECKER, WE 2-3119. She last saw DENISE on Saturday. DENISE had admired a St. Bernard. She felt that DENISE and KEN LITTLE lived across the street from her for about six months. She thought they had a tan Plymouth or Ford.
- 8 1820 hrs.: Arrived at Lake Sammamish Park. Interviewed KEN LITTLE at that time. R/O obtained signed statement from KEN LITTLE. Refer to statement for details. LITTLE related that BOB and NANCY's phone number is 485-1567, and they live in Bothell.
- 9 7-17-74 0825 hrs.: Received phone call from GLEN NOLL, 243-9264, address is 1046 S. 174th. He related that he owned the house NASLUND had been living in.
- 10 0835 hrs.: Had phone contact with JOHN BATES, 433-3326, H/P 641-0364, address 2202 177th Pl. NE, Redmond. On Sunday, 7-14-74 between 1215 hrs. and 1330 hrs., he related he saw JANICE OTT near the Rainier game area at Lake Sammamish State Park, talking with people.
- 11 0834 hrs.: Contacted Rainier Brewery. Information gained that TIM McKEE, 622-2600, was the one who managed the games at Lake Sammamish State Park.
- 12 0850 hrs.: Contacted ROBIN WOODS, 10624 21st SW. She last saw DENISE NASLUND July 3rd. She related that DENISE would not like bikers. She has another boyfriend by the name of BOB WOLFORD at EA 9-9393. He lives in the "U" District near Lake Union. She related that DENISE had met him at Graybar Electric when she worked there. She had not seen WOLFORD for two months.
- 13 0900 hrs.: TIM McKEE called from Rainier Brewery. He related that video tapes were taken by HARDY QUADE, 682-8230, representing Channels 5 and 11. Also taking video tapes at the park on Sunday was JOE CAIRO, 725-1400.
- 14 0905 hrs.: Talked with KATHY VERES. She will get together with SYLVIA VALINT and come down to the Courthouse together.
- 15 0920 hrs.: Had telephone contact with HARDY QUADE. Gave film to TV stations. He related that Channel 11, KSTW, had film and the man to contact was BOB CLAYLAND, 572-5789. Also, Channel 5 at MU-2-5555, JOHN LIPPMAN was the man to contact.
- 16 0935 hrs.: Contacted Channel 5, JOHN KVASNOSKY. He was in the process of looking at the film for the girls.

1h

INVESTIGATING OFFICER Det. Robert Keppel	SERIAL	UNIT H & R	APPROVED BY:
---	--------	---------------	--------------

 PAGE 2
OF 13

ADDITIONAL INFORMATION SHEET/OFFICER'S REPORT

7 4

9 5 8 5 2

TO	VIA	DATE 8-5-74	TIME
FROM		SUBJECT: CONTINUATION OF <input checked="" type="checkbox"/> OFFICER'S REPORT REGARDING <input type="checkbox"/> FOLLOW-UP REPORT	

ITEM:

- 17 7-16-74 0945 hrs.: Contacted CHARLIE BURD, KSTV - TV, who related that the King County Police could have the section of film he had. Made arrangements to pick up a film at S. 11th & Grant in Tacoma. SGT. RANDALL handled that contact.
- 18 1010 hrs.: Had phone contact with THERESA SHARPE, 486-8253, 2723 Stafford Way SE, Bothell. She related she had been sitting next to JANICE OTT on Sunday, July 14, 1974. She stated that at 1230 hrs. a subject 6'0" to 6'1", hair on the neck, brown, medium length, needed her to help him load a sailboat. He had no cast, but had his arm in a sling. He was wearing a white T-shirt, white shorts (boxer-type) dark tan. She related that JANICE said: "Under one stipulation, that I meet your folks." He had told her that the sailboat was at his parent's house in Bellevue. The distance she was sitting from JANICE OTT was about 2 yards. JANICE had a yellow 10-speed with a knapsack. JANICE was wearing a white blouse, short cut-offs, black bikini and JANICE's blouse was described as tying in front with the stomach and back skin showing. DET. GRUNDEN was assigned to take a statement from THERESA SHARPE. **SEE 74-96644 FOR STATEMENT.**
- 19 1030 hrs.: SYLVIA VALINT contacted at the Courthouse. R/O obtained a signed statement from SYLVIA VALINT regarding witnessing of a man called TED picking up JANICE OTT at Lake Sammamish State Park on July 14, 1974. **SEE 74-96644 FOR STATEMENT.**
- 20 1150 hrs.: Contacted BETTY BARRY, SPD payroll clerk, 583-2209. She related that she recognized the girl in the restroom as DENISE NASLUND on Sunday, July 14, 1974.
- 21 1200 hrs.: BETTY BARRY contacted at King County Courthouse. Obtained witness statement from BETTY BARRY.
- 22 7-17-74 1335 hrs.: Contacted DET. KESGARD, Bellevue PD and requested he check Overlake Hospital for left arm casts of suspect's description.
- 23 1135 hrs.: Contacted by KEN LITTLE by phone. He related that he had seen one of his friends at Lake Sammamish State Park on the day DENISE was missing. His name is [REDACTED] and he lives in White Center. He last saw [REDACTED] after DENISE was gone around 6:00 or 7:00 o'clock. He would describe him as 6'1", dark hair, mustache. LITTLE related that [REDACTED] thought DENISE was a tramp. He knows DENISE. **(SEE PARAGRAPH 38)**
PHOTO SHOWN TO WITNESSES, NEG. I.D.
- 24 1415 hrs.: Contacted JOHN KLEIN, KOMO-TV MU 2-3111 and said he would locate the film on the confrontation between the Jackals and W.S.P. The cameraman on the occasion was DOYLE DUDGEL.

1h

INVESTIGATING OFFICER Det. Robert Keppel	SERIAL	UNIT HGR	APPROVED BY:
---	--------	-------------	--------------

 PAGE 3
OF 13

ADDITIONAL INFORMATION SHEET/OFFICER'S REPORT

7 4

9 5 8 5 2

TO	VIA	DATE 8-5-74	TIME
FROM		SUBJECT: CONTINUATION OF <input checked="" type="checkbox"/> OFFICER'S REPORT REGARDING <input type="checkbox"/> FOLLOW-UP REPORT	

ITEM:

- 25 7-17-74 1605 hrs.: Had phone contact with MRS. [REDACTED] mother of [REDACTED]. She will try to contact her son and have him call on 7-18-74 at 0800 hrs.: R/O ran records check on [REDACTED] and he has a \$5,000 outstanding warrant for auto theft. (SEE PARAGRAPH 38)
- 26 1730 hrs.: ~~1730~~ Contacted Issaquah P.D. R/O received a statement from DAVID McKIBBEN from CHIEF PROSISE, Issaquah P.D. R/O also interviewed JACQUELINE PLISCHKE. R/O obtained a signed witness statement from JACKIE PLISCHKE. Refer to that statement for details. SEE 74-96644 FOR STATEMENTS.
- 27 7-18-74 0730 hrs.: Contacted Issaquah P.D. Received statement of JANICE GRAHAM from CHIEF PROSISE. Also R/O was notified by OFFICER RALPH of a lady who was at Lake Sammamish State Park wanting contact regarding her son's finding clothes at the park. SEE 74-96644 FOR STATEMENT
- 28 0815 hrs.: Contacted at Lake Sammamish State Park. Interviewed JUDI MARTINEZ, 15924 Sunset Highway #H-11, phone 747-9796. Her son was part of the pick-up crew and had picked up blue jeans with long legs, a T-shirt, black shoes with blue and red stripes, pink plaid bikini underwear, two white socks, and he had picked them up about 200 yards from the beach. R/O observed where the son picked up the clothing. The clothing is unrelated to this case.
- 29 0930 hrs.: Contacted at KING-TV with DETS. DUNN and HERGESHEIMER. Viewed films of Lake Sammamish State Park, July 14, 1974 and the Rainier celebration.
- 30 1150 hrs.: Contacted by JOHN KLEIN, KOMO-TV - he related that JOHN SANDIFER was bringing down film of the motorcycle confrontation at Lake Sammamish. Received film from JOHN SANDIFER. The film was given to SGT. RANDALL.
- 31 1215 hrs.: BOB SARGENT & NANCY BATTEMA CONTACTED AT [REDACTED] No answer at BOB WOLFORD's residence. ~~BA 9-9303. COMBINATION. WITNESS STATEMENT TAKEN FROM BATTEMA. SARGENT'S STATEMENT TAKEN BY DET. HERGESHEIMER. SEE THOSE STATEMENTS FOR DETAILS. R/O OBTAINED WITNESS STATEMENT FROM RENEE SCHENHAUS AT 1435 HRS.~~
- 32 7-18-74 1832 hrs.: Had phone contact with PATRICIA TURNER, 822-4043, GL 5-3856 address of 13416 118th NE, Kirkland. She related that she and her daughter were at Lake Sammamish State Park on Sunday. She observed a man at about 3:30 or 4:00 o'clock who matched the description of the suspect. Information given to DET. DUNN who obtained statement from PAT TURNER. SHE AGREED WITH DESCRIPTION DEPICTED ON COMPOSIT MADE ON 7-25-74.
- 33 7-19-74 0820 hrs.: Received phone call from NORA FOWLER, 883-0152, B/P 883-1066, address 9451 Avondale Rd., Redmond. She related that on the day DENISE NASLUND was missing she was with DENISE. She and her friends had left about 4:15 from where DENISE was sitting with KEN LITTLE and did not see them again. She related that KEN and DENISE were

1h

INVESTIGATING OFFICER Det. Robert Keppel	SERIAL	UNIT H&R	APPROVED BY:
---	--------	-------------	--------------

PAGE 4

OF 13

[Taped over # 37]

CHG. TO :

REC'D DENISE NASLUND'S ADDRESS BOOK FROM
KEN LITTLE. PREPARED COPIES OF PAGES AND
OBTAINED DIRECTORY INFO AS SHOWN ON
MARKED PAGES. BOOK TO BE PLACED INTO
EVIDENCE.

ADDITIONAL INFORMATION SHEET/OFFICER'S REPORT

Case No.

7 4

9 5 8 5 2

TO	VIA	DATE 8-5-74	TIME
FROM		SUBJECT: CONTINUATION OF <input checked="" type="checkbox"/> OFFICER'S REPORT REGARDING <input type="checkbox"/> FOLLOW-UP REPORT	

ITEM:

- not on the friendliest terms that day but she did not think it was enough to make DENISE go away.
- 34 7-19-74 1040 hrs.: Examined clothing in cases 74-95276 and 74-97279. Clothing examined is not related to this case.
- 35 1245 hrs.: Had phone contact with LANE HARTVIGSON, CH 4-9642. He related that he left Lake Sammamish State Park on Sunday at 3:30 p.m. At about 4:15 p.m. he saw a brown metallic VW, no front bumper, wide tires, mag wheels, parked at Pine Lake County Park. R/O had DET. GRUNDEN meet MR. HARTVIGSON at Issaquah P.D. at 1350 hrs.
- 36 1450 hrs.: Had phone contact with KEITH PANKAU, 746-2022. He recommended that the police check HANS JENSEN Youth Park Trails from Lake Sammamish State Park. R/O related to KEITH that these trails had already been checked.
- 37 ~~1515 hrs.:~~ Contacted BETTY BERRY to identify the sandals which were found. Also contacted NANCY BATTEMA to identify clothing. BERRY could not identify the sandals.
- 38 1720 hrs.: Contacted [REDACTED] 938- [REDACTED]. He stated he was at the park on Sunday, but he did not see NASLUND or LITTLE while at the park. He arrived at 1600 hrs. (SEE PARAGRAPHS 23 & 25)
- 39 7-21-74 0900 hrs.: Had phone contact with BOB WOLFORD, EA 9-9393. He last saw DENISE NASLUND about two months ago. She worked at Graybar Electric. She could fit into any crowd. He related she was gullible for lies given by men. **CONTACTED FROM INFO IN VICTIM'S PHONEBOOK.**
- 40 0904 hrs.: Had phone contact with GLEN MARTIN 243-5303. He last saw DENISE NASLUND 7 months ago. He will get ahold of BILL LAMB to have him call R/O. He was with BILL when he met DENISE. He does not know very much about DENISE NASLUND. **CONTACTED FROM INFO IN VICTIM'S PHONEBOOK.**
- 41 7-21-74 1045 hrs.: Contacted by JACKIE PLISCHKE. Made arrangements to **re-do** PLISCHKE's statement with contact at Wildwood Apts. between 1200 - 1230 hrs. in Issaquah. **SEE 74-96644 FOR STATEMENT**
- 42 **REVIEW** 1205 hrs.: Arrived Wildwood Apartments - PLISCHKE not at home.
- 43 1230 hrs.: Contacted at Wildwood Apts. waiting for PLISCHKE.
- 44 1243 hrs.: Contacted JACKIE PLISCHKE, mileage 92,543. Retraced PLISCHKE's bike ride on July 14, 1974. She started

1h

INVESTIGATING OFFICER
Det. Robert Keppel

SERIAL

UNIT
H & R

APPROVED BY:

PAGE

5

OF

13

ADDITIONAL INFORMATION SHEET/OFFICER'S REPORT

Case No.

7 4

9 5 8 5 2

TO	VIA	DATE	TIME
FROM	SUBJECT: CONTINUATION OF <input checked="" type="checkbox"/> OFFICER'S REPORT REGARDING <input type="checkbox"/> FOLLOW-UP REPORT		

ITEM:

at 3:30 p.m. at the MOREL residence at SE 29th & E. Lake Sammamish Road. She rode southbound on E. Lake Sammamish Road to Frontage Road, then continued across to the park riding through the Park Ranger's Station, and down to the main road which goes into the park. PLISCHKE pointed out to R/O where she was standing on the spit when she first observed suspect TED and also where she was confronted by suspect near the beach; PLISCHKE placed points on the map. Could not add anything farther to suspect's description. Interview ended at 1400 hrs., mileage 92,556.

45 7-22-74 1546 hrs.: Contacted by BILL LAMB, friend of DENISE NASLUND's. He last saw DENISE two months ago. He knew DENISE for four years. He didn't know her to use drugs to any great extent. She occasionally smoked pot. She was always with KEN LITTLE when he knew her. ~~CONTACTED FROM INFO IN VICTIM'S PHONEBOOK~~

46 1740 hrs.: Arrived at the VALINT residence, SYLVIA VALINT was not home.

47 1800 hrs.: Received information from SGT. NELSON in Radio Room that a SUE STEINER had been approached by a man named TED. She lives at 11803 SE 58th, 746-7744.

48 1900 hrs.: Arrived at 11803 SE 58th and interviewed witnesses STEINER, STONE, WYCKE, and HAYNES. See statements for information. ~~SEE 74-96644 FOR STATEMENTS~~

49 7-23-74 0930 hrs.: Contacted SYLVIA VALINT by telephone. She is to make a composite at 7-24-74 at 0900 hrs.'

50 1155 hrs.: Additional information received from CHIEF PROSISE on bicycle - 1) Shift levers are round; 2) Center pole breaks; 3) Has chrome wheels; 4) There are dual control brakes on the handlebars. Information given to SGT. RANDALL.

51 1600 hrs.: Had telephone contact with JUDY VanHORN, 525-2975, 9240 Densmore North. She used to work with DENISE NASLUND. She and DENISE NASLUND were assaulted previously by a [REDACTED] 28 - 30 years old, 5'10", a black male. DENISE used to call up JUDY at various times asking her if she wanted a date. JUDY knew that DENISE worked for a dating service. DENISE used to confide in JUDY and told her that her mother was very mean to her. ~~NO STATEMENT TAKEN.~~

52 7-24-74 0930 hrs.: Additional information was gained from CHIEF PROSISE, Issaquah P.D. 1) JANICE OTT had a D & C at Group Health Hospital from an Oriental doctor; 2) JANICE OTT's dentist is GEORGE KENNAUGH; 3) Received medical releases on JANICE OTT, placed in original file. Information was given to SGT. RANDALL.

1h

INVESTIGATING OFFICER Det. Robert Keppel	SERIAL	UNIT H & R	APPROVED BY:
---	--------	---------------	--------------

PAGE

6

OF

13

ADDITIONAL INFORMATION SHEET/OFFICER'S REPORT

Case No.

7 4

9 5 8 5 2

TO	VIA	DATE 8-5-74	TIME
FROM		SUBJECT: CONTINUATION OF <input checked="" type="checkbox"/> OFFICER'S REPORT REGARDING <input type="checkbox"/> FOLLOW-UP REPORT	

ITEM:

- 53 7-24-74 1010 hrs.: SYLVIA VALINT contacted at King County Courthouse. R/O displayed several photographs of possible suspects to VALINT, negative results. R/O went over VALINT's statement with SYLVIA for additional details.
- 54 7-25-74 1115 hrs.: Contacted by KATHY DOLIVO, 4801 Dunbar Dr., Gig Harbor, 458-3704. She related that she was a student at Central Washington State College and had seen a picture of the composite in her school newspaper. She called police because the newspaper said to call local police. The date she was confronted by suspect was 4-17-74 at 10:00 p.m. She could not see the car clearly but thought it was a dark colored, shiny VW. She stated that suspect had dropped some books and she helped him pick them up, and took the books to the car. She placed the books in the car for the suspect. The suspect wanted her to start the car but she refused. Suspect dropped the key to the car. She picked it up for him and left. Information was given to Central Washington State College police, CHERYL MARTIN. She decided she would have Pierce County take a statement from KATHY DOLIVO. CHERYL MARTIN's Seattle phone number is 525-6415, and she lives at 5244 35th NE.
- 55 7-26-74 1140 hrs.: Had telephone contact with ROBERT LIND, 746-6329, B/P 624-0393, address 2627 148th SE. He related he was at Lake Sammamish Park on July 14, 1974. He observed a man with green Levi pants, short sleeved shirt, red in color, left arm in a sling, large white cast, mid-twenties, 5'10", 160 lbs., medium build, rather light brown straight hair. He looked like he was lost, walking up and down the path at about 3:00 p.m. to 4:00 p.m. He was clean-shaven. **NO STATEMENT TAKEN.**
- 56 7-29-74 0955 hrs.: Called by JUDY STONE, B/P MA 3-8380, H/P 776-3664. She reported that a friend of hers named KATHY was approached by a similar suspect at Central Washington State College. R/O informed her that we have been in contact with KATHY and that this information has been received. **SEE PARAGRAPH 54**
- 57 0945 hrs.: Received phone call from DR. JAMES BURTT, 2764 72nd SE, Mercer Island, H/P AD 2-9725, B/P MA 3-6477. He has several photographs taken at Lake Sammamish on July 14, 1974. He will notify R/O when they are developed.
- 58 7-30-74 1815 hrs.: Contacted SYLVIA VALINT. She went through numerous photographs for possible suspects. She related that the photo of DARRELL WAYNE LAMBERT is similar to suspect that she saw pick up JANICE OTT. The face of the suspect is thinner like the photo of ARTHUR G. ANDERSON. LAMBERT's hair is the only thing that's right. ANDERSON looks too young; no mustache. LAMBERT's nose is too big.

1h

INVESTIGATING OFFICER Det. Robert Keppel	SERIAL	UNIT H & R	APPROVED BY:
---	--------	---------------	--------------

PAGE

7

OF

13

ADDITIONAL INFORMATION SHEET/OFFICER'S REPORT

7 4

9 58 5 2

TO	VIA	DATE 8-5-74	TIME
FROM		SUBJECT: CONTINUATION OF XX OFFICER'S REPORT REGARDING <input type="checkbox"/> FOLLOW-UP REPORT	

ITEM:

- 59 7-31-74 1630 hrs.: Received phone call from JOHN McKEE from MR. SPELLMAN's office. He called concerning clothing found at Black Diamond. He had received a phone call from a concerned citizen who felt the police did not do anything about the clothes being found. R/O related that the clothing had been photographed and confiscated, but appeared to have nothing to do with JANICE OTT or DENISE NASLUND's cases. Both JIM OTT and KEN LITTLE looked over the clothes and did not recognize any of them.
- 60 8-1-74 1430 hrs.: Contacted CHERYL SCHMEIZER, Central Washington State College. Requested complete file on SUSAN RANCOURT and KATHY PARKS.
- 8-2-74 0850 hrs.: Contacted AL ELLIOTT, Juvenile Court. DENISE NASLUND has no record with Juvenile Court.
- 61= 1010 hrs.: Received phone call from DIANE ARMSTRONG, 16515 126th Pl. SE, 226-0822; she related she had seen a similar suspect wearing print swim trunks, wearing a beige sling at Lake Sammamish State Park on July 14. She could not remember anything further. ~~NO STATEMENT TAKEN~~
- 62 8-5-74 1030 hrs.: Received cases on SUSAN RANCOURT and ROBERTA KATHLEEN PARKS from C.W.S.G.
- 63 8-6-74 1510 hrs.: Contacted Napa County S.O., SGT. LAND, 707-255-5500, R/O inquired as to any unidentified female bodies found in his county. He related that it was not his county that found the bodies but Sonoma County. He gave me the number of BUTCH CARLSTED.
- 64 1520 hrs.: Contacted Sonoma County S/O, California, 707-527-2185. Had phone conversation with BUTCH CARLSTED. He related that at this time they found 6 female bodies. He also related that all the bodies were nude, dumped in a rural area, normally in a ravine or near a ravine with water (running.) All the girls were from broken homes, all were known to hitchhike. The suspect is keeping all the clothes. None of the girls has been beaten up. Suspect gives the impression that he may be doing the girls a favor by killing them. The suspect normally leaves one piece of jewelry with the women. Police have never found any of the victims' clothing. All victims were found along Highway #101, California. He related he would send a resume of the six found bodies to R/O. All bodies have been identified. He also advised R/O to contact DICK VERBRUGGE, Santa Cruz County, 408-425-2225. VERBRUGGE was working on cases involving about 80 female bodies. The only lead on any of them is a possible suspect vehicle of a blue Plymouth Duster with a black racing stripe.
- 65 1015 hrs.: Contacted DICK VERBRUGGE, Santa Cruz County S.O. He related he would send me information on all the missing girls in the San Francisco area.

INVESTIGATING OFFICER Det. Robert Keppel	SERIAL	UNIT H & R	APPROVED BY:	PAGE 8 OF 13
---	--------	---------------	--------------	-----------------

ADDITIONAL INFORMATION SHEET/OFFICER'S REPORT

Case No.

7 4

9 5 8 5 2

TO	VIA	DATE 8-5-74	TIME
FROM		SUBJECT: CONTINUATION OF <input checked="" type="checkbox"/> OFFICER'S REPORT REGARDING <input type="checkbox"/> FOLLOW-UP REPORT	

ITEM:

- 66 8-8-74 1315 / 1515 hrs.: JACKIE PLISCHKE contacted at the King County Courthouse. She viewed all photos and annuals to this date. Negative results. She had checked with her friend MORREL and she left his house at 1630 hrs. She arrived at the park at 1700 hrs. and was approached by the suspect at 1715 hrs. After that she saw him walk off towards the restroom.
- 67 8-12-74 1115 hrs.: Had contact with JIM OTT. JANICE did not have any credit cards. JIM had closed out the checking account. There have been no checks written on the account. All checks have been accounted for. JIM OTT is duplicating all keys carried by JANICE OTT. He's getting a complete description of the knapsack carried by JANICE.
- 68 **REC'D KEYS FROM MR OTT.** Keys consisted of key ring with brown leather attached. One key was a house key, Kwikset brand, bronze in color. The second key was a VW key, silver (ignition.) The third key was a VW key, trunk, silver, with VW inscribed. The fourth key was a trunk key, silver. The fifth key was an Issaquah house key.
- 69 **TO DEFINE VICTIM'S APPAREL.** JIM OTT is to check on the beach towel, the print was possibly a Charlie Brown design. JANICE OTT frequently used Tanya cocoabutter for suntan. JAN did not wear jewelry. Possibly was wearing blue and white deck shoes. DR. BLACKBURN is to check on the shoes.
- 70 8-13-74 1300 hrs.: Received information from Issaquah P.D. that ARMEN BROOKER was staying at the Pickering Horse Barn across from the Alpine Veterinary Hospital. BROOKER had smelled suspicious odors in the area of the barn. This information was given to DET. LUNDINE to check out. **DETERMINED UNFOUNDED.**
- 71 2130 hrs.: Had phone contact with VERN ROUNDTREE, 852-5483, regarding the Northwest Hanglider's Association. He knows of two two-toned gold Ford supervans owned by Hanglider people. One owner is [REDACTED] of Wing's West, 525-[REDACTED]. [REDACTED] is not in the area but has seen [REDACTED] and [REDACTED] driving the van. [REDACTED]'s address is 26 [REDACTED] NE 62nd, 522-[REDACTED]. [REDACTED]'s phone number is 255-[REDACTED]. MRS. ROUNDTREE stated that she and her husband were at the Lake Sammamish boat launch on 7-14-74 and at 1500 hrs. She was waiting in the truck for her husband. A guy matching the composite came up to her and talked. They talked about kites for awhile, and the guy said he was coming from Denver and had sold motorcycles in Colorado. He was headed for Alaska to work for a month. She thought he was hitchhiking, but was not sure. He stated he would come back in a month. The guy came from the road, walked down the launch road, talked to MRS. ROUNDTREE for a few minutes, then walked to the launch area. Then he walked back along the road. On the way past he said to MRS. ROUNDTREE: "How do you like being an information booth?" He walked back to the E. Lake Sammamish Road, and she did not see him again.

INVESTIGATING OFFICER Det. Robert Keppel	SERIAL	UNIT H & R	APPROVED BY:
---	--------	---------------	--------------

 PAGE 9
OF 13

ADDITIONAL INFORMATION SHEET/OFFICER'S REPORT

Case No.

7 4

9 5 8 5 2

TO	VIA	DATE 8-5-74	TIME
FROM		SUBJECT: CONTINUATION OF <input checked="" type="checkbox"/> OFFICER'S REPORT REGARDING <input type="checkbox"/> FOLLOW-UP REPORT	

ITEM:

MRS. ROUNDTREE described him as a W/M, 5'9", slender, med. tan, white T-shirt, faded jeans, 22-23 yrs. old, sandy hair past the ears in a shag cut, and he had angular features. MRS. ROUNDTREE related that she was of similar appearance to the missing girls. **REFER TO PARAGRAPH 75.**
NO STATEMENT TAKEN. ✓

72 8-14-74 1045 hrs.: Had phone contact with CAROLYN MURPHY, CH 2-1394. She is an astrologer working on the missing girls' cases. She related that the next likely occurrence of a missing girl would be 4-5 days before the full moon, and 4-5 days after the full moon. She related that a subject under maximum stress would have to abduct a girl on October 10-11, more likely October 26-27, and the maximum stress would continue until November 30. Most similar assaults take place in the winter and spring, and then the summer months of June and July. The pattern shows from two to three months of activity, then the subject lets off. The personality type of this subject is: 1) exceptionally intelligent; 2) hatred or fear of women; 3) has had mother problems, probably that the mother was dominant and he felt that any punishment she would inflict on him was cruel; 4) suppressed homosexual type, unable to express male sex; 5) good looking, but only good looking in a non-attentive way (in other words, he would not get attention by his good looks); 6) able to play down what people tell him; 7) he's trustworthy; 8) he's slightly independent; 9) he's under 30, possibly 26 - 27 yrs. old; 10) he's close to home in Seattle. MRS. MURPHY related that the Libby, Montana missing girl was more than likely a runaway, possibly elopement involved. She's on the southern Oregon border, but she's not happy with her situation at this time. MRS. MURPHY did an astrological chart on LYNDIA ANNE HEALY. She related that if her calculations are correct, LYNDIA ANNE HEALY is 2.5 miles from where she was abducted on a south, southeast axis. She's in an improved land area, in the open. MRS. MURPHY gave examples of the Arboretum, ball field, and the area would be lush, but not weedy. She felt that NASLUND and HEALY had the same injuries; severe head injuries, possibly throat cut. She felt that if her calculations were correct, the 2.5 miles was accurate, but if it were not correct, then you multiply 2.5 by 7.

73 MRS. MURPHY did an astrological chart on [REDACTED]. She felt that the subject who abducted [REDACTED] was maybe in his early 40s, male, black or brown hair, 6'0", rather tall, not heavy set. The suspect has a strong attraction to a girl looking like [REDACTED]. His initial motive may have been for money. He's not particularly good looking; he's got a big nose. He may have a sex deviant background. Has a record for check forgery. The suspect is from some distance away, and not from the local neighborhood. MRS. MURPHY felt that due to the press coverage of the [REDACTED] case that this has possibly scared the suspect into doing away with [REDACTED].

74 8-16-74 1615 hrs.: R/O was contacted at the King County Courthouse by JIM OTT and LOIS JONES. R/O received phone calls made from [REDACTED]

INVESTIGATING OFFICER Det. Robert Keppel	SERIAL	UNIT H & R	APPROVED BY:
---	--------	---------------	--------------

PAGE 10
OF 13

ADDITIONAL INFORMATION SHEET/OFFICER'S REPORT

74

95852

TO	VIA	DATE 8-5-74	TIME
FROM		SUBJECT: CONTINUATION OF <input checked="" type="checkbox"/> OFFICER'S REPORT REGARDING <input type="checkbox"/> FOLLOW-UP REPORT	

ITEM:

- JANICE OTT's apartment. R/O also received tape of MARCY BACON from LOIS JONES. **TAPE TO BE PLACED INTO EVIDENCE!**
- 75 8-19-74 0833 hrs.: Contacted by ART OLSEN. He was in Olympia on July 14, with his family in the van. He claimed that [REDACTED] had a gold Blazer that could be mistaken for a tan van. **Refer to PARAGRAPH 71**
- 76 8-20-74 1015 hrs.: Contacted by JIM OTT. He related that DEE PETERSON knows when JAN OTT left the Northlake Tavern the week prior, and had an accident there. This was the same day that JAN OTT was confronted on Front Street and I-90 by two guys driving a VW, both were fairly good looking. They said: "Oh, we didn't know that any foxy chicks lived in Issaquah." She had related this information to BETTY STOVER. **NO STATEMENTS TAKEN**
- 77 1030 hrs.: Called by [REDACTED], 38 [REDACTED] S. 321st, Auburn. He requested flyers be sent to him on the missing girls. R/O ordered DMV photo on [REDACTED] and also mailed him the flyers on the missing girls. **Photo shown to witnesses, NEG. I. D.**
- 78 8-22-74 1201 hrs.: Had phone contact with DIANE CRIPPE, 746-2176. She reported that she had observed in a comic magazine, a place in New York where you could buy phony arm casts for \$1.50. The address is Honor House Production Corp., Dept. 53, GK-31, 35 Wilbur St., Lynbrook, New York 11563.
- 79 8-26-74 1210 hrs.: R/O was contacted at the courthouse by DET. PAUL BARCLIFT, Thurston County Sheriff's Office. Received cases of DIVINE and BAKER from DET. BARCLIFT.
- 80 8-27-74 1530 hrs.: Contacted by JIM OTT. His new phone number is 543-3665, where he works. He related that he saw a name plate of [REDACTED] in the U of W. pharmacy. He related he would find out further information. **POSSIBLE "TED" SUSPECT ELIMINATED AS AN ORIENTAL.**
- 81 8-28-74 0930 hrs.: JIM OTT contacted at the Courthouse. He viewed a blouse which had been recovered from the Fall City area. He had never seen the blouse before.
- 82 8-30-74 0825 hrs.: Received phone call from JIM OTT. ~~He related that the license plate of a Dodge Charger, green in color. He also observed 2 brown VWs. One was a Washington plate. The other was a license plate SR [REDACTED].~~ OTT related that the church next to JANICE OTT's house has a caretaker, and the caretaker may have seen JANICE OTT on July 14th. **THIS INFO WAS NOT PERTINENT AS THE VICTIM HAD NOT RETURNED HOME AFTER DISAPPEARANCE.**
- 83 1345 hrs.: Had phone contact with LINDA DRAHN, 1212 SW 170, 243-1922. She related that on 7-13-74 between 5:30 and 6:30 p.m. she had

1h

INVESTIGATING OFFICER Det. Robert Keppel	SERIAL	UNIT H & R	APPROVED BY:	PAGE 11 OF 13
---	--------	---------------	--------------	------------------

ADDITIONAL INFORMATION SHEET/OFFICER'S REPORT

Case No.

74

9 5 8 5 2

TO	VIA	DATE 8-5-74	TIME
FROM		SUBJECT: CONTINUATION OF XX OFFICER'S REPORT REGARDING <input type="checkbox"/> FOLLOW-UP REPORT	

ITEM:

talked to JANICE OTT on the phone. JANICE OTT was a good friend of hers. JAN wanted to go out drinking in the "U" District and dancing. LINDA stated that ~~she~~ ^{JANICE} had spent the day at Lake Sammamish State Park. JANICE OTT was a little ~~upset~~ ^{upset} that she had missed her sister, ~~GARMA. JAN used to talk about not feeling bad about others because they did hard to her to GARMA.~~ ^{NO STATEMENT TAKEN.}

84 9-3-74 1045 hrs.: Received a phone call from DET. MULLENS, Steilacoom P.D. 588-4600. He is currently investigating a rape/assault and has developed information from Arizona and California on a suspect. He related that DET. BALLARD, Tucson, Arizona, 602-792-8116 had suspect information on one missing girl, and one murdered girl. The suspect is [REDACTED], [REDACTED], currently being held in a Santa Ana jail. [REDACTED] is 5'7", a truck driver, a biker, and goes by at least 7 aliases. DET. BALLARD also had information on a sususpect in homicides in Michigan who drives a tan VW. DET. MINTON, Los Angeles P.D. Homicide, has someone stabbing people on college campuses in Los Angeles. He also related that FBI BAGLEY in Arizona, 602-623-4306, was working the murdered girl case since the murdered girl is his daughter. MULLENS also related that a MILO BIGGS, Mesa County Sheriff's Office, Colorado, has an unidentified female body, found nude who is 5'6", 115#, wears contact lenses. The subject had been beaten and strangled. The phone number there is 303-242-3322.

85 1120 hrs.: Contacted DET. BALLARD, Tucson Sheriff's Office. The subject they currently have in custody is [REDACTED], who is from Oregon, born in 1953. He is 5'7" 140#. He uses a knife and is known for heterosexual and homosexual relations. DET. BALLARD will send photograph of [REDACTED] to R/O.

86 1145 hrs.: Contacted SGT. R.W. REED, Orange County jail, 714-834-3000; he will send photograph of [REDACTED]

87 1220 hrs.: Contacted Undersheriff TODD HUTCHINSON, Mesa County Sheriff's Office, Colorado. He described the victim as 15-21 yrs 5'7", 130# dark brown hair, shoulder length, pierced ears, blue sapphire birthstone, small wooden cross on a wooden chain, contact lenses with a red dot. She has been dead for approximately 24 hrs., beaten suffocated, and she had been dragged through gravel after death. She never had any children; had considerable dental work. She was found on July 2nd. Information was given to SPD.

88 9-5-74 1345 hrs.: Contacted SGT. AUBUSTON, Mercer Island P.D. He related he had clothing that had been turned in by DR. DONALD R. STROME, 4614 West Mercer Way, H/P 232-1319, B/P 773-0533. He found clothing 100 ft. up a road north of Highway #18 near Tiger Mountain parking lot area.

1h

INVESTIGATING OFFICER Det. Robert Keppel	SERIAL	UNIT H & R	APPROVED BY:
---	--------	---------------	--------------

 PAGE 12
OF 13

ADDITIONAL INFORMATION SHEET/OFFICER'S REPORT

74

95852

TO	VIA	DATE 8-5-74	TIME
FROM		SUBJECT: CONTINUATION OF <input checked="" type="checkbox"/> OFFICER'S REPORT REGARDING <input type="checkbox"/> FOLLOW-UP REPORT	

ITEM:

- 89 9-5-74 1400 hrs.: Contacted at Mercer Island P.D. Examined the clothing; the clothing is not connected with the girls' cases.
- 90 1510 hrs.: Contacted by MARGE STUTH, 13802 160th SE, AL 5-3546. She related that her husband had found some clothing, mainly a bikini in a case in the Fall City area.
- 91 1600 hrs.: Contacted at the STUTH residence and picked up clothing. There was a light green bikini, size 14, in a light green case, two pairs of blue jean cut-offs, miscellaneous make-up and suntan lotion. These items are not related to the missing girls' cases.
- 92 9-6-74 1300 hrs.: Contacted JACK MORRIS, Spokane County Sheriff's Office. R/O inquired if their suspect in their homicide was similar to composite. The suspect's name is [REDACTED], 5'6", 170#, short blond hair, 19 yrs. MORRIS will send a photo of [REDACTED] to R/O.
- 93 1330 hrs.: Contacted DR. BLACKBURN, 509-455-3694. DR. BLACKBURN related that JANICE OTT did not have pierced ears, and did not wear contact lenses although she is near sighted. When she went swimming she usually took off all jewelry to include her wedding ring. There were no blue and white shoes among her belongings that he picked up in Issaquah.
- 94 Numerous other leads on persons thought to be "TED" and vehicles similar to Volkswagens described, have been checked and eliminated.
- These names and license numbers are too numerous to list and are found in files by cross referenced card indexes.

1h

INVESTIGATING OFFICER Det. Robert Keppel	SERIAL	UNIT H G R	APPROVED BY:
---	--------	---------------	--------------

 PAGE 13
OF 13

0109525

CCN # 0109525

MISSING FROM Lk. Sammamish

SEARCHED

ENTERED

07-15-74

ALERT

FCH# 100

878-915-D-0

KING COUNTY DEPARTMENT OF PUBLIC SAFETY

MISSING PERSON REPORT

CASE

☒ ADULT☒ MISSING

DATE

7-15-74

TIME

1642

NO.

74

95

85

2

☐ JUVENILE☐ RUNAWAY

COMPUTER CHECK MADE

☒ YES☐ NO

CAR DISTRICT NO.

F1 (SE)

SEX FEMALE

RACE WHITE

CHECKED BY

DAVID J. NELSON

TIME

1710

DATE

7-15-74

NAME

NASLUND, DENISE, MARIE

ADDRESS

4522 SW GRAHAM

(SEATTLE)

AGE

18

DOB

10-10-55

PHONE: HOME

WE-8-0150

BUSINESS

RO-2-8765

REPORTED BY

ROSE, ELEANORE

RELATIONSHIP

MOTHER

ADDRESS

8652

13th SW

CITY & STATE

SEATTLE, WA

PHONE

RO-2-8765

OTHER PARENTS

ADDRESS

OR RELATIVES

PHONE: HOME

BUSINESS

RELATIONSHIP

FURTHER

DESCRIPTION

HEIGHT

5-4

WEIGHT

110

BUILD

SLIM

EYES

BROWN

GLASSES?

NO

HAIR: COLOR

DARK BROWN

STYLE

LONG STRAIGHT

COMP.

OLIVE

TEETH

DARK

☐ MARRIED☒ SINGLE☐ OTHER

SCARS

1 1/2" SCAR NEAR THUMB
BIRTH MARK UNDER RT. BIRTH MARK

CLOTHING

CUTOFF SHORTS,

DARK BLUE HAWAIIAN TOP,

BROWN SANDALS

(NO OTHER DESCRIPTION)

OCCUPATION AND/OR HABITS

DEAN TOPS AGENCY (SEATTLE)

- NOT KNOWN -

MAY BE WITH NAME

ADDRESS

AGE

PHONE

OTHER INFO.

DOB

HEIGHT

WEIGHT

BUILD

EYES

HAIR: COLOR

STYLE

COMP.

TEETH

- NOT KNOWN -

MOTOR VEH.

YEAR

MAKE

TYPE

LIC. #

INVOLVED

C

COLOR(S)

OWNED/DRIVEN BY

MISSING SINCE

07-14-74

1600

(FROM Lk. Sammamish St. Park)

ADDITIONAL INFO.

LIVES WITH A KENNETH LITICE AT THE SW

GRAHAM ADDRESS. - WALKED AWAY FROM HER BOYFRIEND

AT Lk. Sammamish STATE PARK, LEFT HER 69 CHEV WITH THE

BOYFRIEND WHOSE PURSE INSIDE - HAS RUNAWAY OVER BEFORE

SEVERAL YEARS AGO. - OVER -

REPORT TAKEN BY

DAVID J. NELSON

SER #

34

TIME BROADCAST

OFFICE 1ST

KCDPS C-109 6/73

TELETYPE BY

NO CONTACT
CAR ASSIGNEDORIGINAL
FILE

THE BOYFRIEND SEARCHED THE AREA OF THE STATE PARK
WITH NO RESULTS - HER FRIENDS HAVE BEEN NOTIFIED ALSO
WITH NO RESULTS - HAS NO MONEY OR I.D.

07/17/74 0204 SKOW.S.A.OCA/7495852

CCN/0109525 ***** WARRANTS *****

SEAPD 020001 071473 0956 HAM/HASLUND, DENISE MARIE

SEAPD 020002 071473 0956 SEAPD 071673 1543 SEX/F RAC/W DOB/101055 HGT/504
WGT/110 HA1/BRO EYE/BRO SKN/OLV VSM/SC L HND

SEAPD 040001 071473 0956 ADR/8652 13 AV SW SEATTLE WA

KCDPS 090001 071574 2011 OCA/7495852 DOW/071574 TOW/MP OFF/MISSING PERSON
FILE/1642 PHP/WE80151

LOOKQ-000*PCEND

Janet OTT 7

KING COUNTY DEPARTMENT OF PUBLIC SAFETY
FOLLOW-UP REPORT

Case No.

7 4

0 9 5 8 5 2

PRESENT DATE

07-17-74

TYPE OF CASE

Missing Person Adult
ORIGINALLY REPORTED AS

DATE OF OCCURRENCE

07-14-74

Original Invest. Officer

LOCATION OF OCCURRENCE

Lake Samamish State Park

VALUE RECOVERED

Missing Person Adult

VICTIM

ADDRESS

PHONE

Ott, Janice

CASE

STATUS:

OPEN ☒

INACTIVE ☐

CLOSED ☐

DISPOSITION:

CLEARED BY ARREST ☐

EXCEPTIONAL CLEARANCE ☐

UNFOUNDED ☐

PROPERTY:

RECOVERED ☐

ADDITIONAL STOLEN ☐

FURTHER DESCRIPTION ☐

INDICATE ID MARKS—COLORS—SIZES—
SERIAL NUMBERS—DISPOSITION—VALUE
ETC. AS FIRST ENTRY BELOW

ENTRY

COMMENCE EACH ENTRY WITH A NUMBER AND THE DATE AND TIME

SUSPECTS:

INCLUDE NAMES, B/A NUMBERS, DESCRIPTIONS, DISPOSITION, CAN VICTIM IDENTIFY, ETC.

GENERAL:

SUMMARIZE STEPS OF INVESTIGATION: INCLUDE PERSONS INTERVIEWED, ADD'L WITNESSES, RESULTS OF INTERROGATIONS, EVIDENCE, BUSINESS ADDRESSES AND PHONES, ETC.

CASE M.O.:

INDICATE ADD'L M.O. FACTORS NOT INCLUDED ON OFFENSE REPORT.

Suspect: White/Male 20-30years Brown Hair Slim Build Cast on right arm from wrist to above elbow Possible name of Ted

Witnesses: 1. Veres, Kathalene, E. 5360 S. Avon 722-3736 20yrs Employed at Pemco Ins on E. Lake 682-4132. Contact at home before 1600hrs.

2. Okada, Pamela 11111 Luther Ave S. PA 5-6887 20yrs Employed days.

3. Vallint, Sylvia address unk phone unk 15yrs (Kathy Veres will be able to supply the address and phone upon detective contact)

At approx 0130 hrs this date I was detailed to 5360 S. Avon to contact witness 1 about the missing girls at Lake Samamish State Park. Upon my arrival The witness contacted me outside her residence as she did not want to alarm her family.

Kathy related to me that on Sunday she and the other two witnesses had gone to Lake Samamish to watch the races. They placed their blanket on the beach approx 75 feet from the water directly behind the floating raft. At about 1230 hrs they saw this "well built fox ^{NEAT} come down the beach with a yellow ten speed bike." The girl placed her beach towel down to the witnesses, and sat down on the towel. Sylvia was the closest to the girl with Pam and Kathy on the other side of Sylvia. This girl was described as about 5'-5'6" long blonde hair, approx 3" over shoulder. She was wearing a dark bikini with a halter top. She also had a blue knapsack. This girl was sitting on her towel for approx 20-30 min when a ^{sail} man walked up to her and stated "could you help me pull my boat out of the water." The girl replied, "sure, why don't you sit down and we will talk about it, my name is Jan." He replied my name is "Ted."

Jan "I'll help you if you will take me for a ride in your boat, where is it?"

Ted "Its at my parents house, its safer there."

At this time Kathy and Pam got up and went to the consession stand. They returned in approx 5 min. The girl (Jan) and guy (Ted) had left. Kathy asked Sylvia where they had

PAGE 1
OF 2

Eilers, M.D.
INVESTIGATING OFFICER

01246
SERIAL

JKJ
UNIT

Sgt. Keith W. May
APPROVING OFFICER

KING COUNTY DEPARTMENT OF PUBLIC SAFETY
ADDITIONAL INFORMATION SHEET

Case No.

7 4

0 9 5 8 5 2

TO	VIA	DATE	TIME
FROM	SUBJECT: CONTINUATION OF <input checked="" type="checkbox"/> OFFICER'S REPORT REGARDING <input type="checkbox"/> Missing Person Adult		

ITEM:

gone, and Sylvia replied they had left toward the parking area.
Kathy called Pam at approx 2200 hrs this date after reading about the incident in the paper.
Kathy and Pam did confer in lenght as to what they saw and heard from Jan and Ted's conversation. Kathy said that she only looked at Ted once, and at that time he was partially turned away from her.
Kathy was unsure about Ted's physical make-up, so I went through a physical description sheet with her. This sheet is attached to this case.
Kathy also stated that her parents are some what reluctant to talk to police, as they are from Hungary and do not speak English very well. Pam is willing to talk to the police.
Kathy stated that Sylvia may prove to be hard to talk to because of her parents. They also are from Hungary. They left the country during the revolution and do not have the greatest trust for the police. They speak very poor English and are very protective of their daughter. Kathy said that if the detectives would contact her before seeing Sylvia that she (Kathy) would go with the detectives to help explain the situation to the parents. Kathy said she would not see Sylvia before being contacted by the detectives.
Pam said that they did not listen to the whole conversation, just the good parts. She described Ted as an average looking guy with no obvious defects. She did say he was a smooth talker, using a low tone of voice. *They were together approx 15-20 mins.*
Kathy asked to be contacte between 1000-1200 hrs sometime before Friday. She will be going out of town.

80:30 AM

INVESTIGATING OFFICER

Eilers, M. D.

SERIAL

06246

UNIT

3KJ

APPROVING OFFICER

PAGE

2

ORIGINAL

OF

2

KING COUNTY DEPARTMENT OF PUBLIC SAFETY
FOLLOW-UP REPORT

Case No.

74

095852

CD# 74-255

PRESENT DATE
08-18-74

TYPE OF CASE

MISSING PERSON (SEARCH & RESCUE)

DATE OF OCCURRENCE

07-15-74

Original Invest. Officer

NELSON #34, Radio Room

ORIGINALLY REPORTED AS

LOCATION OF OCCURRENCE

Samamish State Park, Issaquah, Wa.

VALUE RECOVERED

SAME

VICTIM

ADDRESS

PHONE

NASLUND, Denice M. 10-10-55. 4522 SW Graham st Seattle, Wa.

WE8-0150

CASE

STATUS:

OPEN ☒

INACTIVE ☐

CLOSED ☐

DISPOSITION:

CLEARED BY ARREST ☐

EXCEPTIONAL CLEARANCE ☐

UNFOUNDED ☐

PROPERTY: RECOVERED ☐ ADDITIONAL STOLEN ☐ FURTHER DESCRIPTION ☐ { INDICATE ID MARKS—COLORS—SIZES—SERIAL NUMBERS—DISPOSITION—VALUE ETC. AS FIRST ENTRY BELOW

ENTRY

SUSPECTS:

INCLUDE NAMES, B/A NUMBERS, DESCRIPTIONS, DISPOSITION, CAN VICTIM IDENTIFY, ETC.

GENERAL:

SUMMARIZE STEPS OF INVESTIGATION: INCLUDE PERSONS INTERVIEWED, ADD'L WITNESSES, RESULTS OF INTERROGATIONS, EVIDENCE, BUSINESS ADDRESSES AND PHONES, ETC.

CASE M.O.:

INDICATE ADD'L M.O. FACTORS NOT INCLUDED ON OFFENSE REPORT.

COMMENCE EACH ENTRY WITH A NUMBER AND THE DATE AND TIME

0900 hrs. I, along with Search Dog units searched the area east of the park for any signs of decaying bodies.

1300 hrs. The search was secured with negative results.

Refer to 74-96644, OTT, Janice, DOB 02-14-51. Also involved in search.

PAGE

OF

INVESTIGATING OFFICER

SERIAL

UNIT

APPROVING OFFICER

ORIGINAL

KING COUNTY DEPARTMENT OF PUBLIC SAFETY
BUREAU OF POLICE OPERATIONS

SUSPECT PHYSICAL DESCRIPTION FORM

SECTION A: This section to be filled in
by police officer on scene.

DISTRICT NO. K3 CASE NO. 74-98852
DATE 07-17-74 TIME 0230 (A.M.) / P.M.

CRIME CLASSIFICATION: Missing Person
(Armed Robbery, Assault, Burglary, Forgery, Homicide)
LOCATION ADDRESS: Lake Sammamish Park
NAME OF BUSINESS: _____

SECTION B: This form should be made out as soon as possible after the crime is committed
to insure accurate information. If you are unable to complete the form while
the officers are present, please fill it out as soon as possible and call the
King County Police, notifying them you have a completed robbery form for them
to pick up. Please fill in or acknowledge all spaces with a check, if you are
unable to answer all questions.

SUSPECT NO. 1
1, 2, 3, etc.

RACE: White SEX: Male AGE: 20's yrs. HEIGHT 5-6'-6"0"
White, Black, Indian Male-Female (Approx.) (Approx.)

HAIR COLOR: ON HEAD Light (Brown maybe) HAND AND ARMS _____
Red, Black, Brown, Blond

HAIR STYLE: STRAIGHT X WAVY _____ CURLY _____ LONG Over ears (Length) partial
CREWCUT _____ BALD _____ RECEDING _____
(Percentage from front)

BEARD _____ MUSTACHE _____ MUTTON CHOPS _____ SIDEBURNS X

EYES: COLOR _____
Blue, Brown, Hazel, Maroon

GLASSES: NO X YES _____ DESCRIBE: _____
Frame, Shape, Tint, Bifocal, Sun Glass, Reflector,
Color, etc.

NOSE: DESCRIBE Nothing peculiar
Large, Small, Pointed, Hooked, Flat, Broken, Bent, Color, or other

MOUTH: DESCRIBE _____
Wide, Narrow, Full, Pinched, Thin, Straight Line, Slack, Open or other

TEETH: DESCRIBE _____
White, Straight, Yellow, Crooked, Missing, Fillings, Caps, Bridges, False

CHIN: NARROW _____ BROAD _____ PROTRUDING _____ CLEFT _____ SQUARE _____ POINTED _____

EARS: LARGE _____ SMALL _____ PROTRUDING _____ CLOSE TO HEAD _____ POINTED _____

LONG _____ ROUND _____ MISSING _____ OTHER DESCRIPTION _____

COMPLEXION: CLEAR _____ PIMPLED _____ POCK-MARKED _____ FRECKLED _____ SUNTANNED X

RUDDY _____ PALE _____ FLUSHED _____ BLOTCHY _____

VOICE: CRISP // CLEAR // SOFT X HARSH // COARSE // ACCENT // Smooth talker
Nativity if known

IMPEDIMENT // CLEFT PALATE // LISP // SLURRED // GRAVELLY // HIGH //

HEAD: ROUND X LONG // THIN // TRIANGULAR // SQUARE // OTHER _____

COAT: NONE // JACKET // SWEATER // FATIGUE // CAR COAT // LEATHER // LONG //

SLEEVE // SHORT SLEEVE // SUEDE // RAIN // DRESS TYPE // Color _____

SHIRT: NONE X SHORT SLEEVE // LONG SLEEVE // PRINT // DRESS TYPE // _____

Color _____

OPEN COLLAR // SPORT // TAPERED // TUCKED IN TROUSERS // OUTSIDE TROUSERS //

TIE: NONE // NARROW // MEDIUM // WIDE // PLAIN // PRINT // _____

Color

ORIGINAL

SUSPECT PHYSICAL DESCRIPTION FORM (CONT'D)

TROUSERS: UNKNOWN // SPORT SLACKS // SHORTS // DRESS TROUSERS // WORK TYPE //
 JEANS // FRISCO JEANS // PRESSED // CLEANED // DIRTY // PATCHED //
 FLARED // TAPERED // BELTED // UNBELTED // VISIBLE POCKETS //
 OTHER DESCRIPTION: _____

(Color, unusual characteristics)

SHOES: NONE // OXFORD // HIGH SHOE // WORK SHOE // BOOT, HIGH // BOOT, MOD.
 STYLE // COWBOY TYPE // TENNIS SHOE // DECK SHOE // SANDAL //
 THONGS // LOAFER // WING TIP // COLOR _____

GENERAL OVERALL APPEARANCE: WELL-GROOMED // SLOPPY // HIPPY // UNKEMPT //
 "CLEAN CUT" // WELL-MANICURED FINGERNAILS // DIRTY FINGERNAILS //
 GREASE SMUDGES // AFTER SHAVE LOTION // PERFUMED //

WORD USAGE IN DIRECT QUOTES: _____

(If none, so indicate)

DIRECTION OF TRAVEL FROM SCENE: FRONT DOOR // REAR DOOR // SIDE DOOR // RIGHT //
 LEFT // NORTH // SOUTH // EAST // WEST // (Check more than one if
 necessary) *inlet from beach to parking*

MODE OF TRANSPORTATION IF KNOWN: ON FOOT ☒ AUTOMOBILE // MOTORCYCLE //
 COLOR _____ LICENSE NUMBER _____ STATE _____
 4 DOOR // 2 DOOR // CONVERTIBLE // PANEL // BUS //

WEAPON DISPLAYED? YES // NO // IF YES, DESCRIBE: PISTOL // RIFLE // REVOLVER //
 SHOTGUN // BLUE // BLACK // NICKLE // CHROME // (Check more than one if
 necessary)

CALIBER IF KNOWN _____ OTHER CHARACTERISTICS _____

HAND HOLDING WEAPON? RIGHT // LEFT // IN COAT POCKET // IN BELT // IN HOLSTER //
 IN TROUSER POCKET //

OTHER DESCRIPTIVE ITEMS: WATCH // RING // BEADS // MEDALION // FRATERNITY PINS //
 CLUB PINS // PENS // PENCILS // EARRINGS // LIMP //
 PHYSICAL DEFECTS _____

(Describe if any)

I have read and marked the above form describing the suspect(s) to the best of my knowledge and belief.

FORM MADE OUT BY:

SIGNATURE: _____

NAME: Katharine Elizabeth
 (Print) First Middle Last

DATE 07-17-74 TIME 0300

HOME ADDRESS: 5360 So Aven

CITY: Seattle PHONE 222-3736

BUSINESS ADDRESS: Remco Inc. E. Lake

CITY: _____ PHONE 682-4132

BUSINESS NAME _____

CITY: 74 PHONE _____

INVESTIGATING OFFICERS: Filer, Mark D

CAR NO. 3K37 PATROL 7

REMARKS:

Not Fat - some muscles on arms

JUL 17 AM 8:03

RECORD
SECTION

KING COUNTY DEPARTMENT OF PUBLIC SAFETY
FOLLOW-UP REPORT

Case No.

7 4

0 9 5 8 5 2

PRESENT DATE

07-23-74

TYPE OF CASE

DATE OF OCCURRENCE

Original Invest. Officer

Missing Person

07-15-74

Radio #34

ORIGINALLY REPORTED AS

LOCATION OF OCCURRENCE

VALUE RECOVERED

Same

Lake Sammamish State Park

VICTIM

ADDRESS

PHONE

Naslund, Denise M.

4255 SW Graham

Unk

C
A
S
E

STATUS:

OPEN ☒

INACTIVE ☐

CLOSED ☐

DISPOSITION:

CLEARED BY ARREST ☐

EXCEPTIONAL CLEARANCE ☐

UNFOUNDED ☐

PROPERTY:

RECOVERED ☐

ADDITIONAL STOLEN ☐

FURTHER DESCRIPTION ☐

{ INDICATE ID MARKS—COLORS—SIZES—
SERIAL NUMBERS—DISPOSITION—VALUE
ETC. AS FIRST ENTRY BELOW

E
N
T
R
Y

COMMENCE EACH ENTRY WITH A NUMBER AND THE DATE AND TIME

SUSPECTS:

INCLUDE NAMES, B/A NUMBERS, DESCRIPTIONS, DISPOSITION, CAN VICTIM IDENTIFY, ETC.

GENERAL:

SUMMARIZE STEPS OF INVESTIGATION: INCLUDE PERSONS INTERVIEWED, ADD'L WITNESSES, RESULTS OF INTERROGATIONS, EVIDENCE, BUSINESS ADDRESSES AND PHONES, ETC.

CASE M.O.:

INDICATE ADD'L M.O. FACTORS NOT INCLUDED ON OFFENSE REPORT.

1300 Hrs: After reviewing the infared photos, R/O and Off. Dawson proceeded to Lk. Samm. St. Park. At the park, we checked the likely areas, five of them, with negative results. The infareds, in the areas we checked, pointed out dead vegetation, such as bails of hay, dead trees, wood piles of large branches and dead black berry bushes. Black and white photos of the areas checked are attached.

*in James J. O'Brien
Capt. Walters m. Perunich*

A & R copy

Kenneth W. Wardstrom

#06126

M-3

INVESTIGATING OFFICER

SERIAL

UNIT

APPROVING OFFICER

PAGE

1

OF

1

ORIGINAL

KING COUNTY DEPARTMENT OF PUBLIC SAFETY
FOLLOW-UP REPORT

Case No.

7 4

0 9 5 8 5 2

CD 74-255

PRESENT DATE

07-22-74

TYPE OF CASE MISSING PERSON		DATE OF OCCURRENCE 07-15-74	Original Invest. Officer David J. Nelson #34 Radio
ORIGINALLY REPORTED AS SAME		LOCATION OF OCCURRENCE Lake Sammamish State Park	VALUE RECOVERED
VICTIM NASLUND, Denise Marie	ADDRESS 4522 SW Graham Sea	PHONE WE8-0150	
C A S E	STATUS:	OPEN <input checked="" type="checkbox"/>	INACTIVE <input type="checkbox"/>
	DISPOSITION:	CLEARED BY ARREST <input type="checkbox"/>	EXCEPTIONAL CLEARANCE <input type="checkbox"/>
			CLOSED <input type="checkbox"/>
			UNFOUNDED <input type="checkbox"/>

PROPERTY: RECOVERED ☐ ADDITIONAL STOLEN ☐ FURTHER DESCRIPTION ☐ { INDICATE ID MARKS-COLORS-SIZES-SERIAL NUMBERS-DISPOSITION-VALUE ETC. AS FIRST ENTRY BELOW

COMMENCE EACH ENTRY WITH A NUMBER AND THE DATE AND TIME

SUSPECTS: INCLUDE NAMES, B/A NUMBERS, DESCRIPTIONS, DISPOSITION, CAN VICTIM IDENTIFY, ETC.

GENERAL: SUMMARIZE STEPS OF INVESTIGATION: INCLUDE PERSONS INTERVIEWED, ADD'L WITNESSES, RESULTS OF INTERROGATIONS, EVIDENCE, BUSINESS ADDRESSES AND PHONES, ETC.

CASE M.O.: INDICATE ADD'L M.O. FACTORS NOT INCLUDED ON OFFENSE REPORT.

07-16 0900Hrs: Advised by Sgt. Weaver that there were two missing girls from the Lk. Samm. St. Park area, subjects missing, 1) Naslund, Denise M 10-10-55, 5'4" 110, Brn & Brn 2) Ott, Janice 02-14-51, 5'0" 100 Blond & Grn, 75 Front St. Issaquah.

0920Hrs: ESAR was notified of the search and to contact base of operations at Lk. Samm St park.

1000Hrs: Enroute to the park, recieved C.D. number 74-255. Arrived at base at 1030 Hrs.

1100Hrs: Asked radio to have dogs at the park, and to check for availability of SPD AIR Two. AT 1110 Hrs radio advised that the Bloodhounds and Air Two were enroute.

1110Hrs: ESAR communications began setting up and ESAR teams arriving.

1205Hrs: Bloodhounds arrived and dispersed into the wooded areas of the park. SPD unit Maj. Bean and Air Two arrived and briefed. Air Two began their air search of the entire park and surrounding areas to include all roads from Iss. to the park and along I-90 East and West bound.

1340Hrs: Dogs completed their search of the assigned areas with neg. results.

1445Hrs: SPD completed their air search with neg results.

1645Hrs: Advised by the life guards that the swimming area was checked by their diver with neg results.

1840Hrs: Sgt. Weaver and Off. Engstrom checked the park area by plane with neg results.

2200Hrs: Secured from the base at Lk. Samm due to darkness, all search teams to continue search at 0600 Hrs on Wed. 07-17-74.

07-17 0600Hrs: Arrived at Lk Samm St Park, Esar teams arrived and dispersed into the field

0800Hrs: KCP Divers began their search of the water front from the boat launch to the beach

0835Hrs: Recieved info of an injured ESAR member, Evan C. SMITH 14429 SE 55 Bellevue subject was taken to Group Helth Hosp. and recieved 14 stitched on the right hand Injury occured when the subject sliped on a mud back and fell across his bolo knife. Subj. taken to Hosp by M-2 and returned to the search. CONT.

Ken W. Wardstrom 06126 M-3 INVESTIGATING OFFICER

Sgt. Christy J. Hagan APPROVING OFFICER

PAGE 1 OF 2

KING COUNTY DEPARTMENT OF PUBLIC SAFETY
ADDITIONAL INFORMATION SHEET/OFFICER'S REPORT

Case No.

7 4

0 9 5 8 5 2

TO	VIA	DATE 07-22-74	TIME
FROM		SUBJECT: CONTINUATION OF <input checked="" type="checkbox"/> OFFICER'S REPORT REGARDING <input type="checkbox"/> MISSING PERSON	

ITEM:

L130Hrs: Divers advised that they were clear of the areas with neg results.

2200Hrs: Secure from base due to darkness and completion of the entire State Park by the ESAR teams. Search teams advised of alert status however will not continue on Thur, 07-18-74.

07-18 1330Hrs: Upon request of H&R unit search to continue of the areas surrounding the park. ESAR notified for 0730 hrs on Fri 07-19. Four x Four rescue Council notified 181 Sup Bn notified for a gas tanker

07-19 0700Hrs: Arrived Ek. Samm St Park, location of base changed for better radio communications to Pine Lake County Park. Using a ESAR team of five and a 4x4 rig the Pine Lk & Beaver Lk plateau was sectioned off and teams assigned to the sections. Seven 4x4 units and 47 ESAR members were utilized. Areas completed, Neg results.

2100Hrs: Cleared from base to continue at 0700 Hrs base setu for Issaquah P.D.

07-20 0700Hrs: Teams arrived at Iss. P.D. Six German shepards sent to the sand and gravel pit areas. Eleven 4x4 rigs and 53 ESAR members were sent out in teams to cover the cougar mnt. area, Squak mtn and Tiger mtn, all roads accessable by vehicle.

1500Hrs: Dogs advised they were clear of the area with neg results.

1830Hrs: Secured from area, areas were covered. Search teams to continue at 0700 hrs on 07-21. Base of operations, Issaquah P.D.

07-21 0700Hrs: Arrived Iss P.D. Eleven 4x4 rigs, 9 ESAR members and 6 KCP divers. Teams to cover all driveways were the houses and veh. cant be seen from the main roads. Teams re-covered all areas previously covered on 07-19 & 07-20. Divers to cover the Iss. creek from I-90 to the mouth, Lk. Sammamish.

1300Hrs: Divers completed with search with neg results.

1800Hrs: Teams completed with areas, search temporarily completed.

Recap: Entire state park covered by ground teams consisting of ESAR members, Pine lk. and Beaver Lk areas covered by ESAR teams and 4x4 rigs covering all roads acessable by vehicle. Cougar, Squak, and Tiger Mtn areas covered by ESAR teams and 4x4 rigs covering all roads. Search teams used: KCP, KCP Divers, SPD Helio, Explorer Search & Rescue, NW Bloodhound AssOc German Shepard Search Dogs, 4x4 Rescue Council, and Iron Horsemen. Total manpower, 359, manhours, 3154.5, vehicles used, 149, miles driven, 7587.

Original map of the search is held with the ESAR records, zerox copies of the areas search are attached.

INVESTIGATING OFFICER
Ken W. Wardstrom

SERIAL
06126

UNIT
M-3

APPROVED BY:

Sgt. David M. Urban

PAGE 2
OF 2

KING COUNTY DEPARTMENT OF PUBLIC SAFETY
FOLLOW-UP REPORT

Case No.

7 4

0 9 5 8 5 2

PRESENT DATE

07-23-74

TYPE OF CASE

Missing Person

DATE OF OCCURRENCE

07-15-74

Original Invest. Officer

Radio

ORIGINALLY REPORTED AS

Same

LOCATION OF OCCURRENCE

Lk Samm St Park

VALUE RECOVERED

None

VICTIM

ADDRESS

Naslund, Denise M.

4522 SW Grahan St Sea

PHONE

C
A
S
E

STATUS:

OPEN

☒

INACTIVE

☐

CLOSED

☐

DISPOSITION:

CLEARED BY ARREST

☐

EXCEPTIONAL CLEARANCE

☐

UNFOUNDED

☐

PROPERTY:

RECOVERED ☒

ADDITIONAL STOLEN ☐

FURTHER DESCRIPTION ☐

INDICATE ID MARKS—COLORS—SIZES—
SERIAL NUMBERS—DISPOSITION—VALUE
ETC. AS FIRST ENTRY BELOW

E
N
T
R
Y

COMMENCE EACH ENTRY WITH A NUMBER AND THE DATE AND TIME

SUSPECTS:

INCLUDE NAMES, B/A NUMBERS, DESCRIPTIONS, DISPOSITION, CAN VICTIM IDENTIFY, ETC.

GENERAL:

SUMMARIZE STEPS OF INVESTIGATION: INCLUDE PERSONS INTERVIEWED, ADD'L WITNESSES, RESULTS OF

CASE M.O.:

INTERROGATIONS, EVIDENCE, BUSINESS ADDRESSES AND PHONES, ETC.

INDICATE ADD'L M.O. FACTORS NOT INCLUDED ON OFFENSE REPORT.

Found property during search for two missing girls at Lk Samm State park. Items have been identified as not belonging to the missing girls.

Ken Wardstrom

#06126

M-3

INVESTIGATING OFFICER

SERIAL

UNIT

APPROVING OFFICER

PAGE

1

OF

1

ORIGINAL

INCIDENT
NUMBER

7	4
---	---

—

0	9	5	8	5	2
---	---	---	---	---	---

List all items in the Following Order		1. FINGERPRINT LIFT CARDS, 2. ITEMS REQUIRING PROCESSING FOR PRINTS, 3. ITEMS REQUIRING OTHER LAB PROCESSING, 4. MISCELLANEOUS OTHER EVIDENCE
ITEM #	QUANT	DESCRIPTION: DESCRIBE IN DETAIL, LIST ALL MODEL OR SERIAL NUMBERS, MONEY IN EXACT DENOMINATIONS, BRAND NAMES, SIZES, ETC. EACH ITEM MUST BE NUMBERED AND TAGGED.

1	1	Paper sack containing items of clothing, three shirts, two white, one blue, one sweater, blue, one brown belt, and one pair of white dress shoes.
---	---	---

ORIGINAL
SUBMIT TO RECORDS
WITH CASE REPORT

ORIGINAL
SUBMIT TO RECORDS
WITH CASE REPORT

USE THE FOLLOWING ONLY FOR FIELD RELEASES OF ALL ITEMS ON ONE PAGE TO ONLY ONE VICTIM										TO BE RETAINED AT PRECINCT #		STORAGE LOCATION	
I HAVE RECEIVED THE ABOVE ITEMS: (SIGNATURE)				DATE		TIME							
ADDRESS			CITY		STATE		ZIP		REASON				
NCIC/WACIC FIELD CHECKS: BY:			TIME		RESULT		FINAL CHECK BY EVIDENCE ROOM: BY:			DATE TIME		RESULT	
TRANSPORTED TO HQ BY:			PERS #		DATE		RECEIVED BY OTHER THAN EVIDENCE ROOM			PERS #		DATE TIME	
ALL ITEMS BELOW THIS LINE FOR USE BY EVIDENCE ROOM ONLY													
RECEIVED BY:			PERS #		CONTENTS VERIFIED BY		NUMBER OF PKGS.		RECEIVING STORAGE LOCATIONS				
DATE AND TIME STAMP:			FINAL DISPOSITION AND DATE				PERMANENT STORAGE LOCATIONS Room or Quadrant			Shelf or bin		PAGE OF PAGES	

ORIGINAL

KING COUNTY DEPARTMENT OF PUBLIC SAFETY
FOLLOW-UP REPORT

Case No.

74

095857

PRESENT DATE

08-01-74

TYPE OF CASE

SUSPICIOUS CIRCUMSTANCE

DATE OF OCCURRENCE

07-14-74

Original Invest. Officer

ORIGINALLY REPORTED AS

MISSING PERSON

LOCATION OF OCCURRENCE

W. JENNIFER STATE PARK

VALUE RECOVERED

VICTIM

NASLAND, DENISE M.

ADDRESS

8652 13 S. O. SEATTLE

PHONE

WE8-0151

CASE

STATUS:

OPEN ☒

INACTIVE ☐

CLOSED ☐

DISPOSITION:

CLEARED BY ARREST ☐

EXCEPTIONAL CLEARANCE ☐

UNFOUNDED ☐

PROPERTY:

RECOVERED ☐

ADDITIONAL STOLEN ☐

FURTHER DESCRIPTION ☐

INDICATE ID MARKS—COLORS—SIZES—
SERIAL NUMBERS—DISPOSITION—VALUE
ETC. AS FIRST ENTRY BELOW

ENTRY

COMMENCE EACH ENTRY WITH A NUMBER AND THE DATE AND TIME

SUSPECTS:

INCLUDE NAMES, B/A NUMBERS, DESCRIPTIONS, DISPOSITION, CAN VICTIM IDENTIFY, ETC.

GENERAL:

SUMMARIZE STEPS OF INVESTIGATION: INCLUDE PERSONS INTERVIEWED, ADD'L WITNESSES, RESULTS OF INTERROGATIONS, EVIDENCE, BUSINESS ADDRESSES AND PHONES, ETC.

CASE M.O.:

INDICATE ADD'L M.O. FACTORS NOT INCLUDED ON OFFENSE REPORT.

1) ABOUT 0910 DATE OFFICER LUNDEEN ~~BY~~ CONTACTED ME BY TELEPHONE. HE REQUESTED I CHECK THE WOODED AREA AROUND THE S. 162 ON RAMP ON TO S. R. 509 FOR ~~AT~~ ANY UN TURNED DIRT WHICH APPEARED FRESH OR ANYTHING ELSE UNUSUAL.

2) 0920 - 0950 I WALK AROUND AND THROUGH THE BRUSH AND WOODED AREAS WHICH LIES BOTH NORTH AND SOUTH OF S. 162 ON THE WEST SIDE OF S. R. 509. I NOTICED NOTHING WHICH APPEARED SUSPICIOUS TO ME.

MEERS WILLIAM L.
INVESTIGATING OFFICER

03209
SERIAL

1011
UNIT

Sgt. David W. Lowens
APPROVING OFFICER

PAGE

1

OF

2

KING COUNTY DEPARTMENT OF PUBLIC SAFETY
FOLLOW-UP REPORT

Case No.

74

0 9 5 8 5 2

CD# 74-255

PRESENT DATE
08-22-74

TYPE OF CASE MISSING PERSONS (SEARCH & RESCUE)		DATE OF OCCURRENCE 07-15-74	Original Invest. Officer Radio room
ORIGINALLY REPORTED AS SAME		LOCATION OF OCCURRENCE Samanish State Park, Issaquah, Wa.	VALUE RECOVERED
VICTIM	1. MAXX NASLUND, DENISE M. ADDRESS 10-10-55, 4522 SW Graham, Seattle, Wa. PHONE		
	2. OTT, Janice 02-14-74 75 Front St. Issaquah, Wa.		
C A S E	STATUS: OPEN <input checked="" type="checkbox"/> INACTIVE <input type="checkbox"/> CLOSED <input type="checkbox"/>		
	DISPOSITION: CLEARED BY ARREST <input type="checkbox"/> EXCEPTIONAL CLEARANCE <input type="checkbox"/> UNFOUNDED <input type="checkbox"/>		

PROPERTY: RECOVERED ☐ ADDITIONAL STOLEN ☐ FURTHER DESCRIPTION ☐ { INDICATE ID MARKS—COLORS—SIZES—
SERIAL NUMBERS—DISPOSITION—VALUE
ETC. AS FIRST ENTRY BELOW

ENTRY
SUSPECTS: INCLUDE NAMES, B/A NUMBERS, DESCRIPTIONS, DISPOSITION, CAN VICTIM IDENTIFY, ETC.
GENERAL: SUMMARIZE STEPS OF INVESTIGATION: INCLUDE PERSONS INTERVIEWED, ADD'L WITNESSES, RESULTS OF INTERROGATIONS, EVIDENCE, BUSINESS ADDRESSES AND PHONES, ETC.
CASE M.O.: INDICATE ADD'L M.O. FACTORS NOT INCLUDED ON OFFENSE REPORT.

Refer to case # 74-96644 for Janice OTT.
06-19 Received request from Sgt Randall, H&R, to search an area in Bellevue for the bodies of the victims. Sgt Randall had received information from a ~~MAXX~~ psychic of the possibility the bodies being at the location. See attached map.

0930 hrs. 08-22-74. I met with six Explorer Search & Rescue people at Eastgate Shopping Center.
1000 hrs. Began search.
1100 hrs. Securred search. Negative results.

No CD INSURANCE CLAIMS FILED.

AREA SEARCHED.

- Tall trees

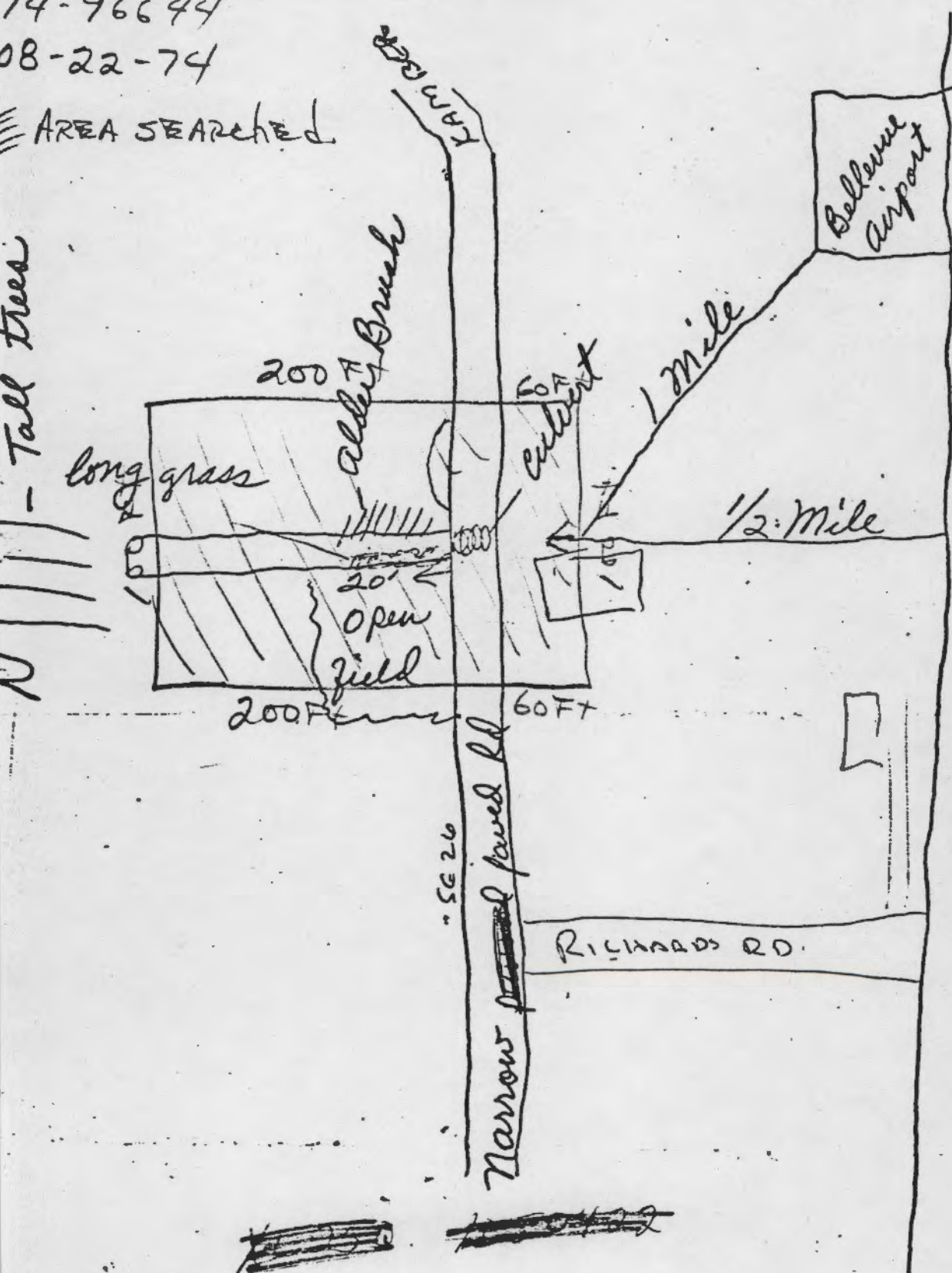

I-90

74-95852
ORIGINAL

KING COUNTY DEPARTMENT OF PUBLIC SAFETY
FOLLOW-UP REPORT

Case No.

MASTER CASE:-----

74

096644

74

095852

PRESENT DATE

09-16-74

TYPE OF CASE DEATH INVESTIGATION	DATE OF OCCURRENCE 07-14-74	Original Invest. Officer DET. ROGER E. DUNN
ORIGINALLY REPORTED AS MISSING PERSON	LOCATION OF OCCURRENCE LAKE SAMMAMISH STATE PARK F-1	VALUE RECOVERED N/A
VICTIM NASLUND, DENISE M.	ADDRESS 75 FRONT ST. S., ISSAQUAH, WN.	PHONE 392-1321

C
A
S
E

STATUS: OPEN ☐ INACTIVE ☐ CLOSED ☒ XXX

DISPOSITION: CLEARED BY ARREST ☐ EXCEPTIONAL CLEARANCE ☐ UNFOUNDED ☐ XXXXX

PROPERTY: RECOVERED ☐ ADDITIONAL STOLEN ☐ FURTHER DESCRIPTION ☐ { INDICATE ID MARKS—COLORS—SIZES—SERIAL NUMBERS—DISPOSITION—VALUE ETC. AS FIRST ENTRY BELOW

E
N
T
R
Y

COMMENCE EACH ENTRY WITH A NUMBER AND THE DATE AND TIME

SUSPECTS: INCLUDE NAMES, B/A NUMBERS, DESCRIPTIONS, DISPOSITION, CAN VICTIM IDENTIFY, ETC.
GENERAL: SUMMARIZE STEPS OF INVESTIGATION: INCLUDE PERSONS INTERVIEWED, ADD'L WITNESSES, RESULTS OF INTERROGATIONS, EVIDENCE, BUSINESS ADDRESSES AND PHONES, ETC.
CASE M.O.: INDICATE ADD'L M.O. FACTORS NOT INCLUDED ON OFFENSE REPORT.

- ON 09-07-74 HUMAN BONES WERE FOUND AT A LOCATION 3 MILES EAST OF THE PARK. EXAMINATION BY DR. DARIS SWINDLER OF THE UNIVERSITY OF WASHINGTON AND DR. PATRICK BESANT-MATTHEWS PROVED THAT THESE BONES WERE THE REMAINS OF JANICE OTT AND DENISE NASLUND, 74-95852.
THOSE TWO CASES OF MISSING PERSONS WILL BE SETTLED TO THE MASTER CASE OF DEATH INVESTIGATION-HOMICIDE 74-123376. ALL FOLLOWUP AND NOTES PERTAINING TO THE TWO MISSING PERSON CASES WILL NOW BE INCLUDED UNDER THAT MASTER CASE AND THE INVESTIGATION IS CONTINUING.
- 09-16-74 0800 hrs. - CANCELLED THE TWO MISSING PERSON CASES IN SEA-KING WITH OPERATOR #57.
- BOTH CASES ARE CLOSED

CLOSED

ORIGINAL

DET. ROGER E. DUNN
INVESTIGATING OFFICER01116
SERIAL221
UNIT

APPROVING OFFICER

PAGE 1

OF 1

7	4
---	---

9	5	8	5	2
---	---	---	---	---

PRESENT DATE
8-5-74

TYPE OF CASE MISSING PERSON	DATE OF OCCURRENCE 7-14-74	Original Invest. Officer
ORIGINALLY REPORTED AS Same	LOCATION OF OCCURRENCE Lake Sammamish State Park	VALUE RECOVERED N/A
VICTIM NASLUND, Denise Marie	ADDRESS	PHONE

C
A
S
E

STATUS:	OPEN <input checked="" type="checkbox"/>	INACTIVE <input type="checkbox"/>	CLOSED <input type="checkbox"/>
DISPOSITION:	CLEARED BY ARREST <input type="checkbox"/>	EXCEPTIONAL CLEARANCE <input type="checkbox"/>	UNFOUNDED <input type="checkbox"/>

PROPERTY: RECOVERED ☐ ADDITIONAL STOLEN ☐ FURTHER DESCRIPTION ☐ { INDICATE ID MARKS—COLORS—SIZES—SERIAL NUMBERS—DISPOSITION—VALUE ETC.

E
N
T
R
Y

- SUSPECTS: INCLUDE NAMES, B/A NUMBERS, DESCRIPTIONS, DISPOSITION, CAN VICTIM IDENTIFY, ETC.
- PERSONS INTERVIEWED: NAMES, ADDRESSES AND TELEPHONE NUMBERS.
- PROPERTY: INDICATE ID MARKS—COLORS—SIZES—SERIAL NUMBERS—DISPOSITION—VALUE, ETC.
- ADDITIONAL ENTRIES: SUMMARIZE STEPS OF INVESTIGATION—COMMENCE EACH ENTRY WITH A NO., DATE AND TIME.

- 7-16-74 1000 hrs.: Notified by SGT. RANDALL of the missing girls from Lake Sammamish State Park. Had telephone contact with DENISE NASLUND's mother, MRS. ROSE. She related that DENISE worked at Dean's Top Secretarial Pool, 623-8677. She would be sent out on secretarial jobs out of Dean's Top Secretarial Pool. She also was attending I.T.T. Peterson's School, which was a computer programmer's school. She related that KEN LITTLE was a boyfriend of DENISE's and at the time of the disappearance, was bickering with DENISE over a dog. They were at Lake Sammamish State Park with NANCY and BOB SARGENT, and another couple was with them. Her best friend is ROBIN WOODS, CH 8-1652. She also related that the car they took to Lake Sammamish State Park was owned by herself. MRS. ROSE. MRS. ROSE related that the purse belonging to DENISE, and the shoes were still in the car. Det. Hergesheimer to contact MR. SARGENT for a written statement.
- 1008 hrs.: Attempted phone contact with ROBIN WOODS - line busy.
- 1011 hrs.: Phone contact with Dean's Top Secretarial Pool. Talked with DOUGLAS DEAN, Rm. #633, Securities Building, Seattle, Wa. 98101, 3rd and Stewart. Time slip mailed in for last week received Tuesday, 7/16-74 in the morning mail at Dean's Top Secretarial Pool, stamped 7/15/74. Sixty employees had mailed time slips in at that time. DENISE NASLUND filled out an application blank for work in November of 1973. At that time she gave an address of 10624 21st SW, CH 6-9767. She later changed her address to 4522 SW Graham St., WE 8-0150. She gave a reference of BEV RICHARDS, 8646 13th SW. Also a NADINE GETTEYS, 20112 15th SW, TR 8-3897. She works at the Jet Inn, 246-9110. DENISE worked for Graybar Electric in October of 1973. She was to report to work Monday, 7-15-74, but never showed.
- 1050 hrs.: Talked to PAUL GETTEYS who has not seen DENISE for a year. Mother found out DENISE was missing from DENISE's mother.
- 1055 hrs.: No answer at ROBIN WOODS' phone number.

1h

PAGE

1

OF

13

INVESTIGATING OFFICER
Det. Robert Keppel

SERIAL

UNIT
H & R

APPROVED BY:

ORIGINAL

KING COUNTY DEPARTMENT OF PUBLIC SAFETY
ADDITIONAL INFORMATION SHEET/OFFICER'S REPORT

Case No.

7 4

9 5 8 5 2

TO	VIA	DATE 8-5-74	TIME
FROM	SUBJECT: CONTINUATION OF <input checked="" type="checkbox"/> OFFICER'S REPORT REGARDING <input type="checkbox"/> FOLLOW-UP REPORT		

ITEM:

- 6 7-16-74 1555 hrs.: No answer at ROBIN WOODS' phone number.
- 7 1730 hrs.: Interviewed ANNA DECKER, WE 2-3119. She last saw DENISE on Saturday. DENISE had admired a St. Bernard. She felt that DENISE and KEN LITTLE lived across the street from her for about six months. She thought they had a tan Plymouth or Ford.
- 8 1820 hrs.: Arrived at Lake Sammamish Park. Interviewed KEN LITTLE at that time. R/O obtained signed statement from KEN LITTLE. Refer to statement for details. LITTLE related that BOB and NANCY's phone number is 485-1567, and they live in Bothell.
- 9 7-17-74 0825 hrs.: Received phone call from GLEN NOLL, 243-9264, address is 1046 S. 174th. He related that he owned the house NASLUND had been living in.
- 10 0835 hrs.: Had phone contact with JOHN BATES, 433-3326, H/P 641-0364, address 2202 177th Pl. NE, Redmond. On Sunday, 7-14-74 between 1215 hrs. and 1330 hrs., he related he saw JANICE OTT near the Rainier game area at Lake Sammamish State Park, talking with people.
- 11 0834 hrs.: Contacted Rainier Brewery. Information gained that TIM McKEE, 622-2600, was the one who managed the games at Lake Sammamish State Park.
- 12 0850 hrs.: Contacted ROBIN WOODS, 10624 21st SW. She last saw DENISE NASLUND July 3rd. She related that DENISE would not like bikers. She has another boyfriend by the name of BOB WOLFORD at EA 9-9393. He lives in the "U" District near Lake Union. She related that DENISE had met him at Graybar Electric when she worked there. She had not seen WOLFORD for two months.
- 13 0900 hrs.: TIM McKEE called from Rainier Brewery. He related that video tapes were taken by HARDY QUADE, 682-8230, representing Channels 5 and 11. Also taking video tapes at the park on Sunday was JOE CAIRO, 725-1400.
- 14 0905 hrs.: Talked with KATHY VERES. She will get together with SYLVIA VALINT and come down to the Courthouse together.
- 15 0920 hrs.: Had telephone contact with HARDY QUADE. Gave film to TV stations. He related that Channel 11, KSTW, had film and the man to contact was BOB CLAYLAND, 572-5789. Also, Channel 5 at MU 2-5555, JOHN LIPPMAN was the man to contact.
- 16 0935 hrs.: Contacted Channel 5, JOHN KVASNOSKY. He was in the process of looking at the film for the girls.

1h

INVESTIGATING OFFICER Det. Robert Keppel	SERIAL	UNIT H & R	APPROVED BY:
---	--------	---------------	--------------

PAGE

2

OF

13

ADDITIONAL INFORMATION SHEET/OFFICER'S REPORT

7 4

9 5 8 5 2

TO	VIA	DATE 8-5-74	TIME
FROM		SUBJECT: CONTINUATION OF <input checked="" type="checkbox"/> OFFICER'S REPORT REGARDING <input type="checkbox"/> FOLLOW-UP REPORT	

ITEM:

- 17 7-16-74 0945 hrs.: Contacted CHARLIE BURD, KSTV - TV, who related that the King County Police could have the section of film he had. Made arrangements to pick up a film at S. 11th & Grant in Tacoma. SGT. RANDALL handled that contact.
- 18 1010 hrs.: Had phone contact with THERESA SHARPE, 486-8253, 2723 Stafford Way SE, Bothell. She related she had been sitting next to JANICE OTT on Sunday, July 14, 1974. She stated that at 1230 hrs. a subject 6'0" to 6'1", hair on the neck, brown, medium length, needed her to help him load a sailboat. He had no cast, but had his arm in a sling. He was wearing a white T-shirt, white shorts (boxer-type) dark tan. She related that JANICE said: "Under one stipulation, that I meet your folks." He had told her that the sailboat was at his parent's house in Bellevue. The distance she was sitting from JANICE OTT was about 2 yards. JANICE had a yellow 10-speed with a knapsack. JANICE was wearing a white blouse, short cut-offs, black bikini and JANICE's blouse was described as tying in front with the stomach and back skin showing. DET. GRUNDEN was assigned to take a statement from THERESA SHARPE. See 74-96644 for statement
- 19 1030 hrs.: SYLVIA VALINT contacted at the Courthouse. R/O obtained a signed statement from SYLVIA VALINT regarding witnessing of a man called TED picking up JANICE OTT at Lake Sammamish State Park on July 14, 1974. See 74-96644 for statement
- 20 1150 hrs.: Contacted BETTY BARRY, SPD payroll clerk, 583-2209. She related that she recognized the girl in the restroom as DENISE NASLUND on Sunday, July 14, 1974.
- 21 1200 hrs.: BETTY BARRY contacted at King County Courthouse. Obtained witness statement from BETTY BARRY.
- 22 7-17-74 1335 hrs.: Contacted DET. KESGARD, Bellevue PD and requested he check Overlake Hospital for left arm casts of suspect's description.
- 23 1135 hrs.: Contacted by KEN LITTLE by phone. He related that he had seen one of his friends at Lake Sammamish State Park on the day DENISE was missing. His name is [REDACTED], and he lives in White Center. He last saw [REDACTED] after DENISE was gone around 6:00 or 7:00 o'clock. He would describe him as 6'1", dark hair, mustache. LITTLE related that [REDACTED] thought DENISE was a tramp. He knows DENISE. (See paragraph 38) Photo shown to witnesses, neg. I.D.
- 24 1415 hrs.: Contacted JOHN KLEIN, KOMO-TV MU 2-3111 and said he would locate the film on the confrontation between the Jackals and W.S.P. The cameraman on the occasion was DOYLE DUDGEL.

1h

INVESTIGATING OFFICER Det. Robert Keppel	SERIAL	UNIT H&R	APPROVED BY:
---	--------	-------------	--------------

 PAGE 3
OF 13

ADDITIONAL INFORMATION SHEET/OFFICER'S REPORT

Case No.

7 4

9 5 8 5 2

TO	VIA	DATE 8-5-74	TIME
FROM		SUBJECT: CONTINUATION OF <input checked="" type="checkbox"/> OFFICER'S REPORT REGARDING <input type="checkbox"/> FOLLOW-UP REPORT	

ITEM:

- 25 7-17-74 1605 hrs.: Had phone contact with MRS. THOMAS, mother of [REDACTED]. She will try to contact her son and have him call on 7-18-74 at 0800 hrs. R/O ran records check on [REDACTED] and he has a \$5,000 outstanding warrant for auto theft. (See paragraph 38.)
- 26 1730 hrs.: Contacted Issaquah P.D. R/O received a statement from DAVID McKIBBEN from CHIEF PROSISE, Issaquah P.D. R/O also interviewed JACQUELINE PLISCHKE. R/O obtained a signed witness statement from JACKIE PLISCHKE. Refer to that statement for details. See 74-96644 for statements.
- 27 7-18-74 0730 hrs.: Contacted Issaquah P.D. Received statement of JANICE GRAHAM from CHIEF PROSISE. Also R/O was notified by OFFICER RALPH that a lady who was at Lake Sammamish State Park wanted contact regarding her son's finding clothes at the park. See 74-96644 for statement.
- 28 0815 hrs.: Contacted at Lake Sammamish State Park. Interviewed JUDI MARTINEZ, 15924 Sunset Highway #H-11, phone 747-9796. Her son was part of the pick-up crew and had picked up blue jeans with long legs, a T-shirt, black shoes with blue and red stripes, pink plaid bikini underwear, two white socks, and he had picked them up about 200 yards from the beach. R/O observed where the son picked up the clothing. The clothing is unrelated to this case.
- 29 0930 hrs.: Contacted at KING-TV with DETECTIVES DUNN and HERGESHEIMER. Viewed films of Lake Sammamish State Park, July 14, 1974, and the Rainier celebration.
- 30 1150 hrs.: Contacted by JOHN KLEIN, KOMO-TV - he related that JOHN SANDIFER was bringing down film of the motorcycle confrontation at Lake Sammamish. Received film from JOHN SANDIFER. The film was given to SGT. RANDALL.
- 31 1215 hrs.: BOB SARGENT and NANCY BATTEMA contacted at the courthouse. Witness statement taken from BATTEMA. SARGENT's statement taken by DET. HERGESHEIMER. See these statements for details. R/O obtained witness statement from RENEE SCHOENHAIS at 1435 hrs.
- 32 1832 hrs.: Had phone contact with PATRICIA TURNER, 822-4043, GL 5-3856, address of 13416 118th NE, Kirkland. She related that she and her daughter were at Lake Sammamish State Park on Sunday. She observed a man at about 3:30 or 4:00 o'clock who matched the description of the suspect. Information given to DET. GRUNDEN who obtained statement from PAT TURNER. She agreed with description depicted on composite made on 7-25-74.
- 33 7-19-74 0820 hrs.: Received phone call from NORA FOWLER, 883-0152, B/P 883-1066, 9451 Avondale Rd., Redmond. She related that on the day DENISE NASLUND was missing she was with DENISE. She and her friends left about 4:15 from where KEN

INVESTIGATING OFFICER Det. Robert Keppel	SERIAL	UNIT H&R	APPROVED BY:	KEN PAGE 4
				OF 13

ORIGINAL

ADDITIONAL INFORMATION SHEET/OFFICER'S REPORT

Case No.

7 4

9 5 8 5 2

TO	VIA	DATE 8-5-74	TIME
FROM		SUBJECT: CONTINUATION OF <input checked="" type="checkbox"/> OFFICER'S REPORT REGARDING <input type="checkbox"/> FOLLOW-UP REPORT	

ITEM:

and DENISE were sitting and did not see them again. She related that KEN and DENISE were not on the friendliest terms that day but she did not think it was enough to make DENISE go away.

34 7-19-74 1040 hrs.: Examined clothing in cases 74-95276 and 74-97279. Clothing examined is not related to this case.

35 1245 hrs.: Had phone contact with LANE HARTVIGSON, CH 4-9642. He related that he left Lake Sammamish State Park on Sunday at 3:30 p.m. At about 4:15 p.m. he saw a brown metallic VW, no front bumper, wide tires, mag wheels, parked at Pine Lake County Park. R/O had DET. GRUNDEN meet MR. HARTVIGSON at Issaquah P.D. at 1350 hrs.

36 1450 hrs.: Had phone contact with KEITH PANKAU, 746-2022. He recommended that the police check HANS JENSEN Youth Park Trails from Lake Sammamish State Park. R/O related to KEITH that these trails had already been checked.

37 Received DENISE NASLUND's address book from KEN LITTLE. Prepared copies of pages and obtained directory information as shown on marked pages. Book to be placed into evidence.

38 1720 hrs.: Contacted [REDACTED] 938-[REDACTED] He stated he was at the park on Sunday, but he did not see NASLUND or LITTLE while at the park. He arrived at 1600 hrs. (See paragraphs 23 and 25)

39 7-21-75 0900 hrs.: Had phone contact with BOB WOLFORD, EA 9-9393. He last saw DENISE NASLUND about two months ago. She worked at Graybar Electric. She could fit into any crowd. He related she was gullible for lies given by men. Contacted from information in victim's phone book.

40 0904 hrs.: Had phone contact with GLEN MARTIN, 243-5303. He last saw DENISE NASLUND about 7 montsh. He will get ahold of BILL LAMB to have him call R/O. He was with BILL when he met DENISE. He does not know very much about DENISE NASLUND. Contacted from information in victim's phone book.

41 1045 hrs.: Contacted by JACKIE PLISCHKE. Made arrangements to review PLISCHKE's statement with contact at Wildwood Apts. between 1200 and 1230 Hrs. in Issaquah. See 74-96644 for statement.

42 1205 hrs.: Arrived Wildwood Apts. - PLISCHKE not at home.

43 1230 hrs.: Contacted at Wildwood Apts. waiting for PLISCHKE.

44 1243 hrs.: Contacted JACKIE PLISCHKE, mileage - 92,543. Retraced PLISCHKE's bike ride on July 14, 1974. She started

INVESTIGATING OFFICER Det. Robert Keppel	SERIAL	UNIT H & R	APPROVED BY:
---	--------	---------------	--------------

PAGE 5

OF 13

ORIGINAL

ADDITIONAL INFORMATION SHEET/OFFICER'S REPORT

7 4

9 5 8 5 2

TO	VIA	DATE	TIME
FROM		SUBJECT: CONTINUATION OF <input checked="" type="checkbox"/> OFFICER'S REPORT REGARDING <input type="checkbox"/> FOLLOW-UP REPORT	

ITEM:

- at 3:30 p.m. at the MOREL residence at SE 29th & E. Lake Sammamish Road. She rode southbound on E. Lake Sammamish Road to Frontage Road, then continued across to the park riding through the Park Ranger's Station, and down to the main road which goes into the park. PLISCHKE pointed out to R/O where she was standing on the spit when she first observed suspect TED and also where she was confronted by suspect near the beach; PLISCHKE placed points on the map. Could not add anything farther to suspect's description. Interview ended at 1400 hrs., mileage 92,556.
- 45 7-22-74 1546 hrs.: Contacted by BILL LAMB, friend of DENISE NASLUND's. He last saw DENISE two months ago. He knew DENISE for four years. He didn't know her to use drugs to any great extent. She occasionally smoked pot. She was always with KEN LITTLE when he knew her. Contacted from info in victim's phone book.
- 46 1740 hrs.: Arrived at the VALINT residence, SYLVIA VALINT was not home.
- 47 1800 hrs.: Received information from SGT. NELSON in Radio Room that a SUE STEINER had been approached by a man named TED. She lives at 11803 SE 58th, 746-7744.
- 48 1900 hrs.: Arrived at 11803 SE 58th and interviewed witnesses STEINER, STONE, WYCKE, and HAYNES. See statements for information. See 74-96644 for statements.
- 49 7-23-74 0930 hrs.: Contacted SYLVIA VALINT by telephone. She is to make a composite at 7-24-74 at 0900 hrs.'
- 50 1155 hrs.: Additional information received from CHIEF PROSISE on bicycle - 1) Shift levers are round; 2) Center pole breaks; 3) Has chrome wheels; 4) There are dual control brakes on the handlebars. Information given to SGT. RANDALL.
- 51 1600 hrs.: Had telephone contact with JUDY VanHORN, 525-2975, 9240 Densmore North. She used to work with DENISE NASLUND. She and DENISE NASLUND were assaulted previously by a [REDACTED], 28 - 30 years old, 5'10", a black male. DENISE used to call up JUDY at various times asking her if she wanted a date. JUDY knew that DENISE worked for a dating service. DENISE used to confide in JUDY and told her that her mother was very mean to her. No statement taken
- 52 7-24-74 0930 hrs.: Additional information was gained from CHIEF PROSISE, Issaquah P.D. 1) JANICE OTT had a D & C at Group Health Hospital from an Oriental doctor; 2) JANICE OTT's dentist is GEORGE KENNAUGH; 3) Received medical releases on JANICE OTT, placed in original file. Information was given to SGT. RANDALL.

1h

INVESTIGATING OFFICER Det. Robert Keppel	SERIAL	UNIT H & R	APPROVED BY:	PAGE 6 OF 13
---	--------	---------------	--------------	-----------------

ADDITIONAL INFORMATION SHEET/OFFICER'S REPORT

Case No.

7 4

9 5 8 5 2

TO	VIA	DATE 8-5-74	TIME
FROM		SUBJECT: CONTINUATION OF <input checked="" type="checkbox"/> OFFICER'S REPORT REGARDING <input type="checkbox"/> FOLLOW-UP REPORT	

ITEM:

- 53 7-24-74 1010 hrs.: SYLVIA VALINT contacted at King County Courthouse. R/O displayed several photographs of possible suspects to VALINT, negative results. R/O went over VALINT's statement with SYLVIA for additional details.
- 54 7-25-74 1115 hrs.: Contacted by KATHY DOLIVO, 4801 Dunbar Dr., Gig Harbor, 458-3704. She related that she was a student at Central Washington State College and had seen a picture of the composite in her school newspaper. She called police because the newspaper said to call local police. The date she was confronted by suspect was 4-17-74 at 10:00 p.m. She could not see the car clearly but thought it was a dark colored, shiny VW. She stated that suspect had dropped some books and she helped him pick them up, and took the books to the car. She placed the books in the car for the suspect. The suspect wanted her to start the car but she refused. Suspect dropped the key to the car. She picked it up for him and left. Information was given to Central Washington State College police, CHERYL MARTIN. She decided she would have Pierce County take a statement from KATHY DOLIVO. CHERYL MARTIN's Seattle phone number is 525-6415, and she lives at 5244 35th NE.
- 55 7-26-74 1140 hrs.: Had telephone contact with ROBERT LIND, 746-6329, B/P 624-0393, address 2627 148th SE. He related he was at Lake Sammamish Park on July 14, 1974. He observed a man with green Levi pants, short sleeved shirt, red in color, left arm in a sling, large white cast, mid-twenties, 5'10", 160 lbs., medium build, rather light brown straight hair. He looked like he was lost, walking up and down the path at about 3:00 p.m. to 4:00 p.m. He was clean-shaven. No statement taken.
- 56 7-29-74 0955 hrs.: Called by JUDY STONE, B/P MA 3-8380, H/P 776-3664. She reported that a friend of hers named KATHY was approached by a similar suspect at Central Washington State College. R/O informed her that we have been in contact with KATHY and that this information has been received. See paragraph 54.
- 57 0945 hrs.: Received phone call from DR. JAMES BURTT, 2764 72nd SE, Mercer Island, H/P AD 2-9725, B/P MA 3-6477. He has several photographs taken at Lake Sammamish on July 14, 1974. He will notify R/O when they are developed.
- 58 7-30-74 1815 hrs.: Contacted SYLVIA VALINT. She went through numerous photographs for possible suspects. She related that the photo of DARRELL WAYNE LAMBERT is similar to suspect that she saw pick up JANICE OTT. The face of the suspect is thinner like the photo of ARTHUR G. ANDERSON. LAMBERT's hair is the only thing that's right. ANDERSON looks too young; no mustache. LAMBERT's nose is too big.

1h

INVESTIGATING OFFICER Det. Robert Keppel	SERIAL	UNIT H & R	APPROVED BY:	PAGE 7 OF 13
---	--------	---------------	--------------	-----------------------

ORIGINAL

KING COUNTY DEPARTMENT OF PUBLIC SAFETY
 ADDITIONAL INFORMATION SHEET/OFFICER'S REPORT

Case No.

7 4

9 58 5 2

TO	VIA	DATE 8-5-74	TIME
FROM		SUBJECT: CONTINUATION OF XX OFFICER'S REPORT REGARDING <input type="checkbox"/> FOLLOW-UP REPORT	

ITEM:

- 59 7-31-74 1630 hrs.: Received phone call from JOHN McKEE from MR. SPELLMAN's office. He called concerning clothing found at Black Diamond. He had received a phone call from a concerned citizen who felt the police did not do anything about the clothes being found. R/O related that the clothing had been photographed and confiscated, but appeared to have nothing to do with JANICE OTT or DENISE NASLUND's cases. Both JIM OTT and KEN LITTLE looked over the clothes and did not recognize any of them.
- 60 8-1-74 1430 hrs.: Contacted CHERYL SCHMEIZER, Central Washington State College. Requested complete file on SUSAN RANCOURT and KATHY PARKS.
- 8-2-74 0850 hrs.: Contacted AL ELLIOTT, Juvenile Court. DENISE NASLUND has no record with Juvenile Court.
- 61- 1010 hrs.: Received phone call from DIANE ARMSTRONG, 16515 126th Pl. SE, 226-0822; she related she had seen a similar suspect wearing print swim trunks, wearing a beige sling at Lake Sammamish State Park on July 14. She could not remember anything further. No statement taken.
- 62 8-5-74 1030 hrs.: Received cases on SUSAN RANCOURT and ROBERTA KATHLEEN PARKS from C.W.S.G.
- 63 8-6-74 1510 hrs.: Contacted Napa County S.O., SGT. LAND, 707-255-5500, R/O inquired as to any unidentified female bodies found in his county. He related that it was not his county that found the bodies but Sonoma County. He gave me the number of BUTCH CARLSTED.
- 64 1520 hrs.: Contacted Sonoma County S/O, California, 707-527-2185. Had phone conversation with BUTCH CARLSTED. He related that at this time they found 6 female bodies. He also related that all the bodies were nude, dumped in a rural area, normally in a ravine or near a ravine with water (running.) All the girls were from broken homes, all were known to hitchhike. The suspect is keeping all the clothes. None of the girls has been beaten up. Suspect gives the impression that he may be doing the girls a favor by killing them. The suspect normally leaves one piece of jewelry with the women. Police have never found any of the victims' clothing. All victims were found along Highway #101, California. He related he would send a resume of the six found bodies to R/O. All bodies have been identified. He also advised R/O to contact DICK VERBRUGGE, Santa Cruz County, 408-425-2225. VERBRUGGE was working on cases involving about 80 female bodies. The only lead on any of them is a possible suspect vehicle of a blue Plymouth Duster with a black racing stripe.
- 65 1015 hrs.: Contacted DICK VERBRUGGE, Santa Cruz County S.O. He related he would send me information on all the missing girls in the San Francisco area.

INVESTIGATING OFFICER Det. Robert Keppel	SERIAL	UNIT H & R	APPROVED BY:	PAGE 8 OF 13
---	--------	---------------	--------------	-----------------

KING COUNTY DEPARTMENT OF PUBLIC SAFETY
ADDITIONAL INFORMATION SHEET/OFFICER'S REPORT

Case No.

7 4

9 5 8 5 2

TO	VIA	DATE 8-5-74	TIME
FROM		SUBJECT: CONTINUATION OF <input checked="" type="checkbox"/> OFFICER'S REPORT REGARDING <input type="checkbox"/> FOLLOW-UP REPORT	

ITEM:

- 66 8-8-74 1315 / 1515 hrs.: JACKIE PLISCHKE contacted at the King County Courthouse. She viewed all photos and annuals to this date. Negative results. She had checked with her friend MORREL and she left his house at 1630 hrs. She arrived at the park at 1700 hrs. and was approached by the suspect at 1715 hrs. After that she saw him walk off towards the restroom.
- 67 8-12-74 1115 hrs.: Had contact with JIM OTT. JANICE did not have any credit cards. JIM had closed out the checking account. There have been no checks written on the account. All checks have been accounted for. JIM OTT is duplicating all keys carried by JANICE OTT. He's getting a complete description of the knapsack carried by JANICE.
- 68 Received keys from MR. OTT. Keys consisted of key ring with brown leather attached. One key was a house key, Kwikset brand, bronze in color. The second key was a VW key, silver (ignition.) The third key was a VW key, trunk, silver, with VW inscribed. The fourth key was a trunk key, silver. The fifth key was an Issaquah house key.
- 69 To define victim's apparel, JIM OTT is to check on the beach towel, the print was possibly a Charlie Brown design. JANICE OTT frequently used Tanya cocoabutter for suntan. JAN did not wear jewelry. Possibly was wearing blue and white deck shoes. DR. BLACKBURN is to check on the shoes.
- 70 8-13-74 1300 hrs.: Received information from Issaquah P.D. that ARMEN BROOKER was staying at the Pickering Horse Barn across from the Alpine Veterinary Hospital. BROOKER had smelled suspicious odors in the area of the barn. This information was given to DET. LUNDINE to check out. Determined unfounded.
- 71 2130 hrs.: Had phone contact with VERN ROUNDTREE, 852-5483, regarding the Northwest Hanglider's Association. He knows of two two-toned gold Ford supervans owned by Hanglider people. One owner is [redacted] of Wing's West, 525-7096. [redacted] is not in the area but has seen [redacted] and [redacted] driving the van. [redacted]'s address is 26 [redacted] NE 62nd, 522-5432. [redacted]'s phone number is 255-[redacted]. MRS. ROUNDTREE stated that she and her husband were at the Lake Sammamish boat launch on 7-14-74 and at 1500 hrs. She was waiting in the truck for her husband. A guy matching the composite came up to her and talked. They talked about kites for awhile, and the guy said he was coming from Denver and had sold motorcycles in Colorado. He was headed for Alaska to work for a month. She thought he was hitchhiking, but was not sure. He stated he would come back in a month. The guy came from the road, walked down the launch road, talked to MRS. ROUNDTREE for a few minutes, then walked to the launch area. Then he walked back along the road. On the way past he said to MRS. ROUNDTREE: "How do you like being an information booth?" He walked back to the E. Lake Sammamish Road, and she did not see him again.

1h

INVESTIGATING OFFICER Det. Robert Keppel	SERIAL	UNIT H & R	APPROVED BY:
---	--------	---------------	--------------

PAGE 9
OF 13

ADDITIONAL INFORMATION MEET/OFFICER'S REPORT

Case No.

7 4

9 5 8 5 2

TO	VIA	DATE 8-5-74	TIME
FROM		SUBJECT: CONTINUATION OF <input checked="" type="checkbox"/> OFFICER'S REPORT REGARDING <input type="checkbox"/> FOLLOW-UP REPORT	

ITEM:

MRS. ROUNDTREE described him as a W/M, 5'9", slender, med. tan, white T-shirt, faded jeans, 22-23 yrs. old, sandy hair past the ears in a shag cut, and he had angular features. MRS. ROUNDTREE related that she was of similar appearance to the missing girls. Refer to paragraph 75. No statement taken.

72 8-14-74 1045 hrs.: Had phone contact with CAROLYN MURPHY, CH 2-1394. She is an astrologer working on the missing girls' cases. She related that the next likely occurrence of a missing girl would be 4-5 days before the full moon, and 4-5 days after the full moon. She related that a subject under maximum stress would have to abduct a girl on October 10-11, more likely October 26-27, and the maximum stress would continue until November 30. Most similar assaults take place in the winter and spring, and then the summer months of June and July. The pattern shows from two to three months of activity, then the subject lets off. The personality type of this subject is: 1) exceptionally intelligent; 2) hatred or fear of women; 3) has had mother problems, probably that the mother was dominant and he felt that any punishment she would inflict on him was cruel; 4) suppressed homosexual type, unable to express male sex; 5) good looking, but only good-looking in a non-attentive way (in other words, he would not get attention by his good looks); 6) able to play down what people tell him; 7) he's trustworthy; 8) he's slightly independent; 9) he's under 30, possibly 26 - 27 yrs. old; 10) he's close to home in Seattle. MRS. MURPHY related that the Libby, Montana missing girl was more than likely a runaway, possibly elopement involved. She's on the southern Oregon border, but she's not happy with her situation at this time. MRS. MURPHY did an astrological chart on LYNDIA ANNE HEALY. She related that if her calculations are correct, LYNDIA ANNE HEALY is 2.5 miles from where she was abducted on a south, southeast axis. She's in an improved land area, in the open. MRS. MURPHY gave examples of the Arboretum, ball field, and the area would be lush, but not weedy. She felt that NASLUND and HEALY had the same injuries; severe head injuries, possibly throat cut. She felt that if her calculations were correct, the 2.5 miles was accurate, but if it were not correct, then you multiply 2.5 by 7.

73 MRS. MURPHY did an astrological chart on [REDACTED]. She felt that the subject who abducted [REDACTED] was maybe in his early 40s, male, black or brown hair, 6'0", rather tall, not heavy set. The suspect has a strong attraction to a girl looking like [REDACTED]. His initial motive may have been for money. He's not particularly good looking; he's got a big nose. He may have a sex deviant background. Has a record for check forgery. The suspect is from some distance away, and not from the local neighborhood. MRS. MURPHY felt that due to the press coverage of the [REDACTED] case that this has possibly scared the suspect into doing away with [REDACTED].

74 8-16-74 1615 hrs.: R/O was contacted at the King County Courthouse by JIM OTT and LOIS JONES. R/O received phone calls made from [REDACTED]

INVESTIGATING OFFICER Det. Robert Keppel	SERIAL	UNIT H & R	APPROVED BY:	PAGE 10 OF 13
---	--------	---------------	--------------	------------------------

ADDITIONAL INFORMATION SHEET/OFFICER'S REPORT

Case No.

74

9

5

8

5

2

TO	VIA	DATE 8-5-74	TIME
FROM		SUBJECT: CONTINUATION OF <input checked="" type="checkbox"/> OFFICER'S REPORT REGARDING <input type="checkbox"/> FOLLOW-UP REPORT	

ITEM:

JANICE OTT's apartment. R/O also received tape of MARCY BACON from LOIS JONES. Tape to be placed into evidence.

-75 8-19-74 0833 hrs.: Contacted by ART OLSEN. He was in Olympia on July 14 with his family in the van. He claimed that [REDACTED] had a gold Blazer that could be mistaken for a tan van. Refer to Paragraph 71.

-76 8-20-74 1015 hrs.: Contacted by JIM OTT. He related that DEE PETERSON knows when JAN OTT left the Northlake Tavern the week prior, and had an accident there. This was the same day that JAN OTT was confronted on Front Street and I-90 by two guys driving a VW, both were fairly good looking. They said: "Oh, we didn't know that any foxy chicks lived in Issaquah." She had related this information to BETTY STOVER. No statements taken.

-77 1030 hrs.: Called by [REDACTED], 3802 S. 321st, Auburn. He requested flyers be sent to him on the missing girls. R/O ordered DMV photo on [REDACTED] and also mailed him the flyers on the missing girls. Photo shown to witnesses - negative I.D.

-78 8-22-74 1201 Hrs.: Had phone contact with DIANE CRIPPE, 745-2176. She reported that she had observed in a comic magazine, a place in New York where you could buy phony arm casts for \$1.50. The address is Honor House Production Corp., Dept. 53, GK-31, 35 Wilbur Street, Lynbrook, New York 11563.

-79 8-26-74 1210 hrs.: R/O was contacted at the courthouse by DET. PAUL BARCLIFT, Thurston County Sheriff's Office. Received cases of DIVINE and BAKER from DET. BARCLIFT.

-80 8-27-74 1530 hrs.: Contacted by JIM OTT. His new phone number is 543-3665, where he works. He related that he saw a name plate of [REDACTED] in the U. of W. pharmacy. He related he would find out further information. Possible "TED" suspect eliminated as an Oriental.

-81 8-28-74 0930 hrs.: JIM OTT contacted at the Courthouse. He viewed a blouse which had been recovered from the Fall City area. He had never seen the blouse before.

-82 8-30-74 0825 hrs.: Received phone call from JIM OTT. OTT related that the church next to JANICE OTT's house has a caretaker, and the caretaker may have seen JANICE OTT on July 14th. This information was not pertinent as the victim had not returned home after disappearance.

-83 1345 hrs.: Had phone contact with LINDA DRAHN 1212 SW 170th, 243-1922. She related that on 7-13-74 between 5:30 and 6:30 p.m. she had talked to JANICE OTT on the phone. JANICE OTT was a

INVESTIGATING OFFICER Det. Robert Keppel	SERIAL	UNIT H&R	APPROVED BY:
---	--------	-------------	--------------

PAGE

11

OF

13

KING COUNTY DEPARTMENT OF PUBLIC SAFETY
 ADDITIONAL INFORMATION SHEET/OFFICER'S REPORT

Case No.

7 4

9 5 8 5 2

TO	VIA	DATE 8-5-74	TIME
FROM		SUBJECT: CONTINUATION OF <input checked="" type="checkbox"/> OFFICER'S REPORT REGARDING <input type="checkbox"/> FOLLOW-UP REPORT	

ITEM:

- good friend of hers. JAN wanted to go out drinking in the "U" District and dancing. LINDA stated that JANICE had spent the day at Lake Sammamish State Park. JANICE OTT was a little upset that she had missed her sister. No statement taken.
- 84 9-3-74 1045 hrs.: Received a phone call from DET. MULLENS, Steilacoom P.D., 588-4600. He is currently investigating a rape/assault and has developed information from Arizona and California on a suspect. He related that DET. BALLARD, Tucson, Arizona 602-792-8116, had suspect information on one missing girl, and one murdered girl. The suspect is [REDACTED], currently being held in a Santa Ana jail. [REDACTED] is 5'7", a truck driver, a biker, and goes by at least seven aliases. DET. BALLARD also had information on a suspect in homicides in Michigan who drives a tan VW. DET. MINTON, Los Angeles P.D. Homicide, has someone stabbing people on college campuses in Los Angeles. He also related that FBI BAGLEY in Arizona, 602-623-4306, was working the murdered girl case since the murdered girl is his daughter. MULLENS also related that a MILO BIGGS, Mesa County Sheriff's Office, Colorado, has an unidentified female body, found nude, who is 5'6", 115#, wears contact lenses. The subject had been beaten and strangled. The phone number there is 303-242-3322.
- 85 1120 hrs.: Contacted DET. BALLARD, Tucson Sheriff's Office. The subject they currently have in custody is [REDACTED], who is from OREGON, born in 1953. He is 5'7", 140#. He uses a knife and is known for heterosexual and homosexual relations. DET. BALLARD will send photograph of [REDACTED] to R/O.
- 86 1145 hrs.: Contacted SGT. R. W. REED, Orange County jail, 714-834-3000. He will send photograph of [REDACTED].
- 87 1220 hrs.: Contacted Undersheriff TODD HUTCHINSON, Mesa County Sheriff's Office, Colorado. He described the victim as 15 - 21 years, 5'7", 130#, dark brown hair, shoulder length, pierced ears, blue sapphire birthstone, small wooden cross on a wooden chain, contact lenses with a red dot. She has been dead for approximately 24 hours, beaten, suffocated, and she had been dragged through gravel after death. She never had any children; had considerable dental work. She was found on July 2nd. Information was given to SPD.
- 88 9-5-74 1345 hrs.: Contacted SGT. AUBUSTON, Mercer Island, P.D. He related he had clothing that had been turned in by DR. DONALD R. STROME, 4614 West Mercer Way, H/P 232-1319, B/P 773-0533. He found clothing 100 feet up a road north of Highway #18 near Tiger Mountain parking lot area.

INVESTIGATING OFFICER lh Det. Robert Keppel	SERIAL	UNIT H&R	APPROVED BY:	PAGE 12 OF 13
--	--------	-------------	--------------	------------------

KING COUNTY DEPARTMENT OF PUBLIC SAFETY
 ADDITIONAL INFORMATION SHEET/OFFICER'S REPORT

Case No.

7 4

9 5 8 5 2

TO	VIA	DATE 8-5-74	TIME
FROM		SUBJECT: CONTINUATION OF <input checked="" type="checkbox"/> OFFICER'S REPORT REGARDING <input type="checkbox"/> FOLLOW-UP REPORT	

ITEM:

- 89 9-5-74 1400 hrs.: Contacted at Mercer Island P.D. Examined the clothing; the clothing is not connected with the girls' cases.
- 90 1510 hrs.: Contacted by MARGE STUTH, 13802 160th SE, AL 5-3546. She related that her husband had found some clothing, mainly a bikini in a case in the Fall City area.
- 91 1600 hrs.: Contacted at the STUTH residence and picked up clothing. There was a light green bikini, size 14, in a light green case, two pairs of blue jean cut-offs, miscellaneous make-up and suntan lotion. These items are not related to the missing girls' cases.
- 92 9-6-74 1300 hrs.: Contacted JACK MORRIS, Spokane County Sheriff's Office. R/O inquired if their suspect in their homicide was similar to composite. The suspect's name is [REDACTED], 5'6", 170#, short blond hair, 19 yrs. MORRIS will send a photo of [REDACTED] to R/O.
- 93 1330 hrs.: Contacted DR. BLACKBURN, 509-455-3694. DR. BLACKBURN related that JANICE OTT did not have pierced ears, and did not wear contact lenses although she is near sighted. When she went swimming she usually took off all jewelry to include her wedding ring. There were no blue and white shoes among her belongings that he picked up in Issaquah.
- 94 Numerous other leads on persons thought to be "TED" and vehicles similar to Volkswagens described, have been checked and eliminated.
- These names and license numbers are too numerous to list and are found in files by cross referenced card indexes.

INVESTIGATING OFFICER Det. Robert Keppel	SERIAL	UNIT H & R	APPROVED BY:	PAGE 13
				OF 13

ORIGINAL

PIERCE

COUNTY

COUNTY-CITY BUILDING

TACOMA, WASHINGTON

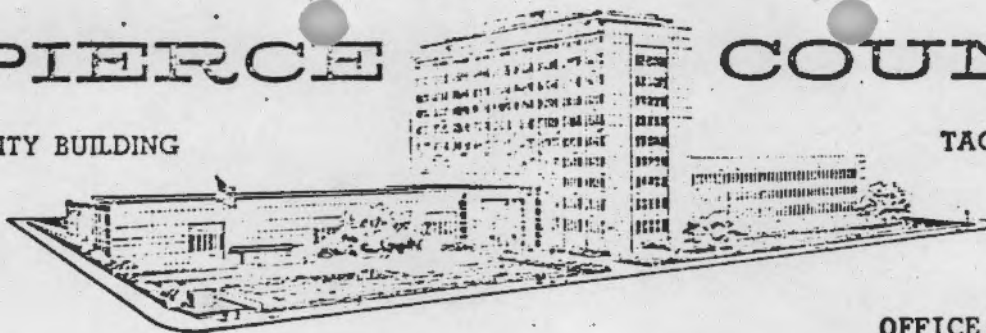

OFFICE OF COUNTY SHERIFF

CARL L. PETERSEN
SHERIFF

July 31, 1974

In reply: Refer to File No.

COPY

Officer Cheryl Schmeizer
Central Washington State College
Carnus Police
Ellensburg, Wash. 98926

Dear Officer Schmeizer,

Enclosed you will find the statement taken from Ms. Kathleen Bolivo concerning the subject she had contact with on the campus. I believe you had a conversation with Sgt. Mock of this office concerning this witness.

It does not state on the statement what date this occurred and I have not been able to reach Kathleen by phone as yet.

You can contact me during duty hours at 503-4735. Feel free to call if we can be of any further assistance.

Sincerely,

Walt Stout

Walt Stout
Detective, Pierce County Sheriff's Office

cc: Detective Robert Koppert
King County Police

ORIGINAL
74-95852

TIME 0915 DATE 7-27-74

CASE # _____

SHERIFF'S OFFICE
TACOMA, WASHINGTON

STATE OF WASHINGTON)
COUNTY OF PIERCE)

My name is KATHLEEN C. D'OLIVO. I am 21 years of age, was born on 10-05-52, at Tacoma, Wa. I am (~~married~~) (single) and reside at 4801 Dunbar Ln. V.W. Giff Harbor. I have lived in Pierce County since 1952.

I am making the following statement to Det. Johnson #165, knowing that he is a ^{DEPUTY} ~~detective~~ with the Pierce County Sheriff's Office. I have been advised of my civil rights which are guaranteed to me under the State and Federal Constitution. I understand that I am entitled to an attorney if I want one and that if I do not have funds the Court will appoint an attorney to represent me at State expense. I know that I have a right not to say anything, and anything I might say can be used against me in court. I know also that I have a right to a jury trial. At 10:10 A.M. (approx.)

I was walking from Boullion library at C.W.S.C. Behind me I heard someone drop packages. I turned around and saw a man dropping a few boxes & a back pack of books. I asked if I could help him -- I thought he was going into the library. He began walking past the library I asked where he was going, he said his car was just up a ways. I said O.K. I'd walk there. I was extremely cautious while with him. I never gave him the opportunity of walking behind me. His ^{right} arm was in a cloth sling and he had a metal brace on one or two fingers of his right hand. His left hand had a metal plate bracing his fingers on the palm side. There were bandages holding the brace on. He had brown hair (I think fairly dark brown). His hair was below the ear. It was dark and I didn't really notice his features. He was about

I make this statement of my own free will and accord. No promises have been made to me, nor any duress used against me. I have read the above statement in its entirety. It is a true and correct statement to the best of my knowledge and belief.

SUBSCRIBED AND SWORN TO BEFORE ME THIS 27th DAY OF July, 1974.
X Kathy D'Olivo

WITNESSES:

Notary Public in and for the State of Wash.
residing in Tacoma, Pierce County, Washington.
74-95852
ORIGINAL

5'8"-5'11". Medium build. We walked across Grays Conference bridge, under the tressels and right into the alley. It was extremely dark there. His car was parked against the log there. The car was a VW bug. I don't remember color, but the car was a newer VW model and shiny. He walked to the passenger side and started to unlock the door, I set the bag of books down to leave, & he dropped the key in the dirt. He tried to feel for it on the ground, but said he couldn't 'cus of his metal brace. He asked if I would find it for him. I wasn't about to bend over in front of him, so I suggested we stand back and see if the reflection of the light would let us see the key. Luckily the key did shine, I picked it up & handed it to him and left.

He told me his bandages were the result of a ski accident and explained how the accident had happened. He might have had a mustache. His hair was the type that was sort of in his face -- I think that's why nothing about his face stands out in my mind. I

74-95851
ORIGINAL

also think he may have had wire-rimmed glasses. I don't vividly remember these things, I just remember his face wasn't clear to see or clear-cut looking.

His voice wasn't outstandingly different, he talked fairly softly with kind of an "inward" voice.

KING COUNTY DEPARTMENT OF P FETY
 ADDITIONAL INFORMATION SHEET/OFFICER'S REPORT

Case No.

--	--

--	--	--	--	--	--

TO SGT. RANDELL	VIA	DATE 7/23/74	TIME
FROM D. W. HOUSE (04664) KCP	SUBJECT: CONTINUATION OF <input type="checkbox"/> OFFICER'S REPORT REGARDING <input checked="" type="checkbox"/> Denise Nasland		

ITEM:

Approximately 6 months ago I was told by my wife that Denise Nasland a girl she had grown up with was living with girl friends; Robin Woods (WF approx. 18 yrs.), and Terry Watkins (WFA Approx. 22 Yrs.). Robin Woods brother, Martin Woods (WMA Approx. 23 Yrs.) was dealing in drugs and that Denise Nasland was hooked on drugs. Denise was into prostitution to support her habit. On 7/22/74 I ask a personal friend of Denise, Gayle Sherwood if this was true and was told yes it was and that Denise was working for a body painting studio part time. She told me she didn't know which one but she thought it was downtown Seattle. I ask her who had given her this information and was told ~~by~~ Denise Nasland and Robin Woods had told her and that Terry Watkins would know where she had worked and that Robin Woods would also know. Terry Watkins can be contacted at the Epicure Restaurant at 9801 16th S.W. from 6:00 P.M. until 2:00 A.M. Terry Watkins may be reluctant to say anything ~~XXXXX~~ ~~XXXXX~~ to the police because of self incrimination. Terry Watkins and Ken Little would know where you could contact Robin Woods. Both Robin Woods, who is a very close friend of Denise Nasland and Terry Watkins has all the information that might be pertinent to Denise Naslands disappearance. Gayle Sherwood can be contacted at 242-3657, but unless it is absolutely nessary I would appreciate it if Gayle Sherwood was not contacted. All of the above said might be reluctant to say anything because of self incrimination.

File

INVESTIGATING OFFICER <i>D. W. House</i>	SERIAL <i>04664</i>	UNIT	APPROVED BY:
---	------------------------	------	--------------

PAGE 1
OF 1

74-35852
ORIGINAL

Keppeler

74 - 95852

Case No.



TO	Sgt Randal	VIA	Mail	DATE	8-12-74	TIME	1805
FROM	#43 Eastman, William	SUBJECT: CONTINUATION OF <input type="checkbox"/> OFFICER'S REPORT REGARDING		Info. on Ott Case			

ITEM:

Lois Jones reports Mary Bacon's comments on the
ott case are on tape, available any time.

Phone # 762-7154

INVESTIGATING OFFICER

#43 Eastman, William

SERIAL

office

UNIT

2nd

APPROVING OFFICER

Acting Sgt. J.W. Clark

PAGE

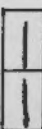

KING COUNTY DEPARTMENT OF PUBLIC SAFETY
STATEMENT

Victim ☐ Witness ☒ Date 07-19-74 Time 1330

7	4
---	---

CASE NO.				
9	5	8	5	2

Taken by PAULA RALPH, Issaquah Police Dept. Serial # _____

Statement of LANE HARTVIGSON Age 24

Alias None

Address 16020 13th SW, Burien Washington Zip 98166 Phone CH 4-9642

Date of Birth 12-06-49 at Williston, North Dakota

Occupation & Employer Postal Clerk - Sea-Tac Bus. Phone AMF

Status Married

On Sunday, July 14, 1974, at approximately 4:15 p.m., my wife and I were out driving around - we were going to go swimming but it was too cold. I can recall the time because my wife had just asked me what the time was. As we were leaving Pine Lake Park I noticed a metallic brown Volkswagen "Bug" parked between two pine trees at the north end of the main parking area. The VW did not have a front bumper and I had never seen that color of brown before on a VW. The vehicle had mag wheels, it was very clean; there were no occupants in the car at the time I saw it.

I heard on the news last night (07-18-75) that a metallic brown Volkswagen was involved with the missing girls. I could identify this Volkswagen if I saw it again.

Lane M. Hartvigson

KING COUNTY

DEPARTMENT OF PUBLIC SAFETY

STATEMENT

Victim ☐Witness ☒Case No. 74-95852

District Number _____

Date 07-19 1974Hour _____ A.M. 1330 P.M.Type of Case Missing PersonTaken by Paula Ralph, Issaquah Police Dept.

Serial No. _____

Statement of Lane HartvigsonAge 24Alias noneZip 98146Phone CH 4-9642Address 16020-13th SW, Burien, WaDate of Birth 12-06-49 at Williston, North DakotaOccupation & Employer Postal Clerk Sea-TacBus. Phone AMFStatus Married

On Sunday, July 14, 1974, at approximately 4:15pm my wife and I were out driving around - we were going to go swimming but it was too cold. I can recall the time because my wife had just asked me what the time was. As we were leaving Pine Lake Park I noticed a metallic brown Volkswagen "Bug" parked between two pine trees at the North end of the main parking area. The VW did not have a front bumper and I had never seen that color of brown before on a VW. The vehicle had mag wheels, it was very clean, there were no occupants in the car at the time I saw it.

I heard on the news last night (07-18-74) that a metallic brown Volkswagen was involved with the missing girls. I could identify this Volkswagen if I saw it again.

*Lane Hartvigson*ORIGINAL
74-95852

KING COUNTY DEPARTMENT OF PUBLIC SAFETY
STATEMENT

Victim ☐ Witness ☒ Date July 19, 1974 Time 6:25 p.m.

7	4
---	---

9	5	8	5	2
---	---	---	---	---

Taken by DETECTIVE ROLF T. GRUNDEN Serial # 07851
Statement of PATRICIA ANN TURNER Age 18
Alias PAT
Address 13416 118th NE Zip 98033 Phone 822-4043
Date of Birth Sept. 28, 1955 at Seattle
Occupation & Employer Safe-Com Bus. Phone GL 4-3856
Status Single - living with parents

July 14, 1974, I went to Lake Sammamish Park with another couple, DONNA RAY, KIM PRIOR and my boyfriend NICK BENNETT. We got to the park around 3:00 p.m. We first sat down in front of the concession stand, we sat there for about fifteen minutes, then moved to where the Rainier picnic was. NICK and myself stayed at the Rainier picnic. DONNA and KIM sort of wandered off - we met them about quarter to four at the Rainier picnic site. The four of us returned to the area in front of the concession stand and sat down on the beach - this was about 4:15 p.m. I didn't feel good so I got up and walked toward the concession stand. As I was walking up the sidewalk a man came walking toward me. He had a sling on his left arm. The sling was bleached white, clean. He had on white shorts, a white T-shirt and white tennis shoes. He was about 5'8", 160 - 165, he was well built. His hair was dishwater blonde, it was about neck length, cut in a shag; as far as I know he didn't have sideburns; it was parted in the middle more or less - his hair was messy. He was a very good looking man. He was about 24 or 25.

As I walked to the concession stand he followed me. We talked to each other, on the sidewalk he said "I need to ask a really big favor of you." He then said "You can see I'm not very useful of hand, would you please help me launch my sailboat?" I looked at him as if I didn't understand. He said: "I normally wouldn't ask this favor but my brother is busy and is unable to help." He sort of pointed in the direction of the parking lot. I said:

KING COUNTY DEPARTMENT OF PUBLIC SAFETY
ADDITIONAL INFORMATION SHEET/OFFICER'S REPORT

Case No.

7 4

9 5 8 5 2

TO	VIA	DATE 4-19-74	TIME 6:25 p.m.
FROM		SUBJECT: CONTINUATION OF XX OFFICER'S REPORT REGARDING <input type="checkbox"/> Statement of PATRICIA ANN TURNER	

ITEM:

"Well, I am sort of in a hurry to go." He said: "That's OK." He just stood there for a few seconds, that's when I walked on to the concession stand. I glanced off into the crowd and saw him walk away.

I didn't notice any accent in his speech. After I got to the concession stand my boyfriend came up. I told him what the man said.

NICK said he didn't notice the man except from the back.

We left about 4:45 p.m.

Today, July 19, 1974, I saw him in a composite drawing in the Seattle Times. Today, DETECTIVE GRUNDEN showed me a composite of him which I will sign on the back of the photo.

Patricia Turner
July 19, 1974

INVESTIGATING OFFICER	SERIAL	UNIT	APPROVED BY:
-----------------------	--------	------	--------------

PAGE

OF

Victim ☐Witness ☒

KING COUNTY

DEPARTMENT OF PUBLIC SAFETY

STATEMENT

Case No. 7A-95852

District Number _____

Date July 19 19 74Hour _____ A.M. 6-25 P.M.Serial No. 07851Age 18Alias pat Zip 98033 Phone 822-4043Address 13416 118 NEDate of Birth Sep 28, 1955 at SeattleOccupation & Employer Safe. com Bus. Phone GL4 3856Status Single - living with parents

July 14, 1974 I went to Lake Sammish park with another couple, Donna Ray, Kim prior and my boyfriend Nick Bennett. we got to the park around 3:00 pm. we first sat down in front of the concession stand - we sat there for about fifteen minutes then moved to where the Rainier picnic was. Nick and myself stayed at the Rainier picnic Donna and Kim sort of wandered off - we met them about quarter to four at the Rainier picnic sight. The four of us returned to the area in front of the concession stand and sat down on the beach - this was about 4:15 pm I didn't feel good so I got and walked towards the concession stand. and I was walking up the sidewalk a man came walking towards me. He had a sling on his left arm. the sling was bleached white, clean. he had on white shorts, a white "T" shirt and white tennis shoes. He was about 5-8. 160-165. he was well built. His hair was dark water blonde, it was about neck length cut in a shag

DT ✓

ORIGINAL

KING COUNTY DEPARTMENT OF PUBLIC SAFETY

STATEMENT

PAGE ____ OF ____ PAGES

Case No. _____

Date _____ 19 ____

Hour _____ A.M. 6:45 P.M.Statement of Pat Turner

as far as I know he didn't have red hair - It was parted in the middle more or less - his hair was messy. He was a very good looking man. He was about 24 or 25 at I walked to the concession stand he followed me. we talked to each other on the sidewalk he said I need to ask a really big favor of you - he then said you can see I run a very useful of hand would you please ^{help} me launch my sail boat. I looked at him as if I didn't understand. He said I normally wouldn't ask this favor but my brother is busy and is unable to help. ^{he sort of pushes in front} I said well I can ^{is a} ~~is~~ ^{is} hurry to go. He said that's ok. He just stood there for a few seconds that's when I walked on to the concession stand. I glanced off into the ~~crowd~~ crowd and saw him walk away.

I didn't notice any accent in his speech. after I got to the concession stand my boyfriend came up. I told him what the man said. Nick said he didn't notice the man except from the back.

we left about 4:45 pm.

Today July 19, 1974 I saw him in a composite drawing in the Seattle times. Today detective Humber showed me a composite of him which I will sign on the back of the photo.

Patricia Turner

July 19 1974

6:50 p.m.

74-95850
ORIGINAL

KING COUNTY
DEPARTMENT OF PUBLIC SAFETY

Victim ☐

Witness ☒

STATEMENT

Case No. _____

Date July 30 19 74

Hour 1200 A.M. _____ P.M.

Taken by DETECTIVE ROLF T. GRUNDEN Serial # 07851

Statement of ROBIN ROSE WOODS Age 19

Alias NONE

Address 10624 21 SW, Seattle Zip 98146 Phone 248-1652

Date of Birth 5-12-55 at Seattle

Occupation & Employer Model Bus. Phone 632-1142

Status: Single

I have known DENISE NASLUND since the seventh grade. We have known each other seven years. DENISE was my roommate for seven months from October 10 to April 1, 1974.

From November on, KENNY LITTLE lived at our house.

DENISE is a person who has a good personality. She tends to get along good with people. I never saw KENNY or DENISE fight physically, but I have heard them argue.

We have used various types of dope but we tend to use marijuana.

DENISE always wore a black onyx ring. The band is yellow gold. The stone is tear-drop in shape. She also wore a gold wedding band on her little finger on either hand. On her right hand on her third finger she wore a ring with a light blue stone and a silver band. She wore a zodiac necklace, Libra sign. It was silver with black antique. She also wore a gold watch on her left hand.

The last time I saw DENISE was on July 3, 1974. She came to my house with her brother BROCK and KENNY LITTLE. KENNY came over to get his fishing pole. They were going to Fish Lake over in the eastern Washington area.

DENISE was mad and more or less didn't want to go. She said her and KENNY had been arguing. BROCK normally took KENNY'S side.

ORIGINAL

KING COUNTY DEPARTMENT OF PUBLIC SAFETY
 ADDITIONAL INFORMATION SHEET/OFFICER'S REPORT

Case No.

--	--

--	--	--	--	--	--

TO	VIA	DATE	TIME
FROM		SUBJECT: CONTINUATION OF <input type="checkbox"/> OFFICER'S REPORT REGARDING <input type="checkbox"/> Statement of: Robin Rose Woods	

ITEM:

She wished me and my boyfriend, JOE ALCON, could go. We couldn't be-
 cause we had company from out of town. They must had stayed five minutes
 and left. They left around 10:00 PM.

I left town to Nevada on July 9, 1974. I returned hom July 14, 1974
 at 10:30 PM. From July 3, 1974 on I have never heard from DENISE. I
 am sure if she were around, I would have been the first person she would
 have contacted.

I know she would never go anywhere with any motorcycle people because
 she feared them. She knows how they are from what I've told her.

At one time DENISE worked for Sselect Enterprise. It was a dating
 and escort service. She was a receptionist and bookkeeper. She never
 went out on dates.

I would like to make it clear that DENISE never worked at a body
 painting studio.

I would like to add, DENISE is the kind of person who likes to
 talk about herself to people who are interested or people she is interest-
 ed in. If she was high on July 14, 1974, she would be loose. If the
 guy was a smooth talker and good looking, DENIS would then help him.

This statement is true and correct to the best of my knowledge.

/s/ Robin R. Woods July 30th, 1974 1:00 PM

tm

INVESTIGATING OFFICER	SERIAL	UNIT	APPROVED BY:

PAGE 2
 OF

ORIGINAL

DEPARTMENT OF PUBLIC SAFETY

STATEMENT

Victim ☐Witness ☒

Case No. _____

District Number _____

Date July 30 19 74Hour 12⁰⁰ A.M. _____ P.M.Serial No. 07851Age '19'Type of Case Missing personTaken by Detective Rolf To GrundenStatement of Robin Rose WoodsAlias NoneZip 98146Phone 248-1652Address 10624 21- SW- SeattleDate of Birth 5-12-55 at SeattleOccupation & Employer ModelBus. Phone 632-1142Status Single

I have known Denise Nashind since the seventh grade. we have known each other seven years.

Denise was my roommate for seven months from Oct. 10 - April 1, 1974.

From November on Kenny Little lived at our house.

Denise is a person who has a good personality, she tends to get along good with people. I never saw Kenny or Denise fight physically, but I have heard them argue.

we have used various types of dope but we tend to use marijuana.

Denise always wore a black onix ring, the band is yellow gold, the stone is teardrop in shape. She also wore a gold wedding band on her little finger on either hand. on her right hand on her third finger she wore ring with a light blue stone with a silver band. She wore a yodanis necklace, Libra sign, it was silver with black onyx. She also wore a gold watch on her left hand. D.D. 112

STATEMENT

PAGE 2 OF PAGESCase No. Date July 30 19 74Hour A.M. P.M.Statement of Robin Russ woods

The last time I saw Denise was on July 3, 1974. She came to my house her brother Brock & Kenney Little. Kenney came over to get his fishing pole. They were going to Fish Lake over in the Eastern Washington area.

Denise was mad and more or less didn't want to go. She said her and Kenney had been arguing. Brock normally took Kenney's side.

She wished me and my boyfriend, Joe Adams, could go. We couldn't because we had company from out of town. They must had stayed five minutes and left. They left around 10:00 p.m.

I left town, to Nevada, on July 8, 1974, I returned home July 14, 1974, at 10:30 p.m.

From July 3, 1974 on I have never heard from Denise. I am sure if she were around I would have been the first person she will contact.

I know she would never go anywhere with any motorcycle people because she feared them. She knows how they are from what I've told ~~her~~ her.

At one time Denise worked for Select enterprise, it was ~~was~~ a dating and escort service. She was a receptionist and bookkeeper. She never went out on dates.

I would like to make it clear Denise never

Victim ☐

Witness ☒

KI' 3 COUNTY
DEPARTMENT OF PUBLIC SAFETY

STATEMENT

Case No. 74-95852

District Number _____

Date JULY 22 19 74

Hour _____ A.M. 6:50 P.M.

Type of Case MISSING PERSON

Taken by DETECTIVE ROLF GRUNDEN

Serial No. 07851

Statement of DENNIS- C- WINTER

Age 37

Alias "D.C."

Zip 98146

Phone 433-9922

Address 11069 16-SW SEA.

Date of Birth Oct 4, 1937 at ST. PAUL- MINN.

Occupation & Employer OWNER OF FIRE DOG INN - Bus. Phone 433-9922
11069-16-SW

Status DIVORCED.

APPROXIMATELY 6 TO 8 WEEKS AGO I PULLED SOME
ID, WASH. ST. DRIVERS LICENSE FROM A GIRL. ^{THE ID} WAS OBVIOUSLY
NOT HER. I RECOGNIZED THE GIRL AS BEING THE BARTENDER
^{ON THE ID}
AT THE EPICURE WHICH IS LOCATED IN WHITE CENTER.

SHE WAS WITH A BOY, NAMED KEN LITTLE, AND HER
MOTHER.

I TOOK THE ID GAVE THEM A LECTURE, I
KEPT THE ID AND RETURNED IT TO THE GIRL
AT THE EPICURE.

D Winter 7-22-74

KING COUNTY

DEPARTMENT OF PUBLIC SAFETY

Victim ☐Witness ☒

STATEMENT

Case No. 74-95852

District Number _____

Date July 22 19 74Hour _____ A.M. 6:50 P.M.Type of Case MISSING PERSONTaken by DETECTIVE ROLF GRUNDENSerial No. 07851Statement of DENNIS C. WINTERAge 37Alias "D.C." Zip 98146 Phone 433-9922Address 11069 16th SW, SeattleDate of Birth 10/4/37 at St. Paul, MinnesotaOccupation & Employer Owner of Fire Dog Inn, 11069 16th SW Bus. Phone 433-9922Status divorced

Approximately 6 to 8 weeks ago, I pulled some I.D., Washington State driver's license, from a girl. The I.D. was obviously not her's. I recognized the girl on the I.D. as being the bartender at the Epicure which is located in White Center. She was with a boy, named KEN LITTLE, and her mother.

I took the I.D., gave them a lecture, and I kept the I.D. and returned it to the girl at the Epicure.

/s/ D.C. Winter 7/22/74

KING COUNTY
DEPARTMENT OF PUBLIC SAFETY

Victim ☐

Witness ☒

STATEMENT

Case No. 74-95852 Date 7/18 19 74
Hour 11:20 A.M. P.M.
Taken by DET. M. M. BAILY Serial # 02809
Statement of IRIS L. YOCUM Age 21
Alias --
Address 517 S.W. 132 Zip 98146 Phone 242-7192
Date of Birth 3/9/53 at Seattle, WA
Occupation & Employer Jupitor, Co. Bus. Phone 242-9300
Status: Single, living with Aunt.

During Christmas, 1973, I was living with MELANIE JOHNSON, at 4522 S.W. Graham St. Between Christmas and March, 1974, MELANIE told me that she had observed a man described as 5'6" or 5'7", med. build, approximately 140 - 150 lbs., 30 - 35 yrs. of age, dressed in a dark business type hat, dark mid-length (calf length) overcoat, his hair was light brown, fairly straight, unkempt and greasy looking, clean shaven, sort of baby-faced; this man never talked to MELANIE, but only stood on the street corner. In the middle of March, a friend was helping me pack as I was going to move. It was 10:30 P.M., as we were doing so, and I heard a faint knock at my front door. I thought it strange that the knock was so faint, and I went to the door. The same man as described above was standing there. He was wearing the same clothes, but had on a white shirt, open at the neck. This man looked at me and said, "You're not the one I want." I asked who he was looking for, and he said, "The girl with the dark hair, I've seen her come here." I told him that she was not there right now, and he then stared at me for a short time, eyed me up and down, then said, "That I would do". At this point, he took his hands out of his pockets, and I saw that he had on black gloves, plastic leather-type, that

KING COUNTY DEPARTMENT OF PUBLIC SAFETY
ADDITIONAL INFORMATION SHEET/OFFICER'S REPORT

Case No.

7 4

9 5 8 5 2

TO	VIA	DATE	TIME
FROM		SUBJECT: CONTINUATION OF <input type="checkbox"/> OFFICER'S REPORT REGARDING <input type="checkbox"/> STATEMENT, CONTINUED:	

ITEM:

just covered his wrists, as he took his hands out of his pockets, he looked to the side of me and I think he saw AL HATHEWAY, my friend; when he did, he said, "Forget it, it would not work anyway." He then put his hands back into his pockets then ran down the steps and away. AL came to me and asked what was wrong. I told him what I suspected. I also remember smelling booze on this subject. This subject, when he left my house, ran toward California Ave. S.W. Approximately three nights later, at approx. 10:00 or 10:30 P.M., I was at my house. I had just picked up the phone and was looking out of the window and saw this same man standing on the street corner. I told AL who he was (outside). He shut the curtains, then ran outside to try to see this subject, but he was gone. AL did not see him. Neither I, nor MELANIE, have ever had any prior contact with this man, and do not know how he may have picked us to watch. There are two or three taverns in the area on California Avenue. They are Digby's, The White House, and another tavern. The suspect did seem intoxicated and did run toward these taverns. Neither I, nor MELANIE, ever went to these taverns, but did go to the Tradewell Store and other stores nearby.

This is a true and correct statement given to the best of my knowledge and memory.

/s/ Iris L. Yocum

INVESTIGATING OFFICER	SERIAL	UNIT	APPROVED BY:

PAGE 2
 OF

ORIGINAL

Victim ☐Witness ☒KII COUNTY
DEPARTMENT OF PUBLIC SAFETY

Case No. 74-95852

STATEMENT

District Number

Date 7-18 1974

Hour 1120 A.M. P.M.

Type of Case Missing Person

Taken by Det. MM Bailey

Serial No. 02809

Statement of Iris L. Yocum

Age 21

Alias Zip 98146 Phone 242-7192

Address 517 S.W. 132

Date of Birth 3-9-53 at Seattle WA

Occupation & Employer Jupiter Co. Bus. Phone 242-9300

Status Single living with Aunt.

During Christmas 1973 I was living ^{with} Melaine Johnson at 4522 S.W. Graham st. Between Christmas and March 1974 Melaine told me that she had observed a man described as, 5'6" or 5'7", med build, approx. 140-150 lb, 30-35 yrs of age, dressed in a dark business type hat, dark mid-length calf length over coat, his hair was light brown fairly straight, unkempt & greasy looking, clean shaven sort of baby faced, this man never talked to Melaine but only stood on the street corner. In the middle of March a friend was helping me pack as I was going to move ^{at 11:00-10:30 P.M.} as we were doing so I heard a faint knock at my front door, I thought it strange that the knock was so faint, I went to the door and the same man as described, ~~about~~ alone was standing there, he was wearing the same clothes but had on a white shirt open at the neck. This man looked at me and said "you not the one I want", I asked who he was looking for

STATEMENT

PAGE ____ OF ____ PAGES

Case No. 74-95852

Date ____ 19__

Hour ____ A.M. ____ P.M.

Statement of

and he said "the girl with the dark hair, I've seen her come here," I told him that she was not there right now, he then stared at me for a short time eyed me up and down then said "that I would do," at this point he took his hands out of his pockets and I saw that he had on black gloves, plastic leather type that just covered his wrists, as he took his hands out of his pockets he looked to the side of me and I think he saw Al Hatheway my friend when he did he said "forget it, it would not work anyway." he then put his hands back into his pockets then ran down the steps and away. Al came to me and asked what was wrong I told him what I suggested, I also remember smelling booze on this subject. This subject when he left my house ran toward Calif one S.W. Avenue three nights later at approx 1000 or 10:30 P.M. I was at my house, I had just picked up the phone and was looking out of the window and saw this same man standing on the street corner, I told Al who he was outside, he shut the curtains then ran outside to try to see this subject but he was gone and Al did not see him. Neither I nor Melaine have ever had any prior contact with this man and do not know how he may of picked us to watch, there are two or three Taverns in the area on Calif one, they are

KING COUNTY DEPARTMENT OF PUBLIC SAFETY

STATEMENT

PAGE 3 OF 3 PAGES

Case No. 74-95852

Date 7-18 1974

Hour _____ A.M. _____ P.M.

Statement of

Dugby, the White Horse and another tavern the suspect did seem intoxicated and did run toward these taverns. Neither I nor Melvin ever went to these taverns but did go to the Trademell store and other store nearby.

This is a true and correct statement given to the best of my knowledge and memory.

Eric L. Yocum

KING COUNTY
DEPARTMENT OF PUBLIC SAFETY
STATEMENT

Victim ☐

Witness ☒

Case No. 74-95852

Date 7/18 19 74

Hour 1435 A.M. P.M.

Taken by ROBERT D. KEPPEL Serial # 04533

Statement of RENEE FRANCES SCHOENHALS Age 35

Alias

Address 21450 SE 23rd, Issaquah Zip 98027 Phone 392-1723

Date of Birth 1/14/40 at

Occupation & Employer House wife Bus. Phone

On July 14, 1974, at about 10:15 A.M., my family and I arrived at Lake Sammamish State Park. At about noon, I saw a white male with his arm in a sling talking with a motorcycle group. The reason I noticed him was because I had had my own arms in a sling. I noticed that all the motorcycle group were drinking wine and beer and smoking dope. We were sitting behind the concession stand near the restroom. We were about 50 feet from the motorcycle gang. Twice during the next 25 minutes, he walked away and came back. At about 3 P.M., I was walking towards the kite flier and I saw the guy with the sling again. We met each other on a path and he was about a foot from me. I would describe him as 5'10", medium build, dark blonde hair, curly, not long or bushy, average looking, medium tan, no shirt, arm was in a beige sling with no cast; it was a large sling, long pants, unknown color. I would recognize his face again. He was clean shaven. I did not see him after that.

Not more than an hour later, I observed a girl with dark long hair talking, laughing with the motorcycle guys. She appeared to stop briefly to talk. She had on a blue halter top. She jumped on a motorcycle, laughing. There was a guy driving the cycle with a leather jacket and dirty long hair, stringy. He circled the motorcycles with her on the back, about 3 or 4 times. He spun

KING COUNTY DEPARTMENT OF PUBLIC SAFETY
ADDITIONAL INFORMATION SHEET/OFFICER'S REPORT

Case No.

74

9 5 8 5 2

TO	VIA	DATE	TIME
FROM		SUBJECT: CONTINUATION OF <input type="checkbox"/> OFFICER'S REPORT REGARDING <input type="checkbox"/> STATEMENT, CONTINUED:	

ITEM:

around and took off towards the parking lot. She said, "No, I can't, let me off." She kept repeating that until she faded out. It appeared to be a regular motorcycle, possibly black, in shiny condition. About a half hour later, the motorcycle group was getting rowdy, and I gathered up my family and moved.

I have read the above statement and it is true and correct to the best of my knowledge.

/s/ Renee Schoenhals

July 18, 1974

3:20 P.M.

INVESTIGATING OFFICER	SERIAL	UNIT	APPROVED BY:
-----------------------	--------	------	--------------

PAGE 2
OF

ORIGINAL

Victim ☐Witness ☒

K' 3 COUNTY

DEPARTMENT OF PUBLIC SAFETY

STATEMENT

Case No. 74-95852District Number F-1Date 7-18 19 74Hour A.M. 1435 P.M.Serial No. 04583Age 35Type of Case Missing PersonTaken by ROBERT D. KEPPELStatement of RENEE FRANCES B. SCHOENHALSAlias _____ Zip 98027 Phone 392-1723Address 21450 SE 23 ISSAQUAHDate of Birth 1-14-40

at _____

Occupation & Employer HOUSE WIFE

Bus. Phone _____

Status _____

ON JULY 14, 1974 AT ABOUT 10:15 AM MY FAMILY AND I ARRIVED AT LE SAMMAMISH STATE PARK. AT ABOUT NOON I SAW A WHITE MALE WITH HIS ARM IN A SLING TALKING WITH A MOTORCYCLE GROUP. THE REASON I NOTICED HIM WAS BECAUSE I HAD HAD MY OWN ARMS IN A SLING. I NOTICED THAT ALL THE MOTORCYCLE GROUP WERE DRINKING WINE AND BEER AND SMOKING DOGS. WE WERE SITTING BEHIND THE CONCESSION STAND NEAR THE REST ROOM. WE WERE ABOUT 50 FEET FROM THE MOTORCYCLE GANG. TWICE DURING THE NEXT 25 MINUTES HE WALKED AWAY AND CAME BACK. AT ABOUT 3 PM I WAS WALKING TOWARDS THE KITE FLIER AND I SAW THE GUY WITH THE SLING AGAIN. WE MET EACH OTHER ON A PATH AND HE WAS ABOUT A FOOT FROM ME. I WOULD DESCRIBE HIM AS 5'-10", MEDIUM BUILD, DARK BLONDE ^{HAIR}, CURLY, NOT LONG OR BUSHY, AVERAGE LOOKING, MEDIUM TAN, NO SHIRT, ARM WAS IN A BEIGE SLING WITH NO CAST; IT WAS A LARGE SLING, LONG PANTS, UNKNOWN COLOR. I WOULD RECOGNIZE HIS FACE AGAIN. HE WAS CLEAN SHAVEN. I DID NOT SEE HIM AFTER THAT.

NOT MORE THAN AN HOUR LATER I OBSERVED

ORIGINAL

STATEMENT

PAGE 2 OF PAGESCase No. 74-95852Date 7-18 1974Hour A.M. 1435 P.M.Statement of RENÉE F. SCHOENHALS

A GIRL WITH DARK LONG HAIR TALKING, LAUGHING WITH THE MOTORCYCLE GUYS. SHE APPEARED TO STOP BRIEFLY TO TALK. SHE HAD ON A BLUE HALTER TOP. SHE JUMPED ON A MOTORCYCLE LAUGHING. THERE WAS A GUY DRIVING THE CYCLE WITH A LEATHER JACKET AND DIRTY LONG HAIR, STRINGY. HE CIRCLED THE MOTORCYCLES WITH HER ON THE BACK ABOUT 3 OR 4 TIMES. HE SPUN AROUND AND TOOK OFF TOWARDS THE PARKING LOT. SHE SAID "NO I CAN'T LET ME OFF." SHE KEPT REPEATING THAT UNTIL SHE FADED OUT. IT APPEARED TO BE A REGULAR MOTORCYCLE, POSSIBLY BLACK, IN SHINY CONDITION. ABOUT A HALF HOUR LATER THE MOTORCYCLE GROUP WAS GETTING ROWDY AND I GATHERED UP MY FAMILY AND MOVED.

I HAVE READ THE ABOVE STATEMENT AND IT IS TRUE AND CORRECT TO THE BEST OF MY KNOWLEDGE.

X Renée Schoenhals
July 18, 1974
3:20 PM

KING COUNTY
DEPARTMENT OF PUBLIC SAFETY
STATEMENT

Victim ☐

Witness ☒

Case No. 74-95852

Date 7-18 19 74

Hour A.M. 1625 P.M.

Taken by DET. RANDY S. HERGESHEIMER Serial # 00019

Statement of ROBERT J. SARGENT Age 22

Alias "Bob" "Burrhead" "Sarge"

Address 18601 94 NE #2, Bothell, Wash. Zip Phone 485-1567

Date of Birth 4-24-52 at Salt Lake City, Utah

Occupation & Employer Western Automation Corp. Bus. Phone

On Sunday morning July 14th, 1974 my girlfriend NANCY BATTEMA and I called KEN LITTLE and DENISE NASLUND and invited them to go to Lake Sammamish State Park. The four of us met at a tavern called Charley's East in Eastgate. We had a beer in the tavern and left for the park about 1:00 PM in Denise's tan Chevrolet. We got ice en route for the case of beer we had with the four of us. We got to the park about 1:30 and parked. En route to the park, DENISE, KEN and myself each ate 4 valiums. We parked and walked to the main picnic area and took up a spot halfway between the bathroom and the Rainier bandstand. At the parking lot we had met DON COOK and 2 girls who were friends of mine and NANCY's. They joined us at our picnic spot. The seven of us shared a marijuana joint. We sat and talked and drank beer and listened to the band. Then DENISE, KEN NANCY and I went over and watched the keg toss until it was over. We returned to our picnic area. We ran into STEVE CAMPBELL, a friend of mine and talked to him for awhile and he left. DON and the two girls were off somewhere else. The four of us then walked down to the lake to the end of the little peninsula where the boats were tied up. We watched the action there for awhile and the 4 of us walked back to the concession stand. I think DENISE and NANCY and KEN went to the rest room to the rear of the concession stand. I got some snacks and the 4 of us returned to our

7 4

9 5 8 5 2

TO	VIA	DATE	TIME
FROM		SUBJECT: CONTINUATION OF <input checked="" type="checkbox"/> OFFICER'S REPORT REGARDING <input type="checkbox"/> STATEMENT	

ITEM:

picnic area where our towels and ice chest were. We talked and drank beer. Later I went to the rest room at the concession stand and after that I got hot dogs and hamburgers for the 4 of us. The 4 of us then ate the food at our picnic area after DENISE awoke from a nap beside Ken. We sat and talked and drank beer. Around 4:15 PM KEN dozed off. About 4:40 PM, DENISE got up from where we were sitting and walked away without saying anything to me; that was not unusual, because I assumed she was going to the rest room or to find her dog that we had taken to the picnic. She never returned and we began searching for her. We looked all afternoon and evening without finding her. Before this day, I had only met DENISE 3 times and I do not know her well, nor do I have any idea of where she might have gone or why. This statement is true and correct to the best of my knowledge.

/s/ Robert J. Sargent

dp

INVESTIGATING OFFICER	SERIAL	UNIT	APPROVED BY:

PAGE 2
OF

Victim ☐Witness ☒

KANE COUNTY

DEPARTMENT OF PUBLIC SAFETY

STATEMENT

Case No. 74-95852

District Number

Date 7-18 19 74

Hour AM. 1625 P.M.

Type of Case Missing Person

Taken by Det. Randy S. Bergsheim

Serial No. 00019

Statement of Robert S. Sargeant

Age 22

Alias "Bob" "Burnhead" "Sarge" Zip

Phone 485-1567

Address 18601 94 N.E. #2, Bothell, Wash.

Date of Birth 4-24-52 at Salt Lake City, Utah

Occupation & Employer Western Automation Corp.

Bus. Phone

Status single

On Sunday morning July 14th, 1974 my girlfriend Nancy Battema + I called Ken Little ^{RS} + Denise Nashund + invited them to go to Lake Sammamish State Park. The four of us met at a tavern called Charley's East in Eastgate. We had a beer in the tavern + left for the park about 1:00 p.m. in Denise's tan Chevrolet. We got ice en route for the case of beer we had with the four of us. We got to the park about 1:30 + parked. En route to the park, Denise, Ken, + myself each ate 4 Valiums. We parked + walked to the main picnic area + took up a spot halfway between the bathroom + the Rainier bandstand. At the parking lot we had met Don Cook + 2 girls who were friends of mine + Nancy's. They joined us at our picnic spot. The seven of us shared a Marijuana joint. We sat + talked + drank beer + listened to the band. Then ^{RS} Denise, Ken, Nancy, + I went over + watched the bag toss until it was over. We returned to our picnic area. We ran into Steve Campbell, ^{RS} a friend of mine + talked to him for a while + he left. Don + the 2 girls were off somewhere else. The four of us then walked down to the lake

ORIGINAL

STATEMENT

PAGE 2 OF 2 PAGESCase No. 74-95852Date 7-18 1974Hour _____ A.M. 1650 P.M.

Statement of _____

to the end of the little peninsula where the boats were tied up. We watched the action there for awhile & the 4 of us walked back to the concession stand. I think Denise & Nancy & Ken went to the rest room to the rear of the concession stand. I got some snacks & the 4 of us returned to our picnic area where our towels & ice chest were. We talked & drank beer. Later I went to the rest room at the concession stand & after that I got hot dogs & hamburgers for the 4 of us. The 4 of us then ate the food at our picnic area after Denise awaked from a nap beside Ken. We sat & talked & drank beer. Around 4:15^{PM} p.m. Ken dozed off. About 4:40 p.m. Denise got up from where we were sitting & walked away without saying anything. To me that was not unusual, because I assumed she was going to the rest room to find her dog that we had taken to the picnic. She never returned & we began searching for her. We looked all afternoon & evening without finding her. Before this day, I had only met Denise 3 times & I do not know her well, nor do I have any idea of where she might have gone or why. This statement is true & correct to the best of my knowledge.

Robert J. Layton
Det. Randy Kergesheimer

ORIGINAL

Bob Sargent's diagrams.

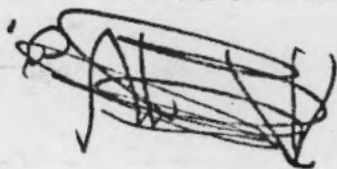
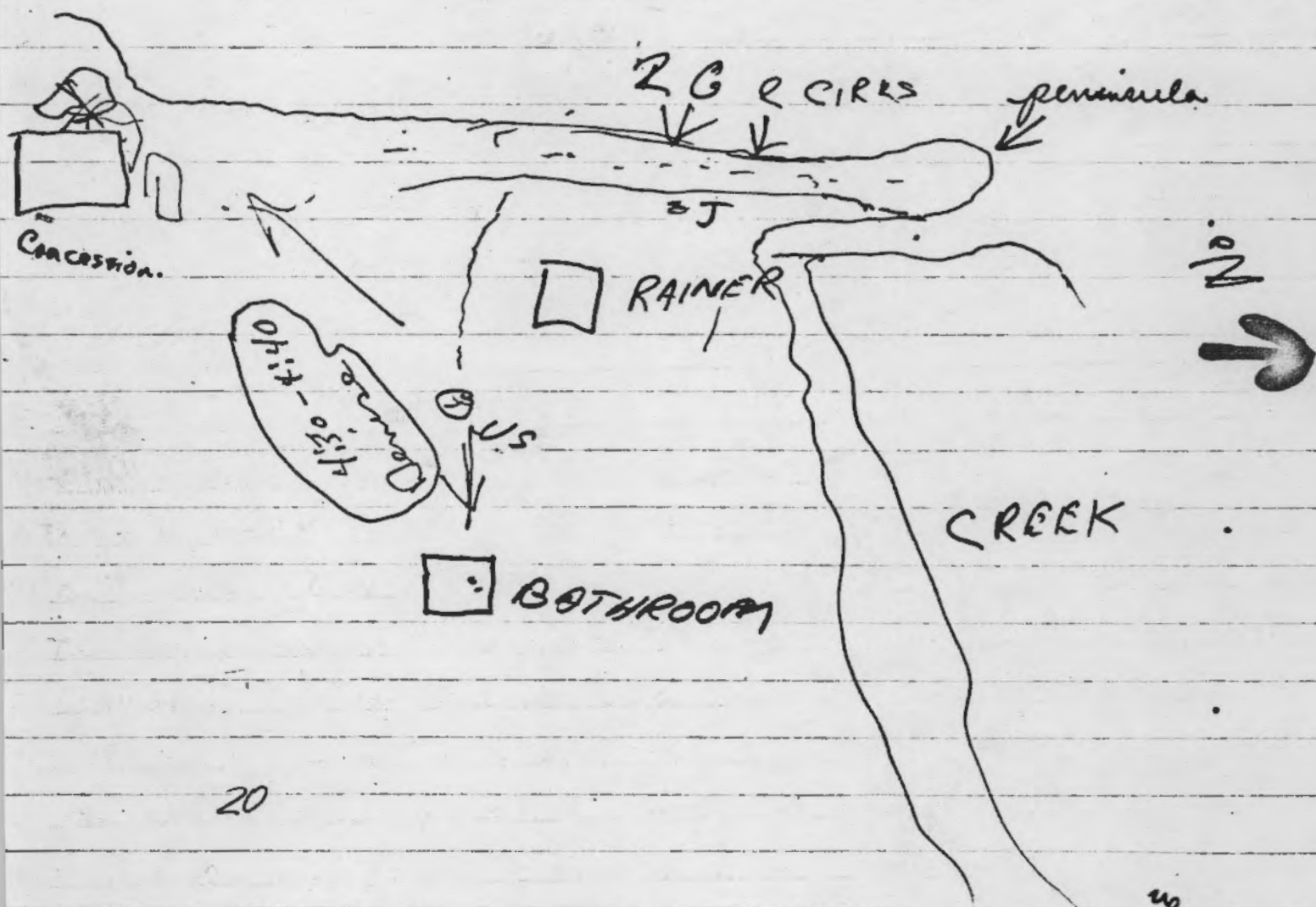

1000000
 74-95852-1
 25852-1
 7 people = 1. point
 Val. K. 4
 Val. B. 4
 Val. N. 4
 1000000

KING COUNTY
DEPARTMENT OF PUBLIC SAFETY
STATEMENT

Victim ☐

Witness ☒

Case No. 74-95852

Date 7/17 19 74

Hour 1745 A.M. P.M.

Taken by ROGER E. DUNN Serial # 01116

Statement of ELEANORE M. ROSE Age 46

Alias Previously NASLUND & maiden name, DEEB

Address 8652 13th S.W. Zip 98106 Phone RO 2-8765

Date of Birth 4/16/28 at Seattle, Wash.

Occupation & Employer Unemployed Bus. Phone _____

Status: Divorced from ROBERT NASLUND, and married to ROBERT ROSE.

I am the natural mother of BROCK NASLUND, age 17, and DENISE MARIE NASLUND, who was born Oct. 10, 1955. DENISE graduated from Chief Sealth High School in January, 1973. DENISE was really thick with PATTY WHITE, 9239 8th W., RO 2-8656, while they were in high school and then she dropped PATTY and took up with ROBIN WOODS, who lives at 10624 21st S.W., CH 8-1652. ROBIN and DENISE got arrested in Tukwila for shoplifting just before she turned 18, and she has told me she smokes marijuana, but I don't think she has been involved with drugs or pills. DENISE ran away for 3 days when she was 12, but she had been very considerate of me because of my nervous condition. I feel that if she was able to, she would have contacted me since she disappeared on Sunday. The first I knew that something was wrong with DENISE was when her boyfriend, KEN LITTLE, drove up in her car around 9:00 P.M. on Sunday, July 14, 1974. KEN told me that, "DENISE is missing." He said he searched Lake Sammamish Park for 4 hours but he couldn't find her. He said they had been fighting all afternoon while at the park. He said he was asleep and DENISE walked off. He really did look concerned. He didn't appear to be messed up, and I didn't notice any marks or scratches on him. She told me she left her

KING COUNTY DEPARTMENT OF PUBLIC SAFETY
 ADDITIONAL INFORMATION SHEET/OFFICER'S REPORT

Case No.

74

9 5 8 5 2

TO	VIA	DATE	TIME
FROM		SUBJECT: CONTINUATION OF <input type="checkbox"/> OFFICER'S REPORT REGARDING <input type="checkbox"/> STATEMENT, CONTINUED:	

ITEM:

car, but she left her sandals and purse locked in the trunk.

Sometimes, DENISE would drive and sometimes KEN would drive the car when they would go somewhere. He said that maybe DENISE had just taken off for a few hours because he would do that to her on occasions. DENISE first met KEN last October while she was living with ROBIN and they moved in together at 4522 S.W. Graham in March, 1974. He drove off with DENISE's car and purse and has stopped by on two different mornings, once he took BROCK over to Lake Sammamish and they looked for DENISE. Since DENISE has been missing, I haven't heard anything from her, and no one has contacted me with ransom demands about her disappearance. DENISE has spoken of going with ROBIN to The Flame Tavern. KEN and DENISE said they usually went to the Fire-Dog Inn and Digby's Tavern to play pool and drink beer. DENISE called me at noon on Sunday and said they were going to the park with BOB SARGENT and that was the last time I heard from her. DENISE said that KEN had never struck her during their arguments, but he has pushed her around.

This 3 page statement is true to the best of my knowledge.

DENISE was going to school at I.T.T. Peterson, studying computer systems on Monday, Tuesday, and Thursday nights from 6:00 - 10:30 P.M. She worked on a part-time basis of about 24 hours a week through Dean Tops Agency in downtown Seattle. DENISE is very loving, and would often pick me up a gift for no special occasion, and I have always felt very close to her. When she walks into my house, it's just like sunshine coming through the door. /s/ Eleanor Rose

INVESTIGATING OFFICER	7/17/74	SERIAL	UNIT	APPROVED BY:	PAGE 2
1840 statement ended.					OF

Victim ☐Witness ☒KING COUNTY
DEPARTMENT OF PUBLIC SAFETY
STATEMENTCase No. 74-95852District Number ~~74-95852~~ F. 1Date 07-17-1974Hour A.M. 745 P.M.Type of Case MISSING PERSONTaken by ROGER E. DUNNSerial No. 01116Statement of ELEANORE M. ROSEAge 46Alias PREVIOUSLY NASLUND & MAIDEN NAME DEEB Zip 98106Phone RO2-8765Address 8652 13 S.W. SEATTLE, WASH.Date of Birth 4-16-28 at SEATTLE, WASH.Occupation & Employer UNEMPLOYEDBus. Phone Status DIVORCED FROM ROBERT ~~ROSE~~ NASLUND & MARRIED TO ROBERT ROSE.

I AM THE NATURAL MOTHER OF BROCK NASLUND, AGE 17, AND DENISE MARIE NASLUND WHO WAS BORN OCT. 10, 1955. DENISE GRADUATED FROM CHIEF SEALTH HIGH SCHOOL IN JANUARY, 1973. DENISE WAS REALLY THICK WITH PATTY WHITE, 9239 8TH W RO2-8656 WHILE THEY WERE IN HIGH SCHOOL AND THEN SHE DROPPED PATTY AND TOOK UP WITH ROBIN WOODS, WHO LIVES AT 10624 21 S.W. CH 8-1652. ROBIN AND DENISE GOT ARRESTED IN TUKWILA FOR SHOPLIFTING JUST BEFORE SHE TURNED 18 AND SHE HAS TOLD ME SHE SMOKES MARIJUANA, BUT I DON'T THINK SHE HAS BEEN INVOLVED WITH DRUGS OR PILLS. DENISE RAN AWAY FOR 3 DAYS WHEN SHE WAS 12, BUT SHE HAS BEEN VERY CONSIDERATE OF ME BECAUSE OF MY NERVOUS CONDITION. I FEEL THAT IF SHE WAS ABLE TO, SHE WOULD HAVE CONTACTED ME SINCE SHE DISAPPEARED ON SUNDAY. THE FIRST I KNEW THAT SOMETHING WAS WRONG WITH DENISE WAS

ORIGINAL

STATEMENT

PAGE 2 OF 3 PAGESCase No. 74-95852Date 07-17-1974Hour 1810 P.M.Statement of ELEANORE M. ROSE

WHEN HER BOYFRIEND KEN LITTLE DROVE UP IN HER CAR AROUND 9:00 P.M. ON SUNDAY JULY 14, 1974. KEN TOLD ME THAT "DENISE IS MISSING." HE SAID HE SEARCHED LAKE SAMMAMISH PARK FOR 4 HOURS BUT HE COULDN'T FIND HER. HE SAID THEY HAD BEEN FIGHTING ALL AFTERNOON WHILE AT THE PARK. HE SAID HE WAS ASLEEP AND DENISE WALKED OFF. HE REALLY DID LOOK CONCERNED. HE DIDN'T APPEAR TO BE MESSED UP AND I DIDN'T NOTICE ANY MARKS OR SCRATCHES ON HIM. SHE TOLD ME SHE LEFT HER CAR, BUT SHE LEFT HER SANDALS AND PURSE LOCKED IN THE TRUNK. SOMETIMES DENISE WOULD DRIVE AND SOMETIMES KEN WOULD DRIVE THE CAR WHEN THEY WOULD GO SOMEWHERE. HE SAID THAT MAYBE DENISE HAD JUST TAKEN OFF FOR A FEW HOURS BECAUSE HE WOULD DO THAT TO HER ON OCCASIONS. DENISE FIRST MET KEN LAST OCTOBER WHILE SHE WAS LIVING WITH ROBIN AND THEY MOVED IN TOGETHER AT 4522 S.W. GRAHAM IN MARCH, 1974. HE DROVE OFF WITH DENISE'S CAR AND PURSE AND HAS STOPPED BY ON TWO DIFFERENT MORNINGS. ONCE HE TOOK BROCK OVER TO LAKE SAMMAMISH AND THEY LOOKED FOR DENISE. SINCE DENISE HAS BEEN MISSING, I HAVEN'T HEARD ANYTHING FROM HER AND NO ONE HAS CONTACTED ME WITH RANSOM DEMANDS

KING COUNTY DEPARTMENT OF PUBLIC SAFETY

STATEMENT

PAGE 3 OF 3 PAGESCase No. 74-95852Date 07-17-1974Hour 1800 A.M. P.M.Statement of ELEANORE M. ROSE

ABOUT HER DISAPPEARANCE. DENISE HAS SPOKEN OF GOING WITH ROBIN TO THE FLAME TAVERN. KEN AND DENISE SAID THEY USUALLY WENT TO THE FIREDOG INN AND DIGBY'S TAVERN TO PLAY POOL AND DRINK BEER. DENISE CALLED ME AT NOON ON SUNDAY AND SAID THEY WERE GOING TO THE PARK WITH BOB SARGENT AND THAT WAS THE LAST TIME I HEARD FROM HER. DENISE SAID THAT KEN HAD NEVER STRUCK HER DURING THEIR ARGUMENTS BUT HE HAS PUSHED HER AROUND. THIS 3 PAGE STATEMENT IS TRUE TO THE BEST OF MY KNOWLEDGE. DENISE WAS GOING TO SCHOOL AT ITT PETERSON STUDYING COMPUTER SYSTEMS ON MONDAY, TUESDAY AND THURSDAY NIGHTS FROM 6:00 - 10:30 P.M. SHE WORKED ON A PART-TIME BASIS OF ABOUT 24 HOURS A WEEK THROUGH DEAN TOPS AGENCY IN DOWNTOWN SEATTLE. DENISE IS VERY LOVING AND WOULD OFTEN PICK ME UP GIFT FOR NO SPECIAL OCCASION AND I HAVE ALWAYS FELT VERY CLOSE TO HER. WHEN SHE WALKS INTO MY HOUSE, IT'S JUST LIKE SUNSHINE COMING THROUGH THE DOOR. STATEMENT ENDED AT 1840 7/17/74.

Eleanore Rose

Witness ☒

KING COUNTY DEPARTMENT OF PUBLIC SAFETY
 ADDITIONAL INFORMATION SHEET/OFFICER'S REPORT

Case No.

7 4

9 5 8 5 2

TO	VIA	DATE	TIME
FROM		SUBJECT: CONTINUATION OF <input type="checkbox"/> OFFICER'S REPORT REGARDING <input type="checkbox"/> Statement, Continued	

ITEM:

occasions and she has never walked out on me. I don't consider my comments about the dog as even an argument between us.

Both of us were in a tired grumpy mood. We had stayed late at card game and I told her we had to leave and she was a little uptight about that.

DENISE doesn't drink much. She might have had a half a beer at the park but that was all. She had not had any drugs. She was not the type that would contemplate suicide.

DENISE feels real responsible about her ITT Peterson School as a computer programmer. She would want to get back for her exam.

DENISE has two rings on each hand plus a watch. Two rings have blue stones. The one ring is a big blue stone in platinum. The other is a diamond shape onyx, very large, black. She has a band on her little finger. She wears the watch on the left hand. The watch is gold with a chain clasp. When she left, she took a pack of camel filter cigarettes.

She had very short blue jean cutoffs with black belt. Has ornamental piece of leather on each side of brass buckle. Buckle sticks through the leather to fasten. The cutoffs were frayed on the ends. She did not have all the belt loops. It had one belt loop in the back and one on each side. They were made from "leg" jeans. There is a leg tag on the back pocket. The cutoffs were faded and worn, no holes, pockets

dp went intact.

INVESTIGATING OFFICER	SERIAL	UNIT	APPROVED BY:
-----------------------	--------	------	--------------

PAGE 2
OF

KING COUNTY DEPARTMENT OF PUBLIC SAFETY
 ADDITIONAL INFORMATION SHEET/OFFICER'S REPORT

Case No.

7 4

9 5 8 5 2

TO	VIA	DATE	TIME
FROM		SUBJECT: CONTINUATION OF <input type="checkbox"/> OFFICER'S REPORT REGARDING <input type="checkbox"/> Statement, Continued	

ITEM:

She had a navy blue type halter top. It had a loop around the neck and tied in back. It was a fine, silky texture. It was a dull blue.

Normally she wears bikini underpants. She has pierced ears. She had good teeth, no fillings or color showing; no painted toe nails. Her finger nails were painted blue the day before. She had asked me what color I liked the best. I said blue.

She would go either to her mother's, grandmother's house, her father's, ROBIN's house or back to our house.

During the time we were at the park, DENISE was with me up until I fell asleep. Her swimming suit was left with us as well as her sandals and towel. She would not go anywhere without sandals on her feet.

She did not have any money with her.

During the time we were first at the park about 1300 hrs. DENISE had 4 valium, 5 milligrams each, little yellow tablets. She smoked part of a joint. She is a friendly girl and if someone would offer a joint she would take a toke. I'm sure she had complete control of her senses. She last had taken 4 valium on Friday night. I don't think she took anything to that.

She has been under a doctor's care for warts in the vaginal area.

Just before we dozed off, we had eaten some hot dogs and chips.

INVESTIGATING OFFICER	SERIAL	UNIT	APPROVED BY:
-----------------------	--------	------	--------------

PAGE 3
OF

ORIGINAL

KING COUNTY DEPARTMENT OF PUBLIC SAFETY
ADDITIONAL INFORMATION SHEET/OFFICER'S REPORT

Case No.

7 4

9 5 8 5 2

TO	VIA	DATE	TIME
FROM		SUBJECT: CONTINUATION OF <input type="checkbox"/> OFFICER'S REPORT REGARDING <input type="checkbox"/> Statement, Continued	

ITEM:

I have read the above statement and it is true and correct to the best of my knowledge.

We searched the park until 8:30 PM on Sunday. BOB and NANCY took DENISE's car to get their car at about 8 PM and then they returned to the park.

/s/ Kenneth L. Little Jr.
8:30 PM 7-16-74

INVESTIGATING OFFICER

SERIAL

UNIT

APPROVED BY:

PAGE 4
OF

Victim ☐Witness ☒

G COUNTY
DEPARTMENT OF PUBLIC SAFETY
STATEMENT

Case No. 74-95852District Number F-1Date 7-16 1974Hour 1845 A.M. P.M.Serial No. 04533Type of Case MISSING PERSONTaken by ROBERT D. KEAPPELStatement of KENNETH LEROY LITTLE JR.Age 23Alias _____ Zip _____ Phone 938-0150Address 4522 SW GRAHAMDate of Birth 7-6-51 at SEATTLEOccupation & Employer ADVANCE ELECTROPLATINGBus. Phone ²⁰² ~~602~~ 2661Status LIVES WITH DENISE NASLUND.

ON 7-14-74 IN THE AFTERNOON, I WERE WITH DENISE NASLUND, BOB SARGENT & NANCY. WE MET BOB & NANCY AT CARLIE'S CAFE AT 1230 HRS TO GO TO LAKE SAMMAMISH. WE LEFT BOB'S CAR THERE. WE MET BOB INSIDE. WE TOOK DENISE'S CAR. WE GOT AT THE PARK AT 1330 HRS. THERE WERE NO ARGUMENTS BETWEEN ANYONE AND EVERYTHING WAS COOL. WE MET A COUPLE OF BOB'S FRIENDS. WE SAT AT THE PARK IN FRONT OF THE REST ROOM. I HAD MY DOG WITH ME. I KEPT HAVING TO GET UP AND GET MY DOG. I TOLD DENISE SHE COULD GET UP ONCE IN A WHILE AND GO LOOK FOR HIM. SHE GAVE ME A DIRTY LOOK. BOB'S FRIENDS HAD LEFT SOMETIME AFTER THE KEG THROW. DENISE HAD DOZED OFF. THEN I LAID BACK AND WENT TO SLEEP. WE HAD STAYED UP LATE OVER THE WEEKEND AND WE WERE BOTH PRETTY BEAT. I DON'T KNOW WHAT TIME IT WAS, BUT WHEN I WOKE UP DENISE WAS GONE. NANCY TOLD ME DENISE HAD WALKED TOWARDS THE REST ROOM. NANCY HAD ASKED DENISE WHAT TIME IT WAS AND IT WAS AROUND 4 OR 4:30. DENISE HAD LEFT HER PURSE IN THE TRUNK OF HER CAR SO NO ONE

ORIGINAL

STATEMENT

PAGE 2 OF 2 PAGESCase No. 74-95852Date 7-16 1974Hour 1845 A.M. P.M.Statement of Kenneth L. Little Jr.

WOULD STEAL IT. SHE USUALLY GOES NO WHERE WITHOUT HER PURSE. SHE ALWAYS HAS TRACK OF IT.

DENISE HAS HITCH HIKE IN THE PAST. DENISE HAS BEEN LIVING WITH ME FOR ABOUT 9 MONTHS. WE HAVE LIVED AT THE GRAHAM ADDRESS FOR ABOUT 4 MONTHS.

IT TAKES QUITE A BIT TO GET DENISE MAD. SHE HAS ARGUED WITH ME ON PREVIOUS OCCASIONS AND SHE HAS NEVER WALKED OUT ON ME. I DON'T CONSIDER MY COMMENTS ABOUT THE DOG AS EVEN AN ARGUMENT BETWEEN US.

BOTH OF US WERE IN A TIRED GRUMPY MOOD. WE HAD STAYED LATE AT CARD GAME AND I TOLD HER WE HAD TO LEAVE AND SHE WAS A LITTLE UPTIGHT ABOUT THAT.

DENISE DOESN'T DRINK MUCH. SHE MIGHT HAVE HAD A HALF A BEER AT THE PARK BUT THAT WAS ALL. SHE HAD NOT HAD ANY DRUGS. SHE WAS NOT THE TYPE THAT WOULD CONTEMPLATE SUICIDE.

DENISE FEELS REAL RESPONSIBLE ABOUT HER ITT PETERSON SCHOOL AS A COMPUTER PROGRAMER. SHE WOULD WANT TO GET BACK FOR HER EXAM.

DENISE HAS TWO RINGS ON EACH HAND PLUS A WATCH. TWO RINGS HAVE BLUE STONES. THE ^{ONE KL} ~~ONE KL~~ RING IS A BIG BLUE STONE IN PLATINUM. THE OTHER IS A DIAMOND SAAPG ONYX, VERY LARGE, BLACK. SHE HAS A BAND ON HER LITTLE FINGER. SHE WEARS WATCH ON LEFT HAND. THE WATCH IS GOLD ~~BA~~ WITH CHAIN CLASP. WHEN SHE LEFT SAAG

KING COUNTY DEPARTMENT OF PUBLIC SAFETY

STATEMENT

PAGE 3 OF 4 PAGESCase No. 74-95852Date 7-16 19 74

Hour _____ A.M. _____ P.M.

Statement of KENNETH L. LITTLE JR.TOOK A PACK OF CAMEL FILTER CIGARETTES.

SHE HAD VERY SHORT BLUE JEAN CUTOFFS WITH
BLACK BELT. HAS ORNAMENTAL PIECE OF LEATHER ON EACH
SIDE OF BRASS BUCKLE. BUCKLE STICKS THROUGH THE LEATHER
TO FASTEN. THE CUTOFFS WERE FRAYED ON THE ENDS.
SHE DID NOT HAVE ALL THE BELT LOOPS. ^{KL} IT HAD ONE
BELT LOOP IN THE BACK AND ONE ON EACH SIDE.
THEY WERE MADE FROM "LEE" JEANS. THERE IS A LEE
TAG ON THE BACK POCKET. THE CUTOFFS WERE FADED AND
WORN; NO HOLES; POCKETS WENT IN TACT.

SHE HAD A NAVY BLUE TYPE HALTER TOP. IT
HAD LOOP AROUND NECK AND TIED IN BACK. IT WAS
FINE, SILKY TEXTURE. IT WAS A DULL BLUE.

NORMALLY SHE WEARS BIKINI ^{KL} UNDER ~~WEAR~~ PANTS.

SHE HAS PIERCED EARS. SHE HAD GOOD TEETH, NO FILLINGS
OR COLOR SHOWING; NO PAINTED TOE NAILS. HER FINGER
NAILS WERE PAINTED BLUE THE DAY BEFORE. SHE HAD ASKED
ME WHAT COLOR I LIKED THE BEST. I SAID BLUE.

SHE WOULD GO EITHER TO HER MOTHER'S HOUSE, GRANDMOTHER'S
HOUSE, HER FATHER'S, ROBIN'S HOUSE OR BACK TO OUR HOUSE.

DURING THE TIME WE WERE AT THE PARK DENISE
WAS WITH ME UP UNTIL I FELL ASLEEP. HER SWIMMING
SUIT WAS LEFT WITH US AS WELL AS HER SANDALS AND TOWEL.
SHE WOULD NOT GO ANYWHERE WITHOUT SANDALS ON HER FEET.

SHE DID NOT HAVE ANY MONEY WITH HER.

ORIGINAL

KING COUNTY DEPARTMENT OF PUBLIC SAFETY

STATEMENT

PAGE 4 OF PAGESCase No. 74-95852Date 7-16 19 74Hour A.M. 1845 P.M.Statement of KENNETH LEROY LITTLE JR.

DURING THE TIME WE WERE FIRST AT THE PARK ABOUT 1300
MRS. DENISE HAD ^{KL} 4 VALIUM, 5 MILIGRAMS EACH, LITTLE YELLOW
TABLETS. SHE ^{KL} SMOKE PART OF A JOINT. SHE IS A FRIENDLY
GIRL AND IF SOMEONE WOULD SMOKE A JOINT SHE WOULD
TAKE A TOKE. I'M SURE SHE HAD COMPLETE CONTROL
OF HER SENSES. SHE LAST HAD TAKEN 4 VALIUM
ON FRIDAY NIGHT. I DON'T THINK SHE TOOK ANYTHING ^{KL} PRIOR
TO THAT.

SHE HAS BEEN UNDER A DOCTOR'S CARE FOR WHORTS
IN THE VAGINAL AREA.

JUST BEFORE WE DOZED OFF WE HAD EATEN SOME
HOT DOGS & CHIPS.

I HAVE READ THE ABOVE STATEMENT AND IT IS TRUE AND
CORRECT TO THE BEST OF MY KNOWLEDGE.

WE SEARCHED THE PARK UNTIL 8:30AM ON SUNDAY. BOB &
NANCY TOOK DENISE'S CAR TO GET THEIR CAR AT ABOUT 8 PM AND
THEN THEY RETURNED TO THE PARK.

Kenneth L. Little Jr.
8:30 PM 7-16-74

KING COUNTY
DEPARTMENT OF PUBLIC SAFETY

Victim ☐

Witness ☒

STATEMENT

Case No. _____ Date 7/18 1974
Hour _____ A.M. 1550 P.M.
Taken by ROBERT D. KEPPEL Serial # 04533
Statement of NANCY R. BATTEMA Age 25
Alias _____
Address 18601 94th NE, Bothell Zip 98011 Phone 485-1567
Date of Birth 9/24/48 at Compton, California
Occupation & Employer Bookkeeper, Bowen, Weeks & Co. Bus. Phone LA 3-5310
Status: Separated.

I have known DENISE NASLUND for about 5 months. Periodically, we used to go out and when we would play pool in a tavern, she would ask to go to a separate table so someone would ask her to dance.

On July 14, 1974, BOB SARGENT and I met KEN LITTLE and DENISE NASLUND at Charlie's East Tavern in Eastgate at about 12:45 P.M. We all went to Lake Sammamish State Park in DENISE's car. We got to the park at 1 P.M. While we were coming to the park, DENISE complained about the car needing fixing and KEN said he would do it.

We parked on a grassy field before the main parking lot. We walked along the grass and sat about 200 feet in front of the restroom near the end of the parking area. I saw several motorcycle people in the area. Later in the afternoon, there quite a few in the parking area near the restroom we were sitting in front of.

DENISE had taken 3 or 4 downers at the park. DENISE fell asleep about 4 o'clock. Prior to falling asleep, DENISE mentioned she was feeling high. At about 4 P.M., BOB returned with hot dogs. KEN tried to wake DENISE up, but she did not want to wake up at first. We ate the hot dogs. KEN dosed off.

KING COUNTY DEPARTMENT OF PUBLIC SAFETY
ADDITIONAL INFORMATION SHEET/OFFICER'S REPORT

Case No.

7 4

9 5 8 5 2

TO	VIA	DATE	TIME
FROM		SUBJECT: CONTINUATION OF <input type="checkbox"/> OFFICER'S REPORT REGARDING <input type="checkbox"/> STATEMENT, CONTINUED:	

ITEM:

I asked DENISE, what time it was. DENISE said 20 after 4, or 4:30. We sat for a few minutes. DENISE got up without saying anything and walked straight towards the restroom.

DENISE watched out for her dog quite a bit and locked her purse in the car. If she did not have all her stuff, it would not surprise me if she picked up with some other guy. But, in this case, she probably would have only been gone for 20 - 30 minutes. She is not the type who talks alot. She doesn't seem to be overly impressed by any guy. She wouldn't go out of her way to talk to anybody, nor would she go out of her way to avoid anyone.

DENISE always had drugs when we would go out. I don't know that she always used them. She always had the same downers.

I have read the above statement and it is true and correct to the best of my knowledge.

/s/ Nancy R. Battema

7/18/74

4:30 P.M.

INVESTIGATING OFFICER	SERIAL	UNIT	APPROVED BY:
			PAGE 2 OF

~~ORIGINAL~~

DEPARTMENT OF PUBLIC SAFETY

STATEMENT

Victim ☐Witness ☒

Case No. _____

District Number F-1Date 7-18 19 74Hour _____ A.M. 1550 P.M.Serial No. 04533Age 25Type of Case MISSING PERSONTaken by ROBERT D. KEAPPLStatement of NANCY R. BATTEMAAlias _____ Zip 98011 Phone 485-1567Address 18601 - 94 NE BOTHELDate of Birth 9-24-48 at COMPTON, CALIF.Occupation & Employer BOOKKEEPER, BOWEN, WEEKS & CO. Bus. Phone LA 3 5310Status SEPARATED

I HAVE KNOWN DENISE NASLUND FOR ABOUT 5 MONTHS. PERIODICALLY WE USED TO GO OUT AND WHEN WE WOULD PLAY POOL IN A TAVERN SHE WOULD ASK TO GO TO A SEPARATE TABLE SO SOMEONE WOULD ASK HER TO DANCE.

ON JULY 14, 1974 ~~WE~~ ~~WENT~~ ~~TO~~ BOB SARGENT AND I MET KEN LITTLE AND DENISE NASLUND AT CHARLIE'S ~~OUT~~ EAST ~~TAVERN~~ TAVERN IN EAST GATE AT ABOUT 12:45 PM. WE ALL WENT TO LAKE SAMMAMISH STATE PARK ~~IN~~ IN DENISE'S CAR. WE GOT TO THE PARK AT 1 PM. WHILE WE WERE COMING TO THE PARK DENISE COMPLAINED ABOUT THE CAR NEEDING FIXING AND KEN SAID HE WOULD DO IT.

WE PARKED ON A GRASSY FIELD BEFORE THE MAIN PARKING LOT. WE WALKED ALONG THE GRASS AND SAT ABOUT 200 FEET IN FRONT OF THE REST ROOM NEAR THE END OF THE PARKING AREA. I SAW SEVERAL MOTORCYCLE PEOPLE IN THE AREA. LATER IN THE AFTERNOON THERE WERE QUITE A FEW IN THE PARKING AREA NEAR THE RESTROOM WE WERE SITTING IN FRONT OF.

DENISE HAD TAKEN 3 OR 4 DOWNERS AT THE PARK.

STATEMENT

PAGE 2 OF PAGESCase No. Date 7-18 19 74Hour A.M. 1550 P.M.Statement of NANCY BATTEMA

DENISE FELL ASLEEP ABOUT 4 O'CLOCK. PRIOR TO FALLING ASLEEP DENISE MENTIONED SHE WAS FEELING HIGH. AT ABOUT 4 PM BOB RETURNED WITH HOT DOGS. KEN TRIED TO WAKE DENISE UP BUT SHE DID NOT WANT TO WAKE UP AT FIRST. WE ATE THE HOT DOGS. KEN DOZED OFF. I ASKED DENISE, WHAT TIME IT WAS. DENISE SAID 20 AFTER 4 OR 4:30. WE SAT FOR A FEW MINUTES. DENISE GOT UP WITHOUT SAYING ANYTHING AND WALKED STRAIGHT TOWARDS THE RESTROOM.

DENISE WATCHED OUT FOR HER DOG ^{QUITTING} ~~OUT~~ A BIT AND LOCKED HER PURSE IN THE CAR. IF SHE DID NOT ^{HAVE} ~~HAVE~~ ALL HER STUFF IT WOULD NOT SURPRISE ME IF SHE PICKED UP WITH SOME OTHER GUY. BUT, IN THIS CASE, SHE PROBABLY WOULD HAVE ONLY BEEN GONE FOR 20-30 MINUTES. SHE IS NOT THE TYPE WHO TALKS ALOT. SHE DOES N'T SEEM TO BE OVERLY IMPRESSED BY ANY GUY. SHE WOULDN'T GO OUT OF HER WAY TO TALK TO ANYBODY, NOR WOULD SHE GO OUT OF HER WAY TO AVOID ANYONE.

DENISE ALWAYS HAD DRUGS WHEN WE WOULD GO OUT, I DON'T KNOW THAT SHE ALWAYS USED THEM. SHE ALWAYS HAD THE SAME DOWNERS.

I HAVE READ THE ABOVE STATEMENT AND IT IS TRUE AND CORRECT TO THE BEST OF MY KNOWLEDGE.

x Nancy Battema
7-18-74
4:30 P.M.

Victim ☐

Witness ☐

KING COUNTY
DEPARTMENT OF PUBLIC SAFETY
STATEMENT

File No. 74-95852

District Number 74-96644

Date July 17 19 74

Hour 3:40 A.M. 3:40 P.M.

Serial No. 07851

Age 29

Type of Case Mulder Power

Taken by Rolf E. Gruner *X pac*

Statement of Patricia A. Earp

Alias Pat Earp

Zip 98002

Phone 839-7267

Address 1448 South 303rd, Federal Way, WA 98002

Date of Birth 5-18-45 at Seattle, WA

Occupation & Employer Secretary

Bus. Phone 833-6500 X421

Status On July 14, 1974, I went to Lake Samamish State Park with my husband and children to attend a picnic. This was about 3:00 P.M. and the picnic lasted until about 7:00 p.m.

At approximately 5:00 pm. I went to the rest room located at the end of the parking area

(which was near our picnic spot). There was quite long line, and I had to wait about 15

minutes. While in line I noticed a young girl towards the front of the line, and later

I noticed her come out of the rest room. (I was still in line.) She was about 5' 2" tall

with very dark, long hair (about to the middle of her back), and was wearing a dark (I think

purple) halter top and I believe cut off jeans. She was very pretty, and I think this is why

I noticed her. I did not notice whether or not she was wearing shoes, but I am sure she was

not carrying a hand bag. While waiting in line and before the girl came out of the rest room,

I noticed a man on a motorcycle hanging around the building. He did not, in my opinion, appear

to be waiting for anyone in particular. When the girl came out of the rest room, I turned

away for a minute. When I turned back around, I noticed her twisting her hair around in a

bun arrangement and tucking it under a black, dull, old looking motorcycle helmet. I looked

for another minute as she was having a little trouble tucking the hair up, and then went

into the rest room. The man on the motorcycle was young looking - maybe middle twenties.

He had a helmet on, I think wire rimmed glasses (glasses for sure), and a ~~sw~~ stubbly beard.

He was wearing a levi jacket (it may have had the sleeves cut off, but I am not sure), and

levies. I do not remember what kind of shoes he had on. The motorcycle was black and big,

and may have had the front ~~w~~ wheel extended out, but I am not sure. There were several

~~other~~ other motorcycles around the area. I did not notice the girl being with anyone else.

STATEMENT

PAGE 2 OF 2 PAGES

Case No.

74-95852

~~74-96644~~

Date _____ 19____

Hour _____ A.M. _____ P.M.

Statement of Patricia A. Earp

I then turned back around and went into the rest room. I did see the girl getting on to the motorcycle, but did not see them leave. The man on the motorcycle was sitting down, so I don't know how tall he was, but he was very husky, maybe over 200 pounds. His beard was light colored - blondish I think.

The photo of a dark haired girl I was shown today, could be the girl I saw, but I cannot say for sure. When she was preparing to get on the motorcycle, her back was to me, so the only time I saw her face was she came out of the rest room.

THIS STATEMENT IS TRUE AND CORRECT TO THE BEST OF MY KNOWLEDGE.

Patricia A. Earp7/17/74 4:09 pm

KING COUNTY
DEPARTMENT OF PUBLIC SAFETY
STATEMENT

Victim ☐

Witness ☒

Case No. 74-95852

Date 7/17 19 74

Hour 1215 A.M. P.M.

Taken by ROBERT D. KEPPEL Serial # 04533

Statement of BETTY J. BARRY Age 50

Alias _____

Address 7928 13th Ave. S.W. Zip 98106 Phone RO 2-6921

Date of Birth 7/22/21 at _____

Occupation & Employer Seattle Police - Payroll Bus. Phone 583-2209

On 7/14/74 at 11:45 A.M., I was at Lake Sammamish State Park. I was with the Rainier Family Picnic. Around 3:30 or 4 P.M., I went to the ladies restroom. I saw a girl in the restroom, which I have positively identified as DENISE NASLUND. She was leaving as I went out. There was another girl that walked out the same time, who was wearing a maroon knit bikini top. DENISE had talked to the other girl. The other girl was about the same size as DENISE. DENISE had on faded cut-off jeans, and a light colored halter top. Her shoes were a brown Mexican-type sandal. They both appeared to be good looking.

I have read the above statement and it is true and correct to the best of my knowledge.

/s/ Betty J. Barry

7/17/74 12:30 P.M.

Victim ☐Witness ☒KING COUNTY
DEPARTMENT OF PUBLIC SAFETY

STATEMENT

Case No. 74-95852District Number F-1Date 7-17 19 74Hour A.M. 12:15 P.M.Serial No. 04533Age 50Phone 202 6921Type of Case MISSING PERSONTaken by ROBERT D. KEPPELStatement of BETTY J. BARRY

Alias _____

Zip 98106Address 7928 - 13TH AVE SWDate of Birth 7-22-21 at _____Occupation & Employer SEATTLE POLICE - PAYROLLBus. Phone 583-2209

Status _____

ON 7-14-74 AT 1145 AM I WAS AT LAKE
SAMMAMISH STATE PARK. I WAS WITH THE RAINIER
FAMILY PICNIC. AROUND 3:30 OR 4 PM I WENT TO
THE LADY'S RESTROOM. I SAW A GIRL IN THE RESTROOM,
WHICH I HAVE POSITIVELY IDENTIFIED AS DENISE NASLUND.
SHE WAS LEAVING AS I WENT OUT. THERE WAS ANOTHER
GIRL THAT WALKED OUT THE SAME TIME WHO WAS WEARING
A MAROON KNIT BIKINI TOP. DENISE HAD TALKED TO THE
OTHER GIRL. THE OTHER GIRL WAS ABOUT THE SAME SIZE AS DENISE.
DENISE HAD ON FADED CUTOFF JEANS AND A LT. COLORED HALTER
TOP. HER SHOES WERE A BROWN TYPE MEXICAN TYPE SANDAL.
THEY BOTH APPEARED TO BE GOOD LOOKING.

I HAVE READ THE ABOVE STATEMENT AND IT IS TRUE AND
CORRECT TO THE BEST OF MY KNOWLEDGE.

X Betty J. Barry
7-17-74 12:30 P.M.

ORIGINAL

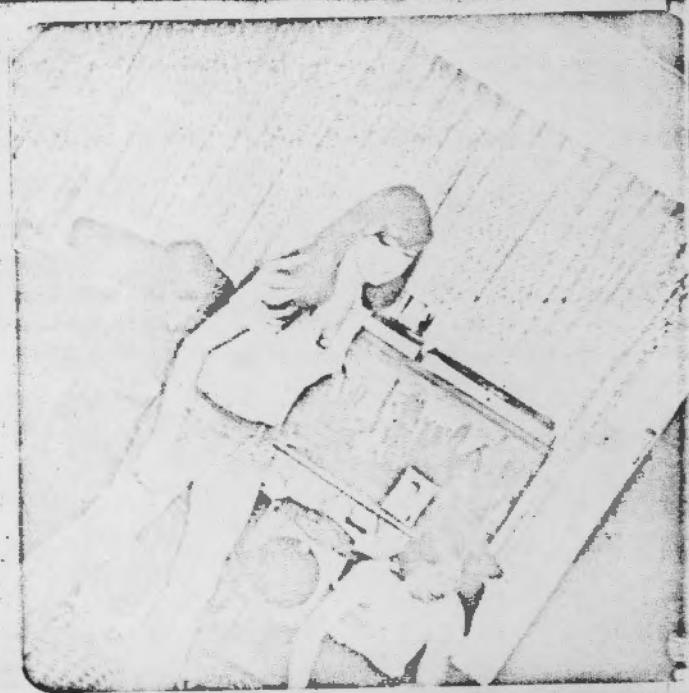
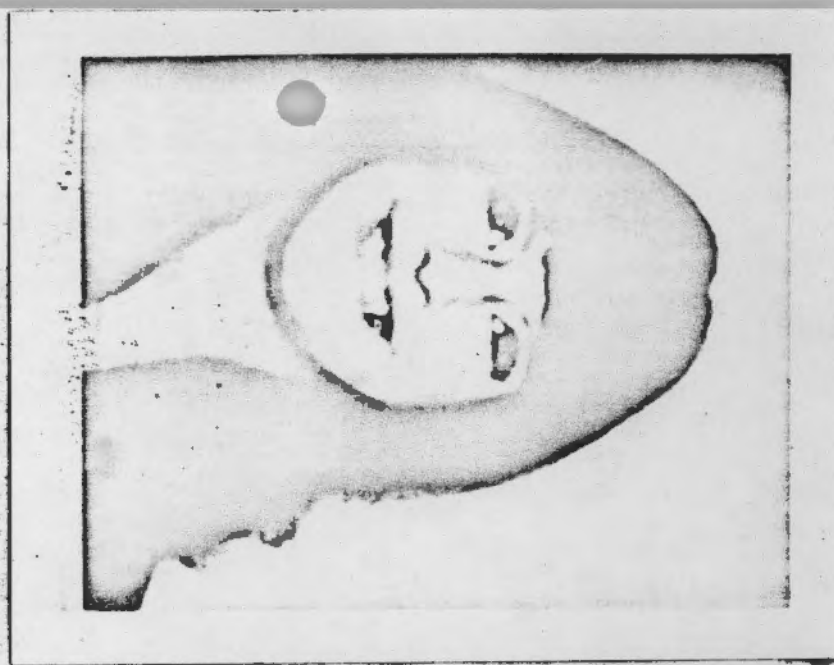

T.YE.YF
APB WASHINGTON

Sgt RANDALL
C.I.D.

MISSING PERSON POSSIBLE FOUL PLAY

NASLUND, DENISE MARIE WF 161055 504 110 HAI/DK BRO EYE/BRO
COMPLEX/OLIVE LAST SEEN WEARING CUT OFF SHORTS DK BRO HALTER TOP
BRO SANDALS.

HAS BEEN KNOWN TO ASSOCIATE WITH MOTORCYCLE GANGS.
DISAPPEARED FROM LAKE SAMANISH STATE PARK 7/14/74. VEH WITH PERSONAL
ID LEFT BEHIND.

ANY INFO APPRECIATED REFER OUR CASE 74-95852

SO KING COUNTY SEATTLE OP 46

74-95852
ORIGINAL

IF
WASHINGTON

CANCELATION MISSING PERSON..... MSG 814 INCORRECTLY WORDED.....
DELETE LINEHAS BEEN KNOWN TO ASSOCIATE WITH MOTORCYCLE GANGS...

CORRECTED MESSAGE NOW READS AS FOLLOWS.....

T.YE.YF
APB WASHINGTON

MISSING PERSON : POSSIBLE FOUL PLAY

NASLUND, DENISE MARIE WF 101055 504 113 HAI/DK BRO EYE/BRO
COMPLEX/OLIVE LAST SEEN WEARING CUT OFF SHORTS DK BRO HALTER TOP
BRO SANDALS.

DISAPPEARED FROM LAKE SAMANISH STATE PARK 07-14-74. VEN WITH
PERSONAL ID LEFT BEHIND.

ANY INFO APPRECIATED. REFER OUR CASE 74-95852
JUL 15 11:12

SO KING COUNTY SEATTLE OP 460

SECTION
RECORD

74-95852
ORIGINAL

SPECIAL



BULLETIN

DATE August 28, 1974

CASE NO. 74-95852

**DEPARTMENT OF PUBLIC SAFETY
KING COUNTY POLICE
KING COUNTY COURTHOUSE
SEATTLE, WA 98104**

MISSING PERSON

DENISE MARIE NASLUND (18)

D.O.B. 10/10/55, 5'4", 120 lbs.
Shoulder-length straight long brown
hair, olive complexion, brown eyes.

Last seen wearing cut-off shorts, dark
blue halter top, brown Mexican-type
sandals.

DENISE MARIE NASLUND disappeared from
the Lake Sammamish State Park on
July 14, 1974 (Sunday). She was last
seen at the park at 1600 Hrs. (4:00 P.M.)

DENISE had been with a boyfriend and
another couple earlier in the day. She
left her friends at approximately
1600 Hrs., walking toward the women's
lavatory. The last report of anyone
seeing DENISE was around 1600 Hrs.,
when she was talking to another young
woman in the lavatory, who was wearing
a maroon knit bikini top, no other
description available.

Any information regarding DENISE should
be directed to the King County Police
Department, Homicide and Robbery Unit,
Phone (206) 344-3883, or your local
police department.



Lois - 622-6444

JONES

Jim OTT 454 7257

WK. 543-3665

Mr. Robert Nalland

WK BAP 3600

Duparen

824-2038-Ann

Wife Home Phone - HP

New Address

Lot O

21814 - Pac Hwy ORIGINAL

Devise Nalland 7/9/74

Medical Service

1155-10 HEN-

Dr. Bacc

Dr. Rickey Swenson

2654

Mr. Bacc

Legend Motel #
878-7060 Rm 8

ORIGINAL
74-15832

7/18/74 350

Mr. Nalland, Robert (Mr.)

21618 - 3157 Ave So

Work - BAP 3600

ORIGINAL

Mrs. Eleanor Rose
8652-13 St. S.H.
Seattle, Wash. 98106

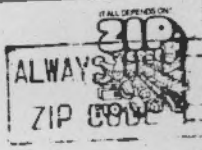

Lieutenant Treasche,
Det. Randall & Detention
of Suicide
King County Court House
3rd & James
Seattle, Wash.

ORIGINAL
74-95852



Thank
you

To all concerned about the
Case of my dear daughter,
Adelaide Graham:
With sincere thanks

For your kindness.

It was appreciated

more than words can say.

Thank You

I know that you
have all seen your last and
will be. I'll show you
all and your family.

PC-A-2-8765